

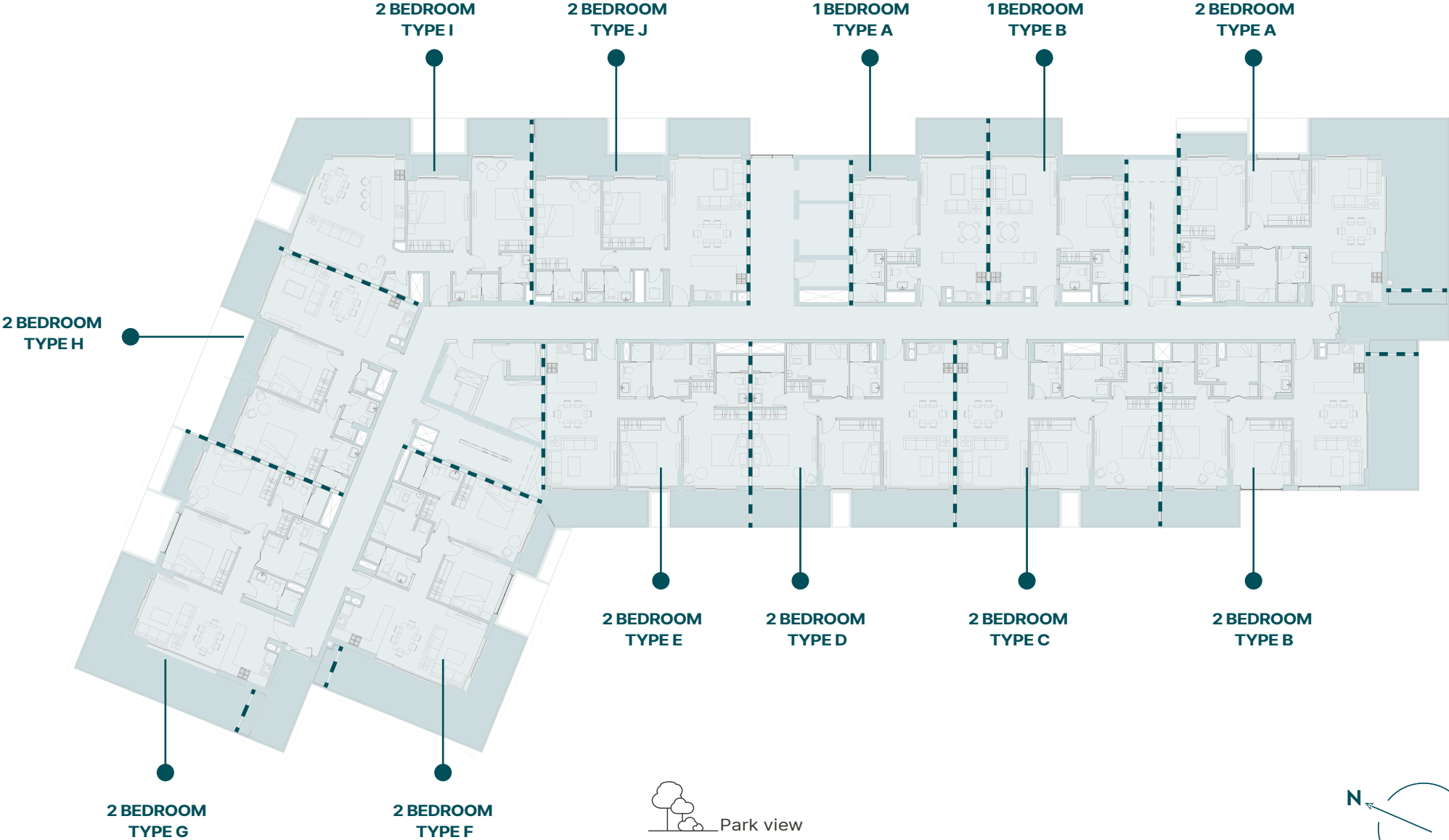

FLOOR PLANS

FLOOR PLANS

1st & 2nd Floor



3th Floor

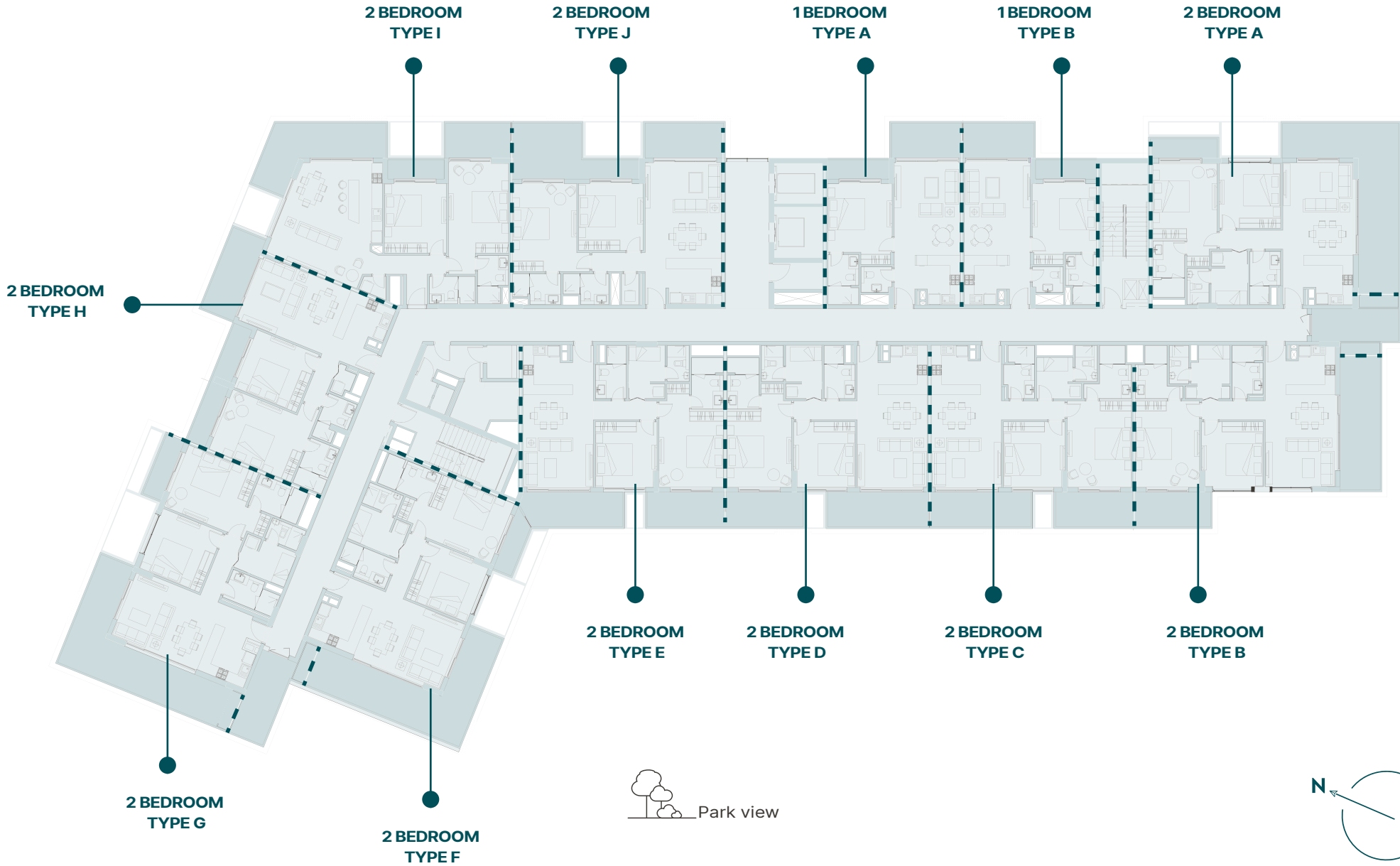

4th Floor

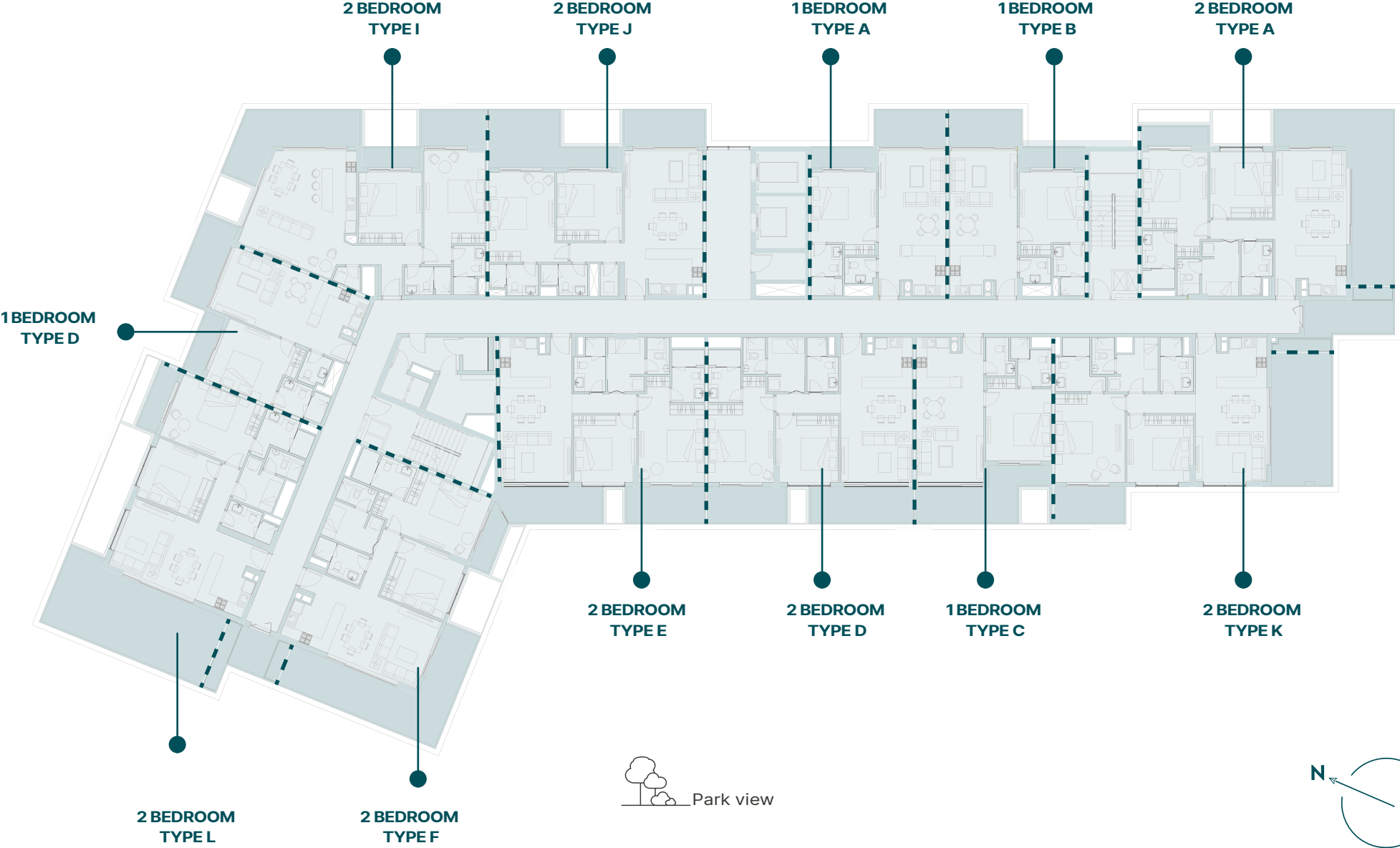

5th Floor

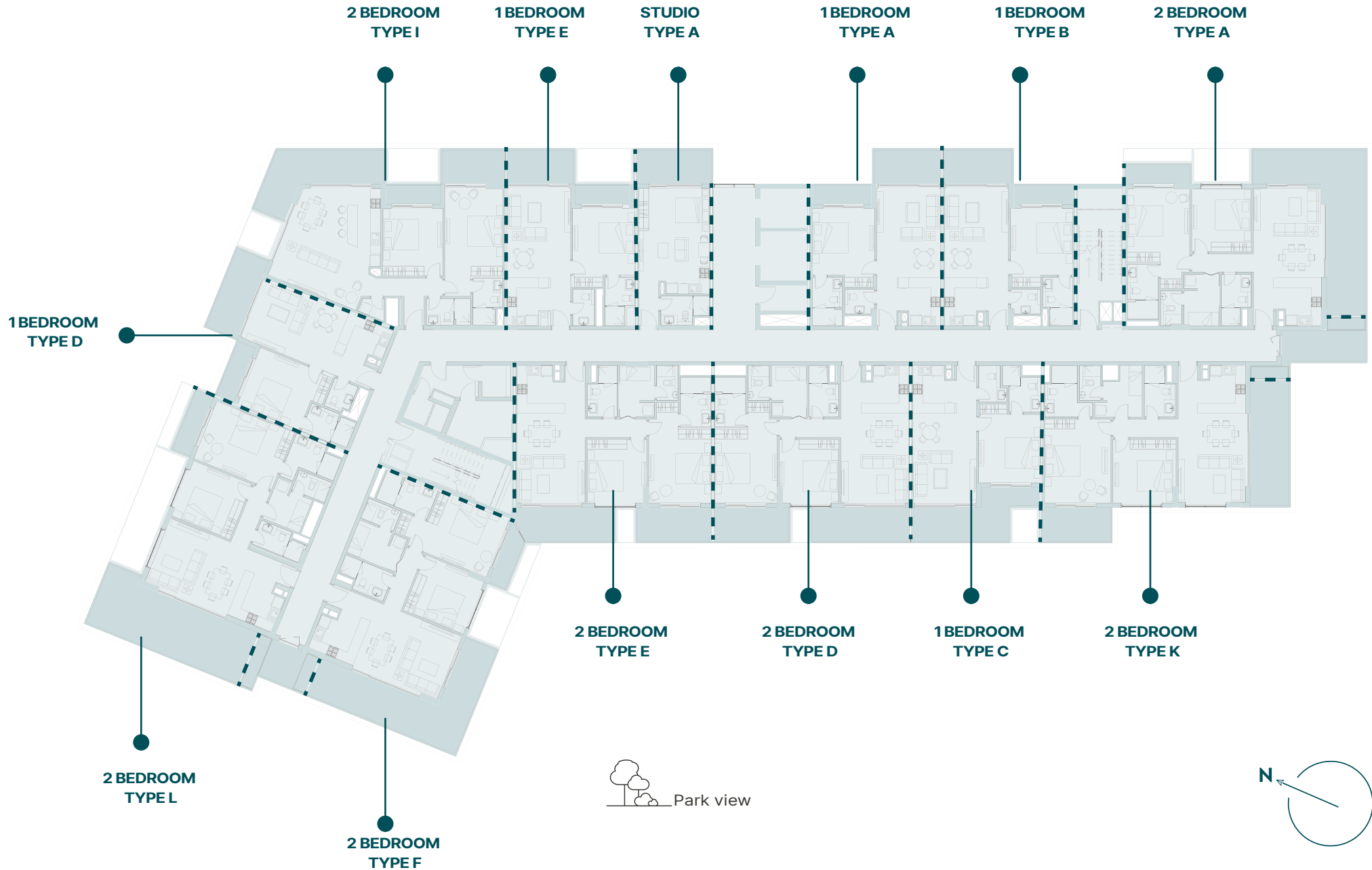

6th Floor

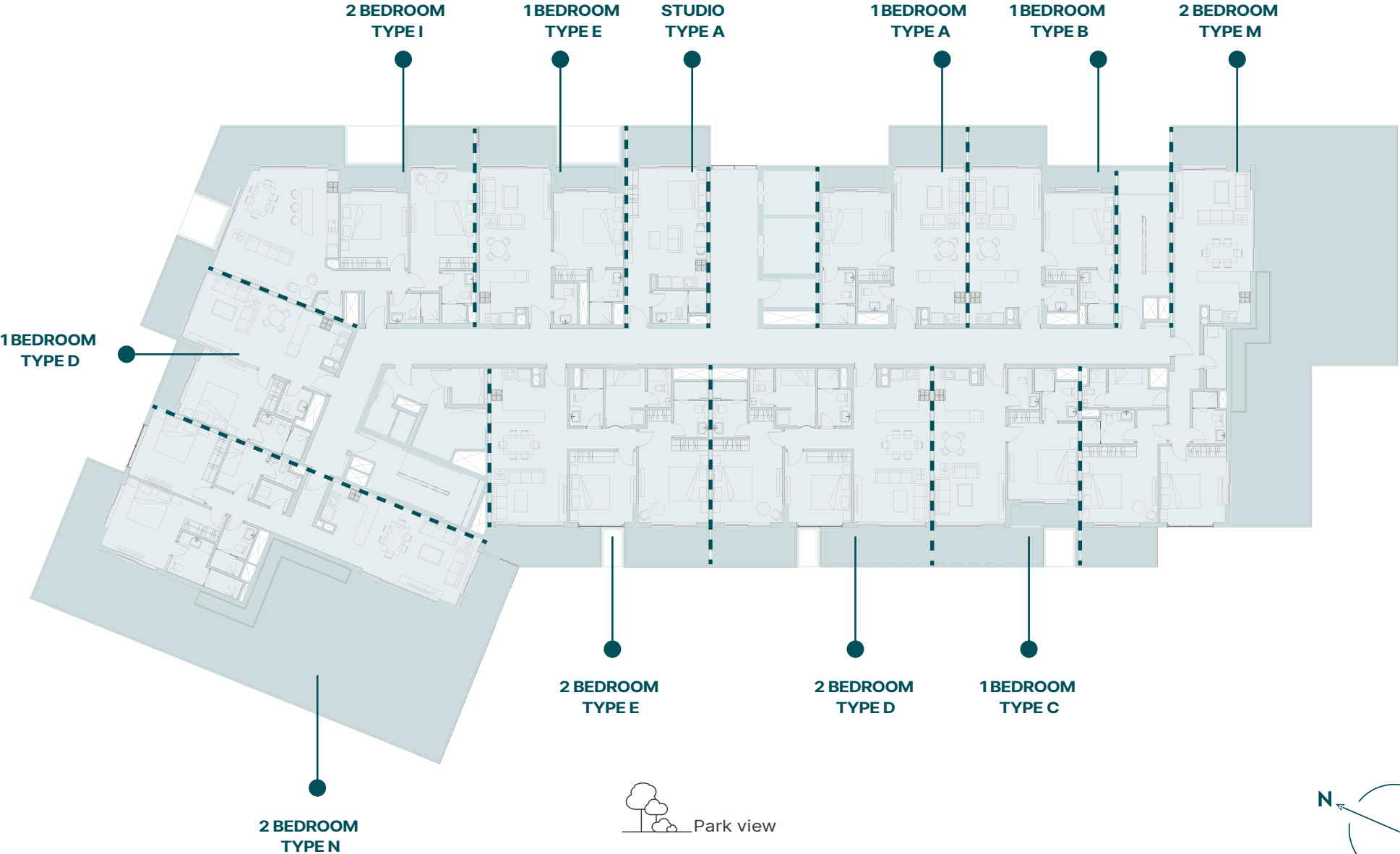

7th Floor

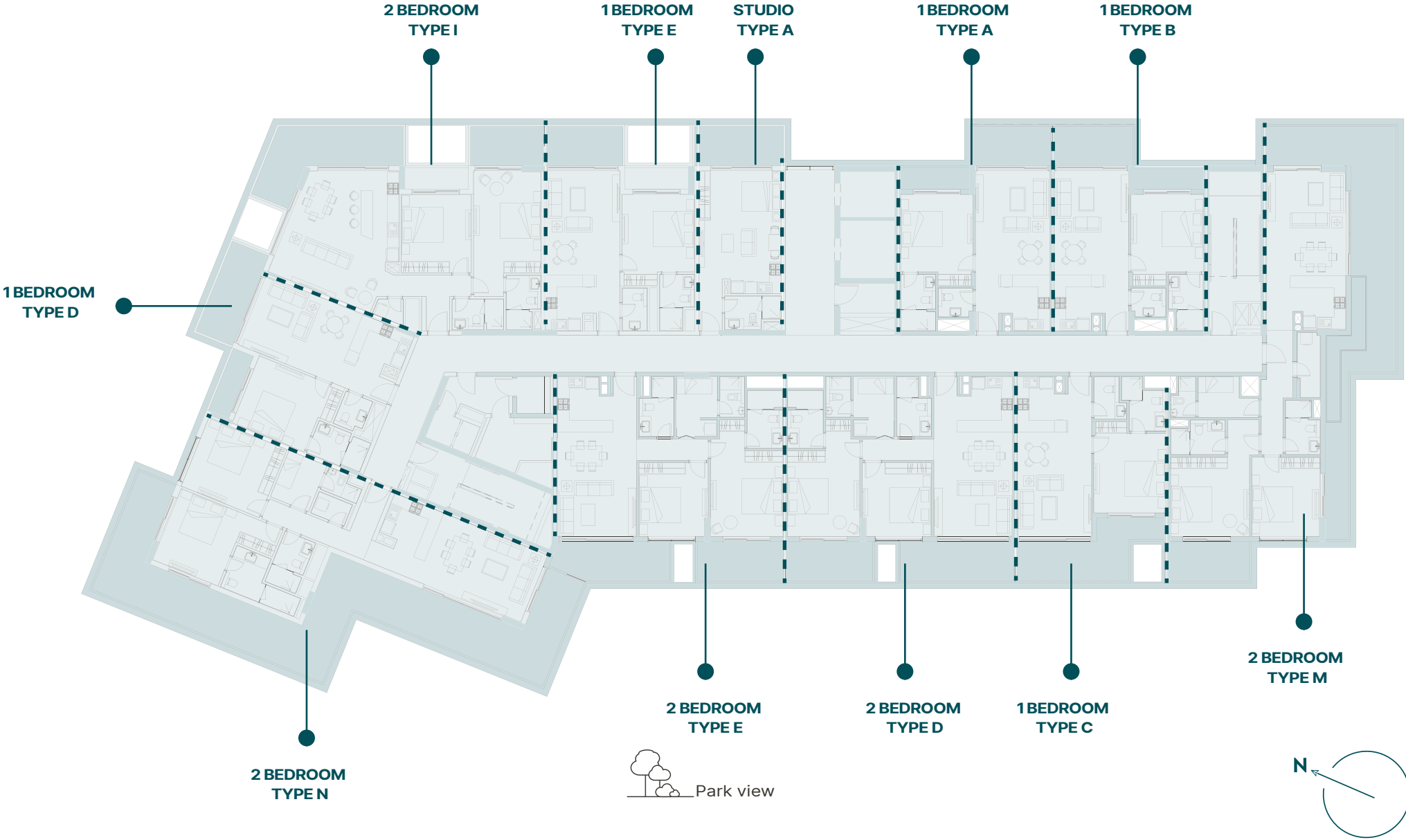

STUDIO LAYOUT

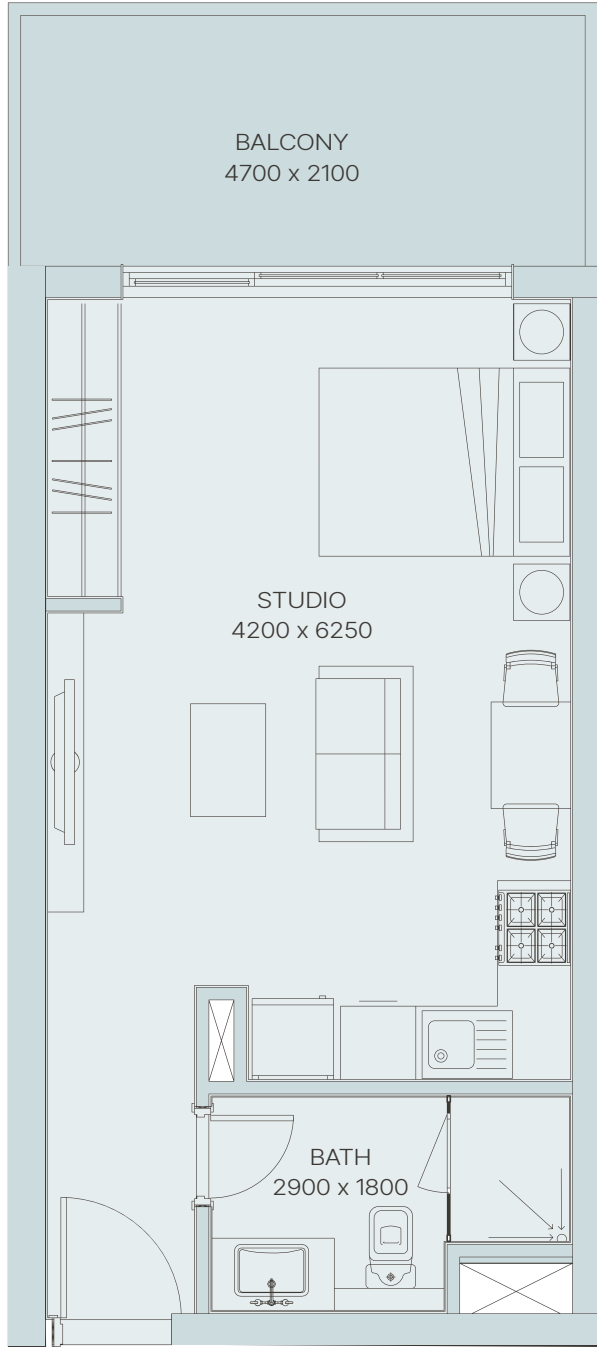

STUDIO TYPE A

Internal Living Area	389.33 sq.ft
Outdoor Living Area	107.64 sq.ft
Total Living Area	496.97 sq.ft

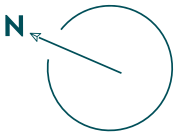

1 BEDROOM LAYOUTS

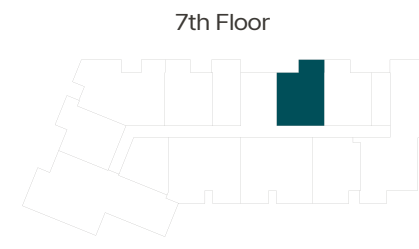
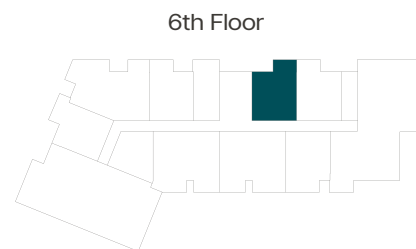
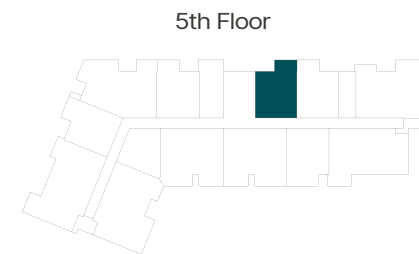
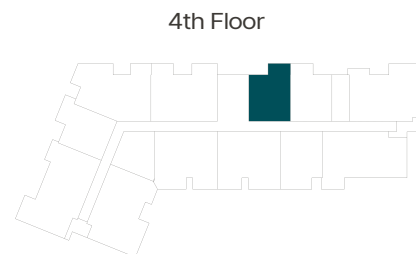
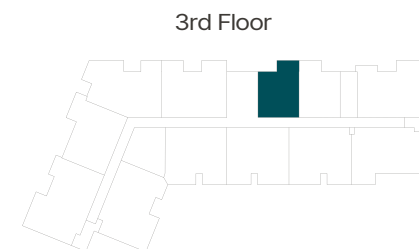
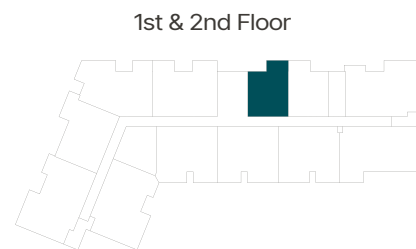
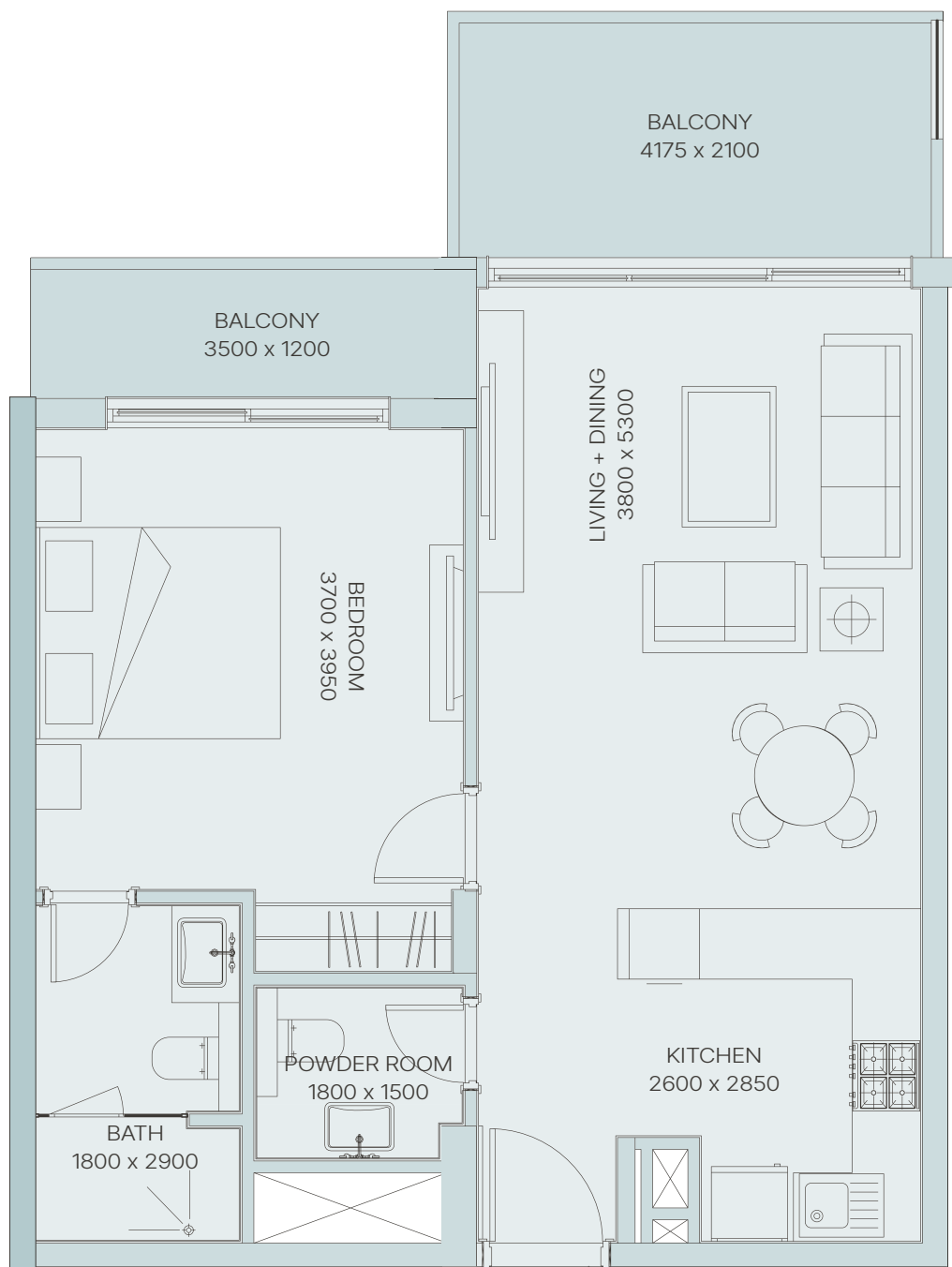

1 BEDROOM TYPE A

Internal Living Area	638.19 sq.ft
Outdoor Living Area	149.94 sq.ft
Total Living Area	788.13 sq.ft



All floor plans, layouts, and measurements are provided for illustrative purposes only and are subject to change without prior notice

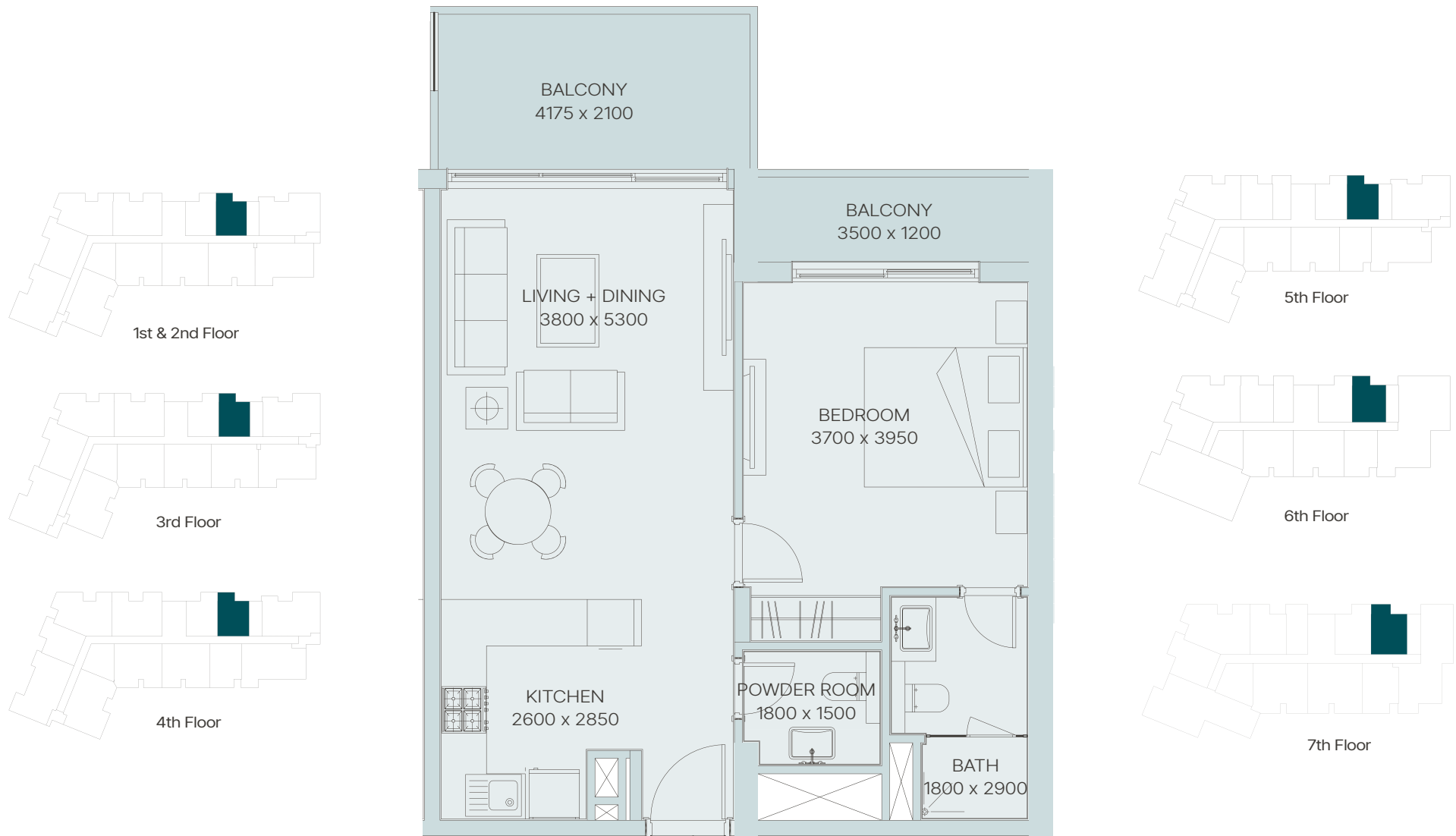

1 BEDROOM TYPE B

Internal Living Area	635.82 sq.ft
Outdoor Living Area	147.68 sq.ft
Total Living Area	783.50 sq.ft

All floor plans, layouts, and measurements are provided for illustrative purposes only and are subject to change without prior notice

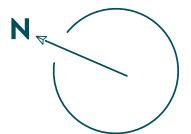

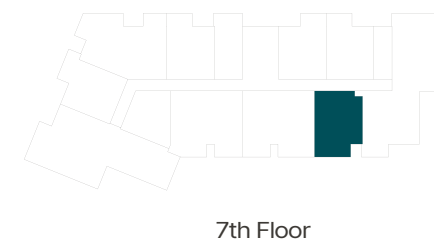
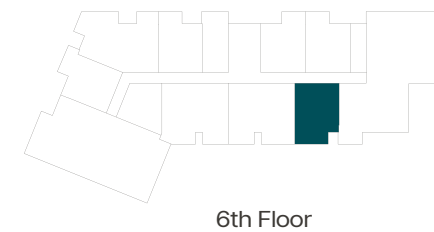
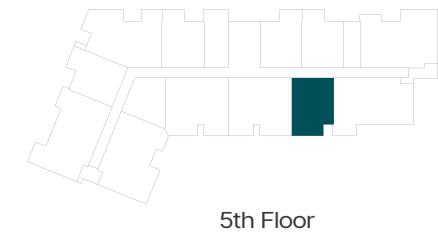
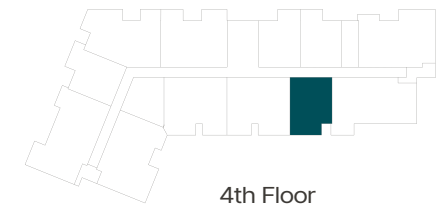
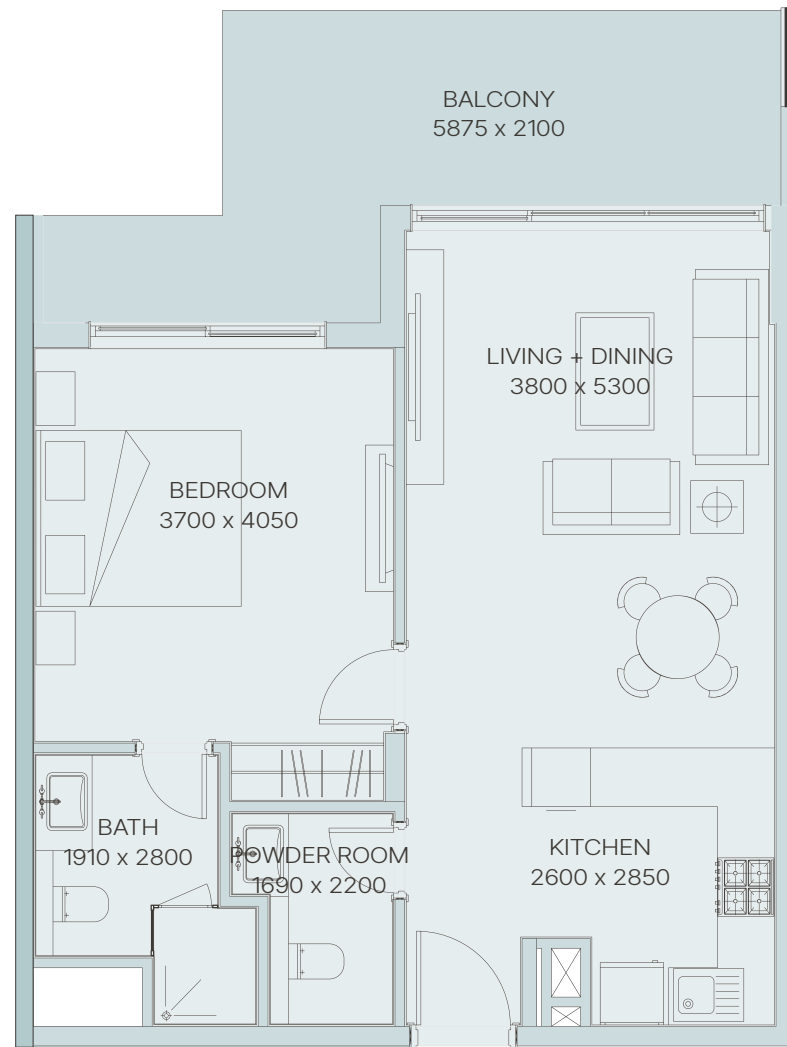

1 BEDROOM TYPE C

Internal Living Area	639.91 sq.ft
Outdoor Living Area	187.61 sq.ft
Total Living Area	827.53 sq.ft

All floor plans, layouts, and measurements are provided for illustrative purposes only and are subject to change without prior notice



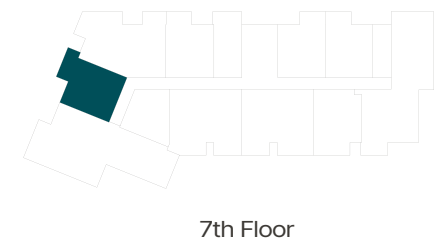
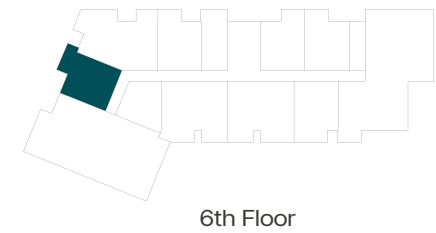
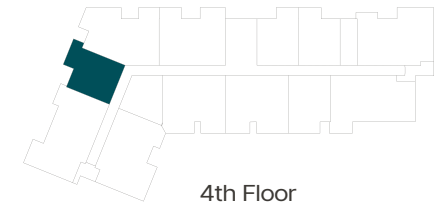
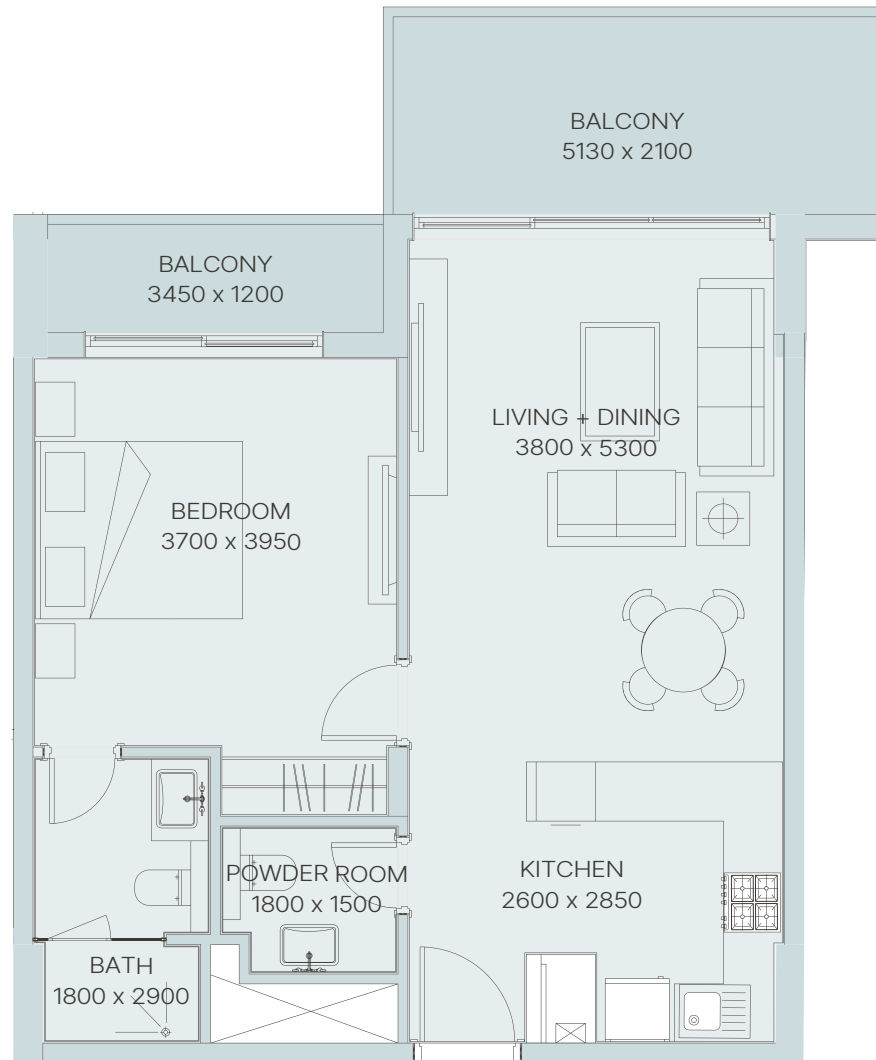

1 BEDROOM TYPE D

Internal Living Area	634.75 sq.ft
Outdoor Living Area	169.53 sq.ft
Total Living Area	804.28 sq.ft

All floor plans, layouts, and measurements are provided for illustrative purposes only and are subject to change without prior notice

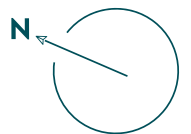

2 BEDROOM LAYOUTS

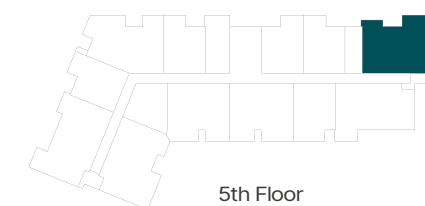
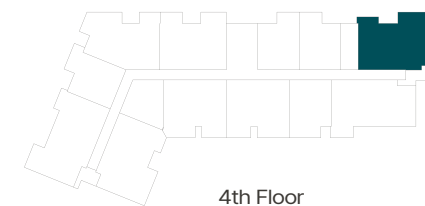
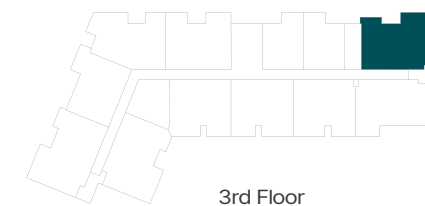
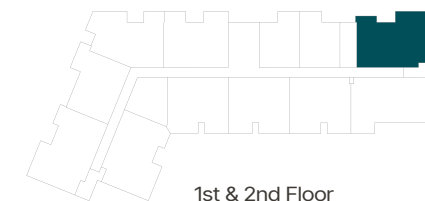
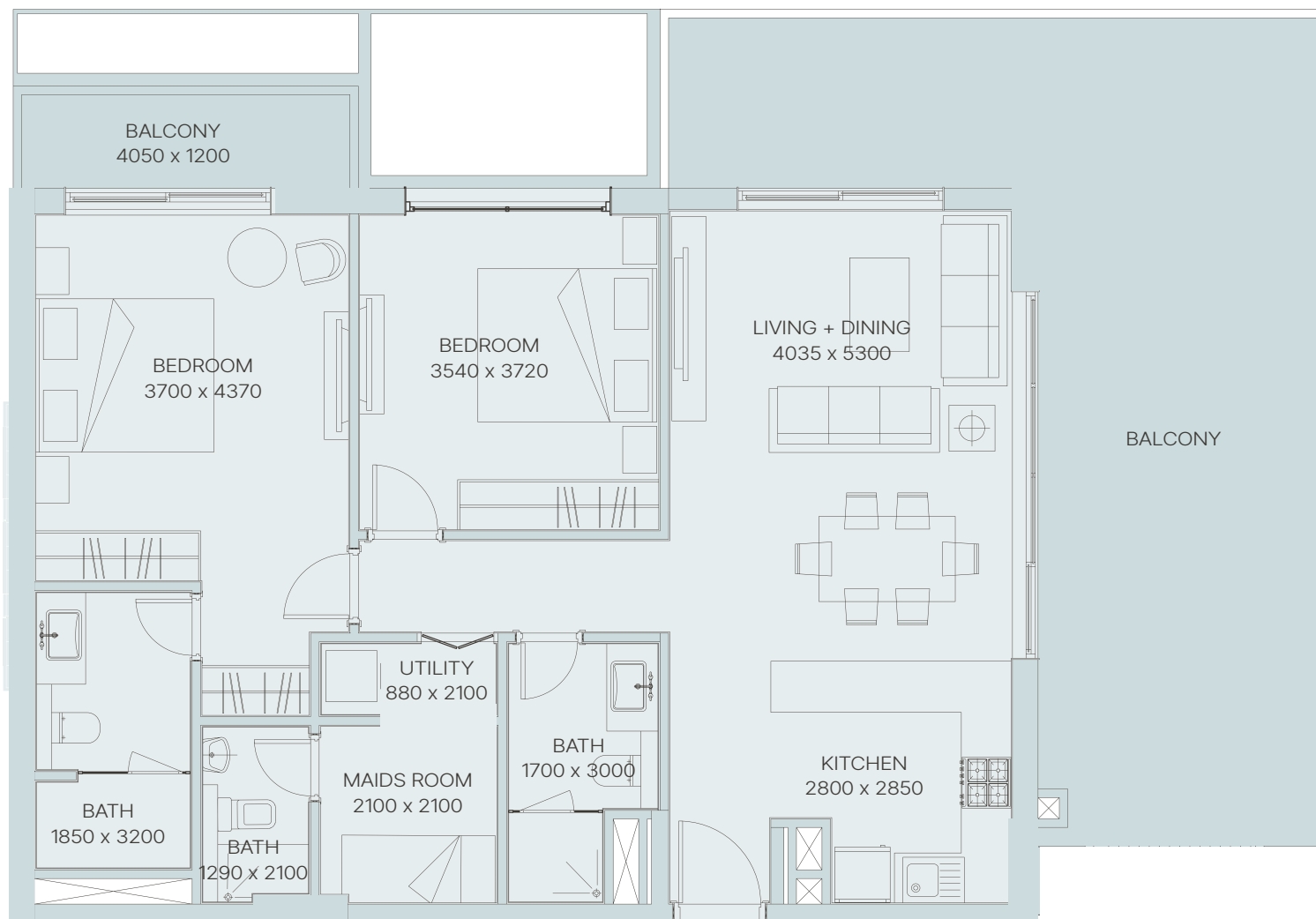

2 BEDROOM TYPE A

Internal Living Area	1045.07 sq.ft
Outdoor Living Area	543.90 sq.ft
Total Living Area	1588.97 sq.ft

All floor plans, layouts, and measurements are provided for illustrative purposes only and are subject to change without prior notice



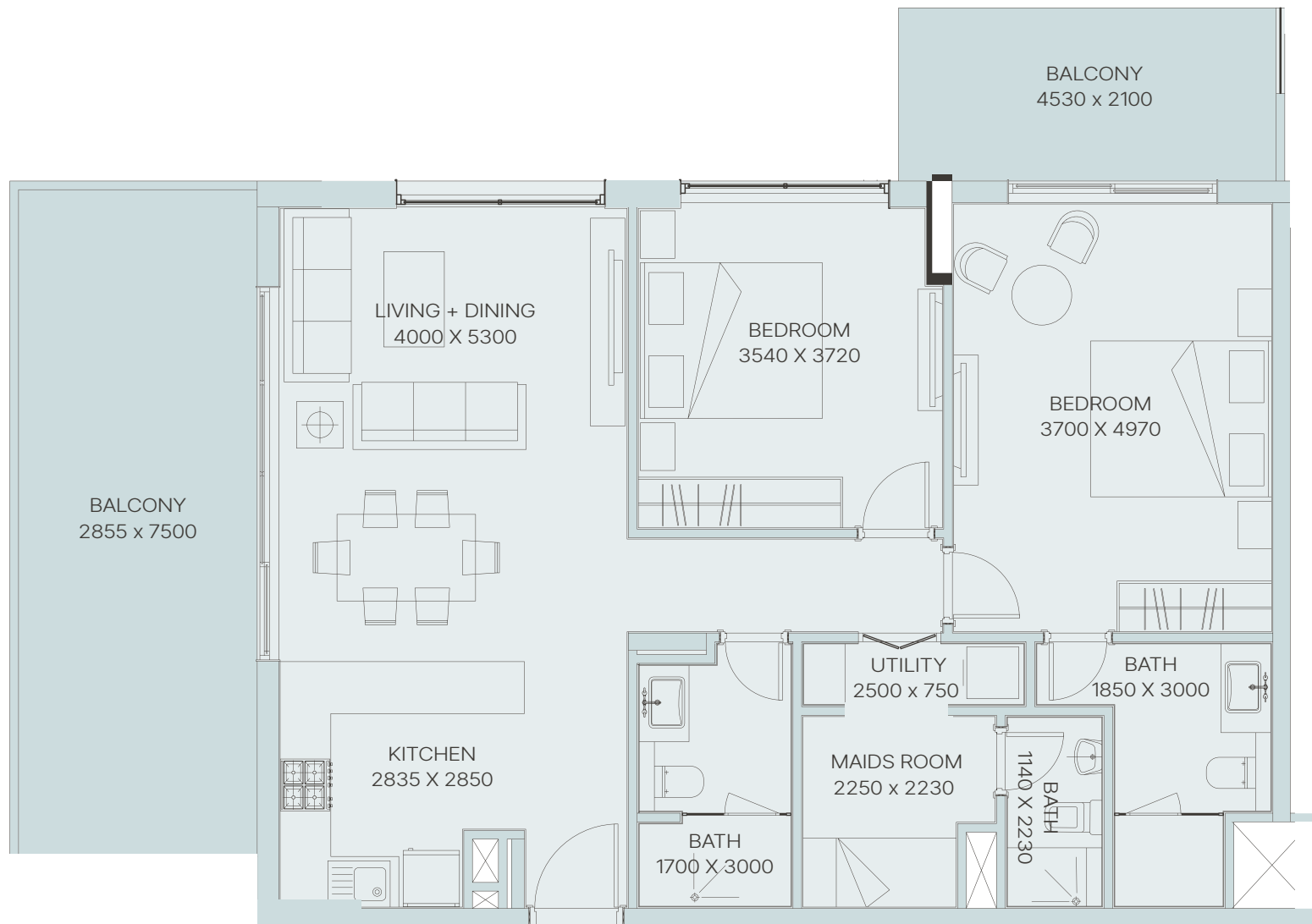

2 BEDROOM TYPE B

Internal Living Area	1045.82 sq.ft
Outdoor Living Area	359.94 sq.ft
Total Living Area	1405.77 sq.ft

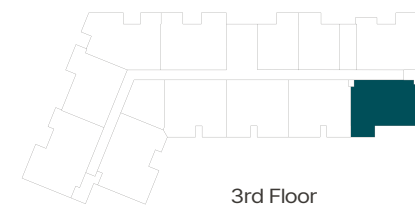
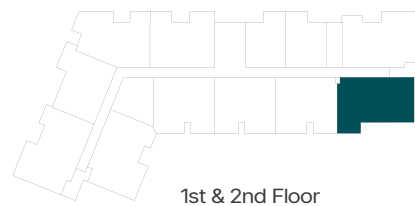

All floor plans, layouts, and measurements are provided for illustrative purposes only and are subject to change without prior notice

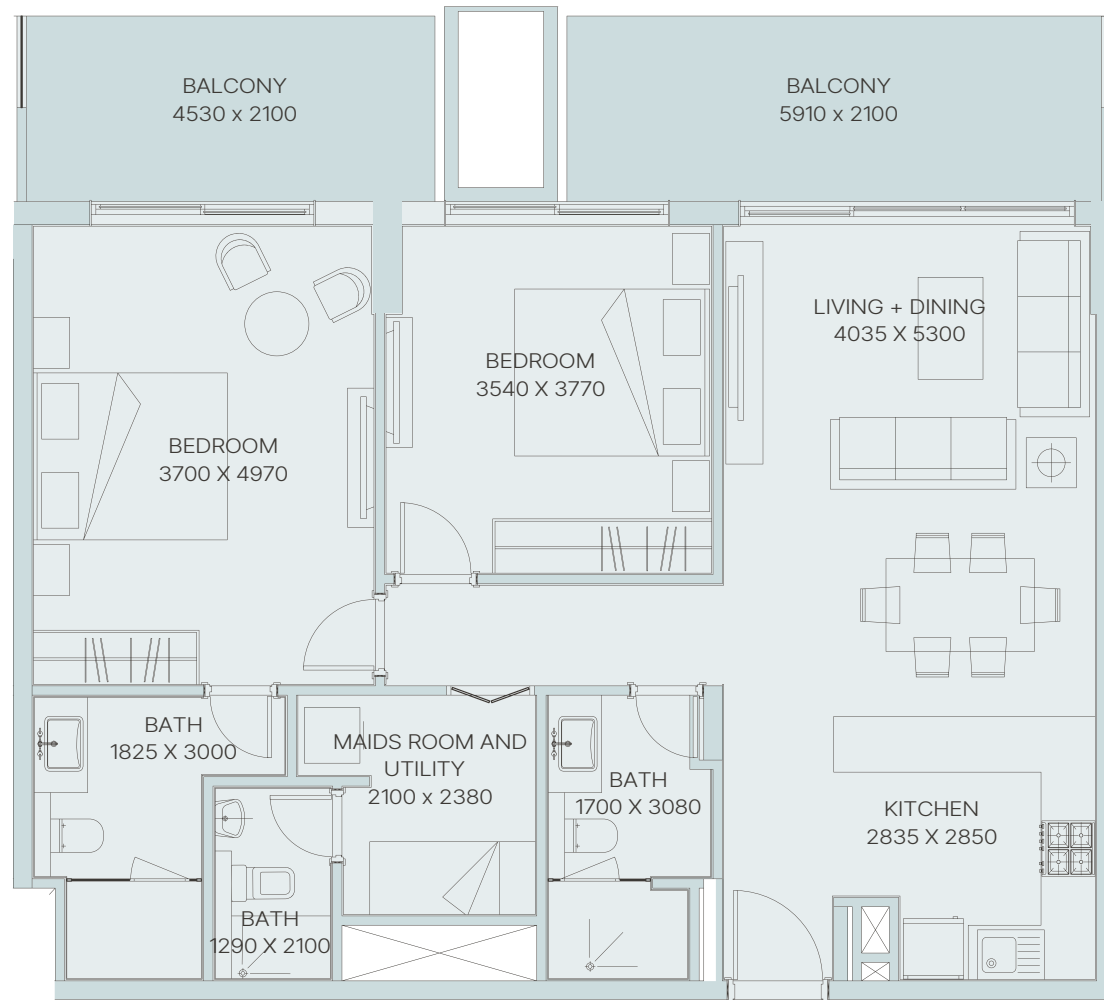

2 BEDROOM TYPE C

Internal Living Area	1027.41 sq.ft
Outdoor Living Area	243.80 sq.ft
Total Living Area	1271.22 sq.ft

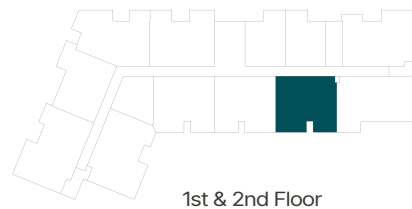

All floor plans, layouts, and measurements are provided for illustrative purposes only and are subject to change without prior notice

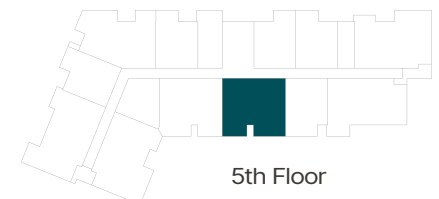
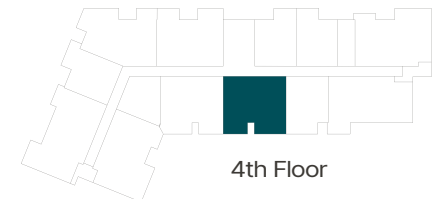
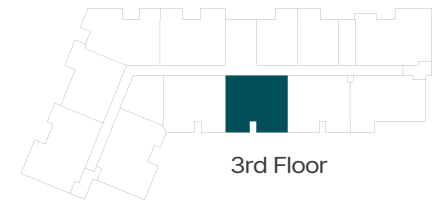
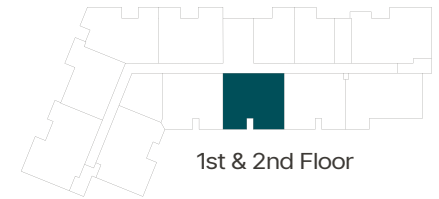
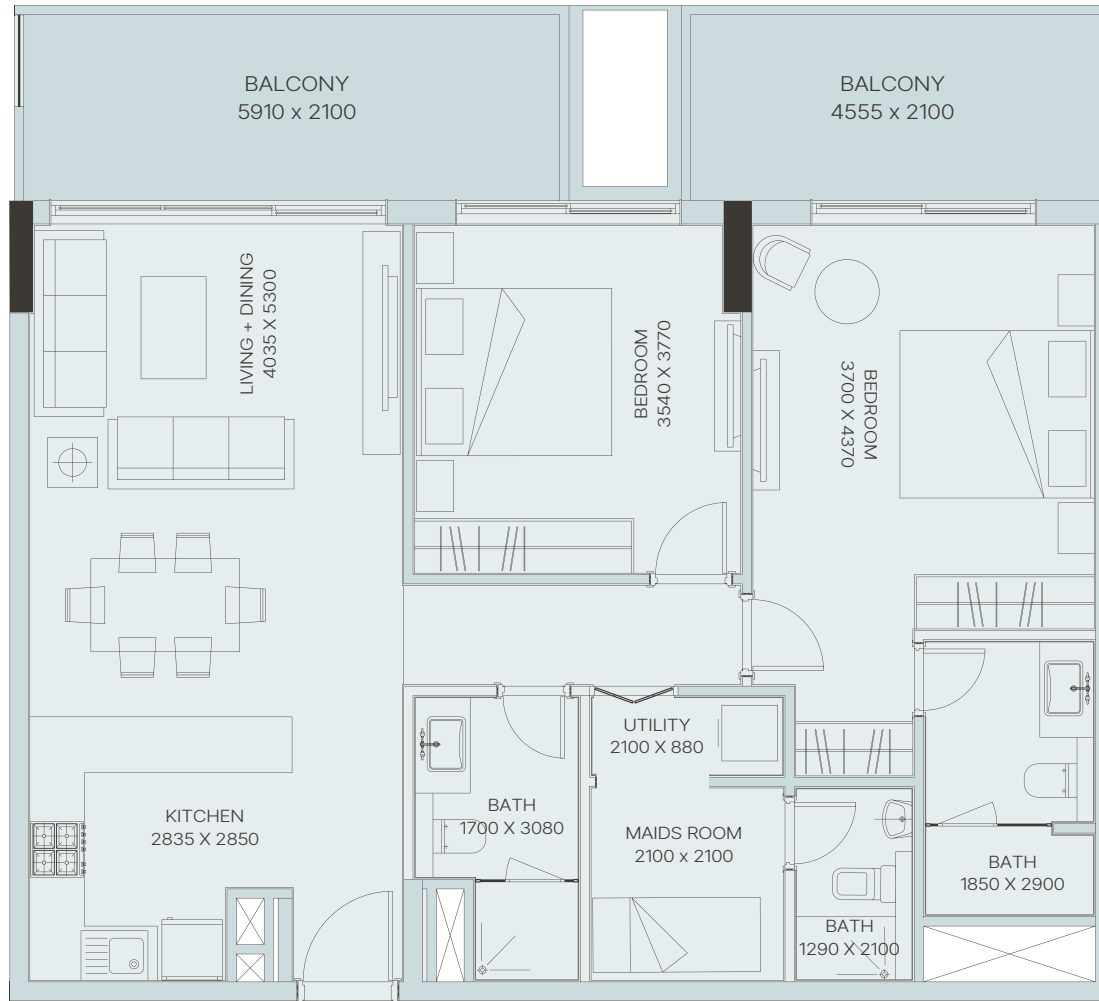

2 BEDROOM TYPE D

Internal Living Area	1027.84 sq.ft
Outdoor Living Area	244.13 sq.ft
Total Living Area	1271.97 sq.ft

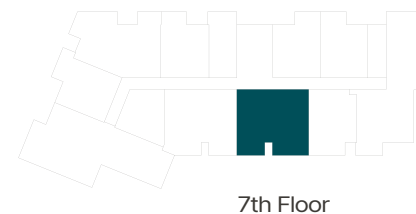
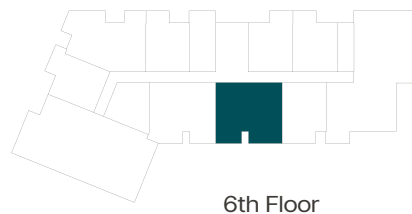

All floor plans, layouts, and measurements are provided for illustrative purposes only and are subject to change without prior notice

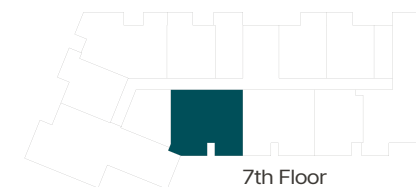
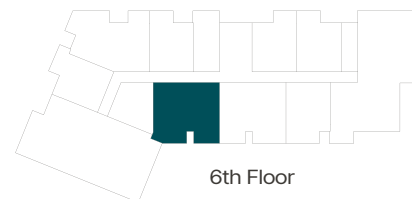
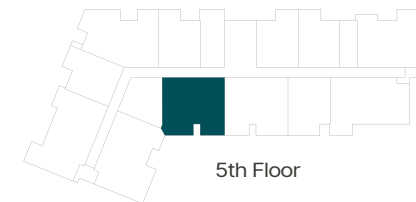
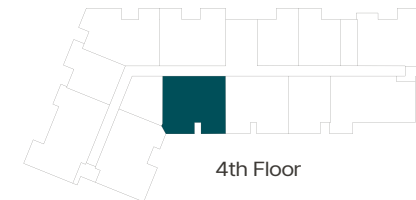
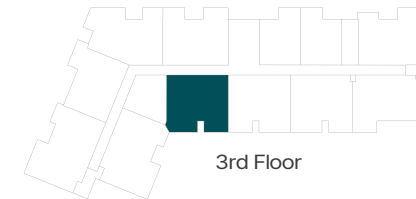
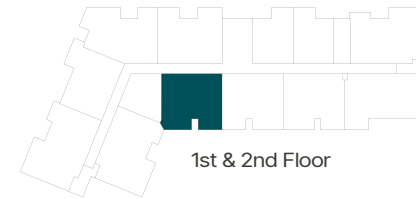
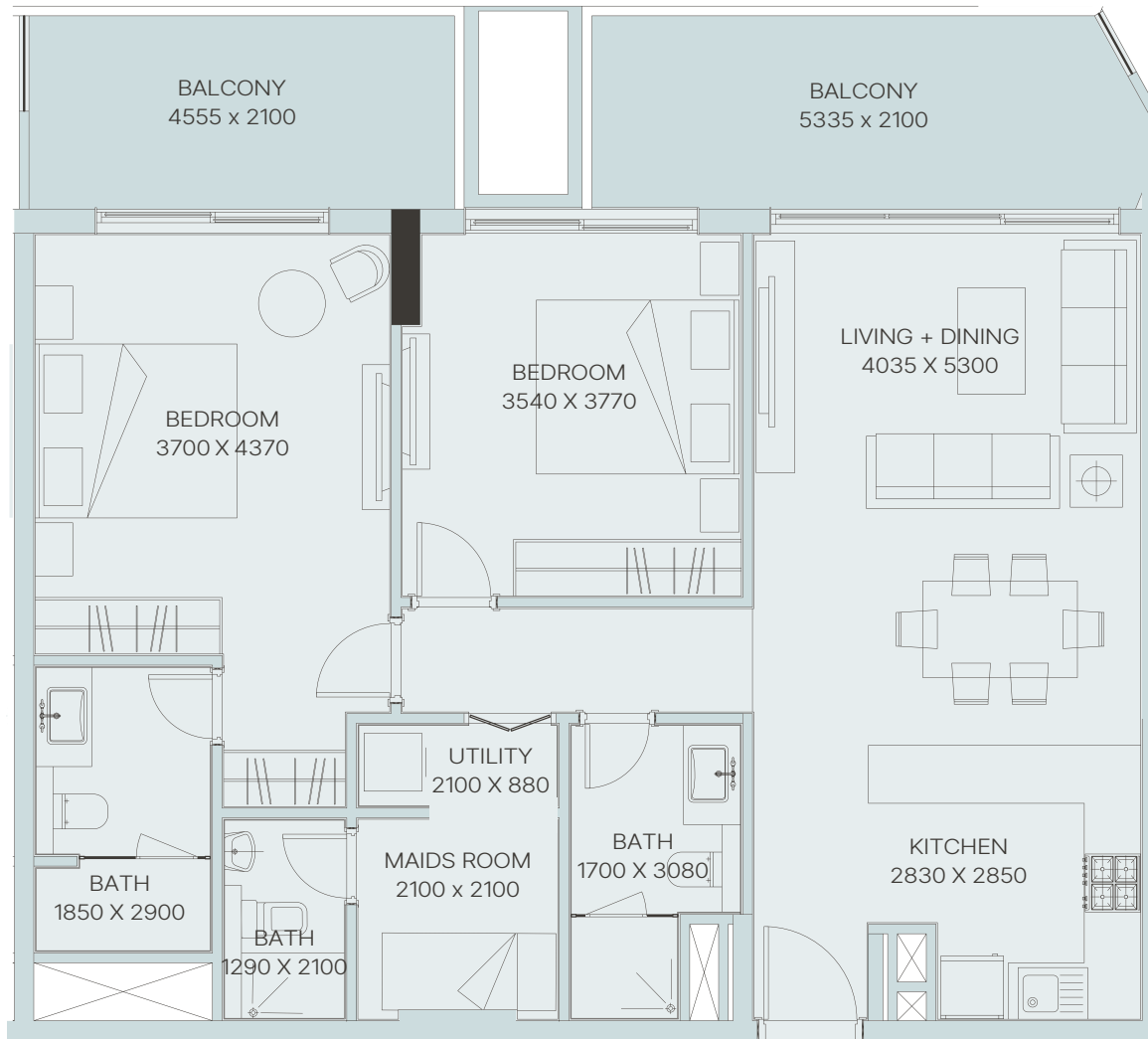

2 BEDROOM TYPE E

Internal Living Area	1029.78 sq.ft
Outdoor Living Area	241.65 sq.ft
Total Living Area	1271.43 sq.ft

All floor plans, layouts, and measurements are provided for illustrative purposes only and are subject to change without prior notice



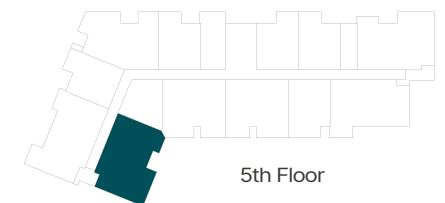
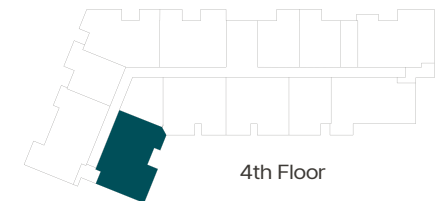
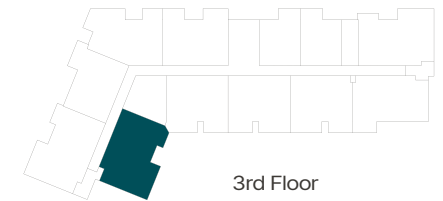
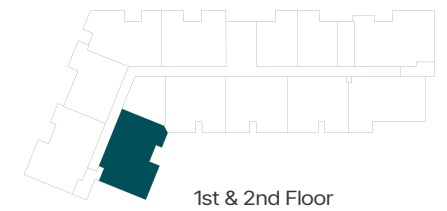
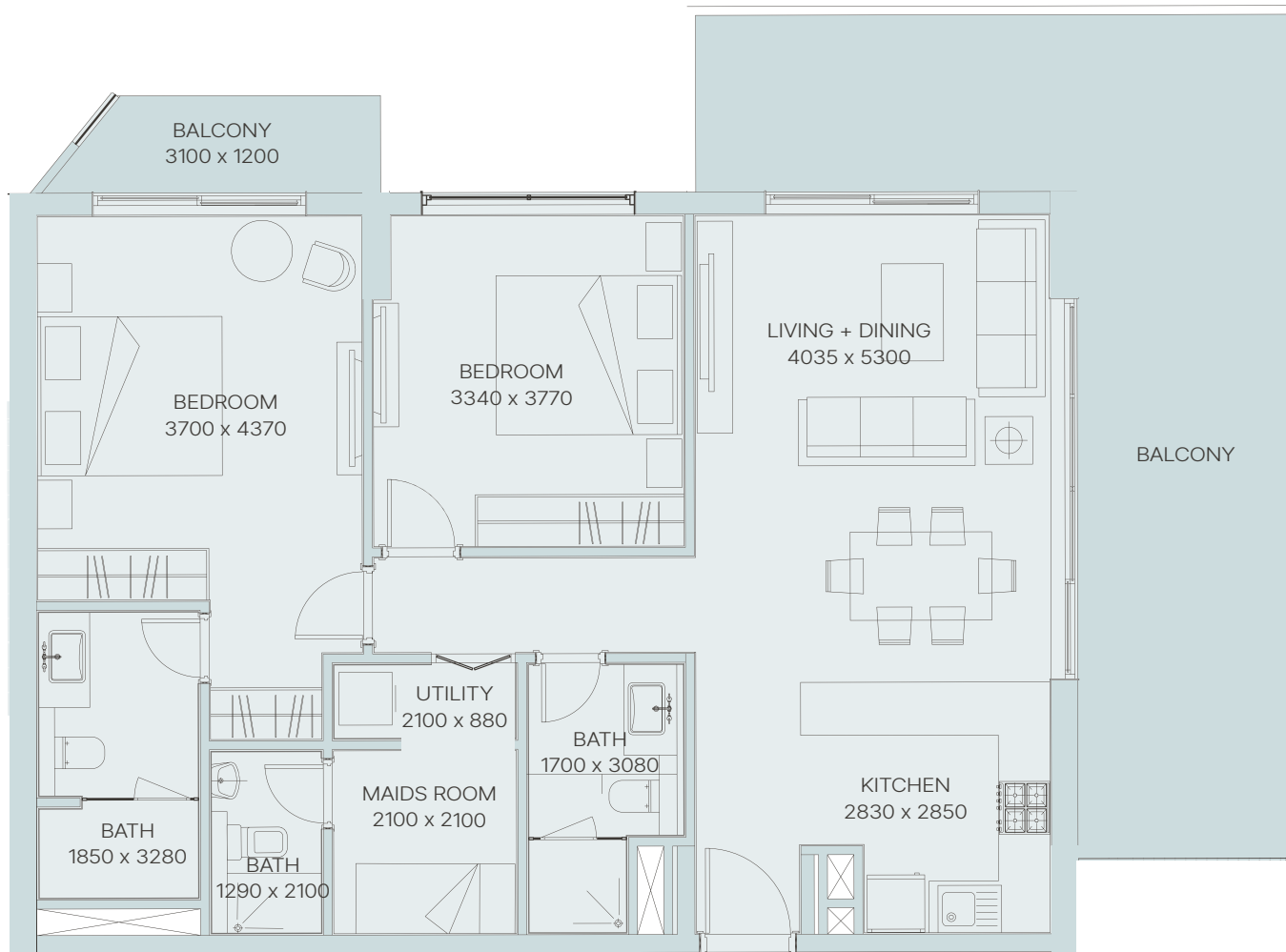

2 BEDROOM TYPE F

Internal Living Area	1049.80 sq.ft
Outdoor Living Area	434.22 sq.ft
Total Living Area	1484.02 sq.ft

All floor plans, layouts, and measurements are provided for illustrative purposes only and are subject to change without prior notice



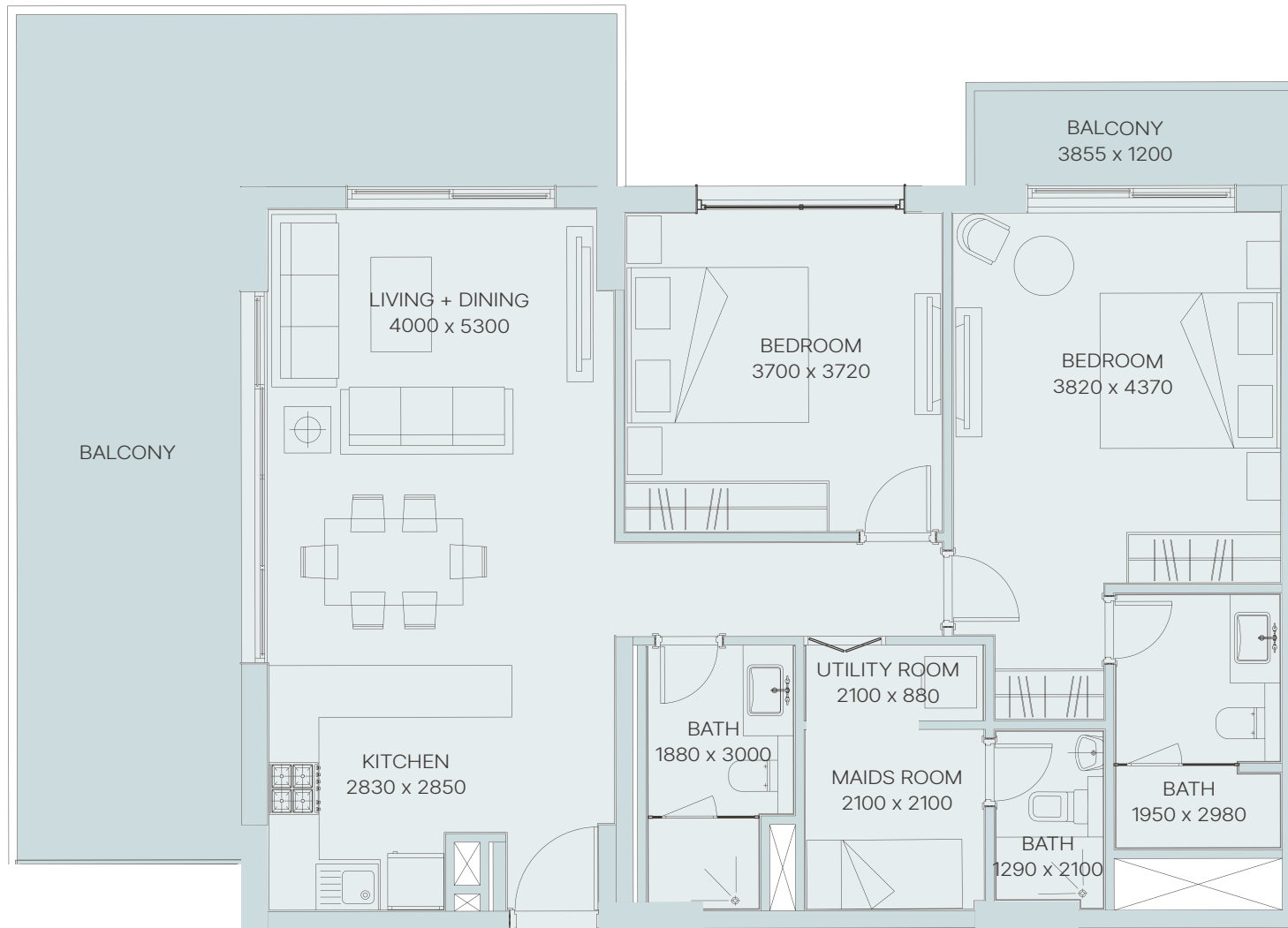

2 BEDROOM TYPE G

Internal Living Area	1050.66 sq.ft
Outdoor Living Area	470.17 sq.ft
Total Living Area	1520.83 sq.ft

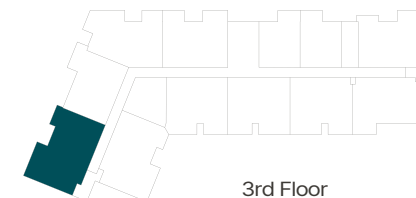
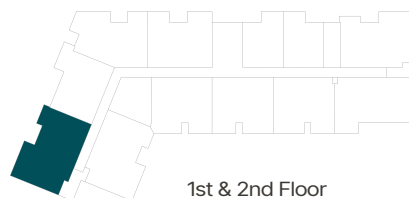

All floor plans, layouts, and measurements are provided for illustrative purposes only and are subject to change without prior notice

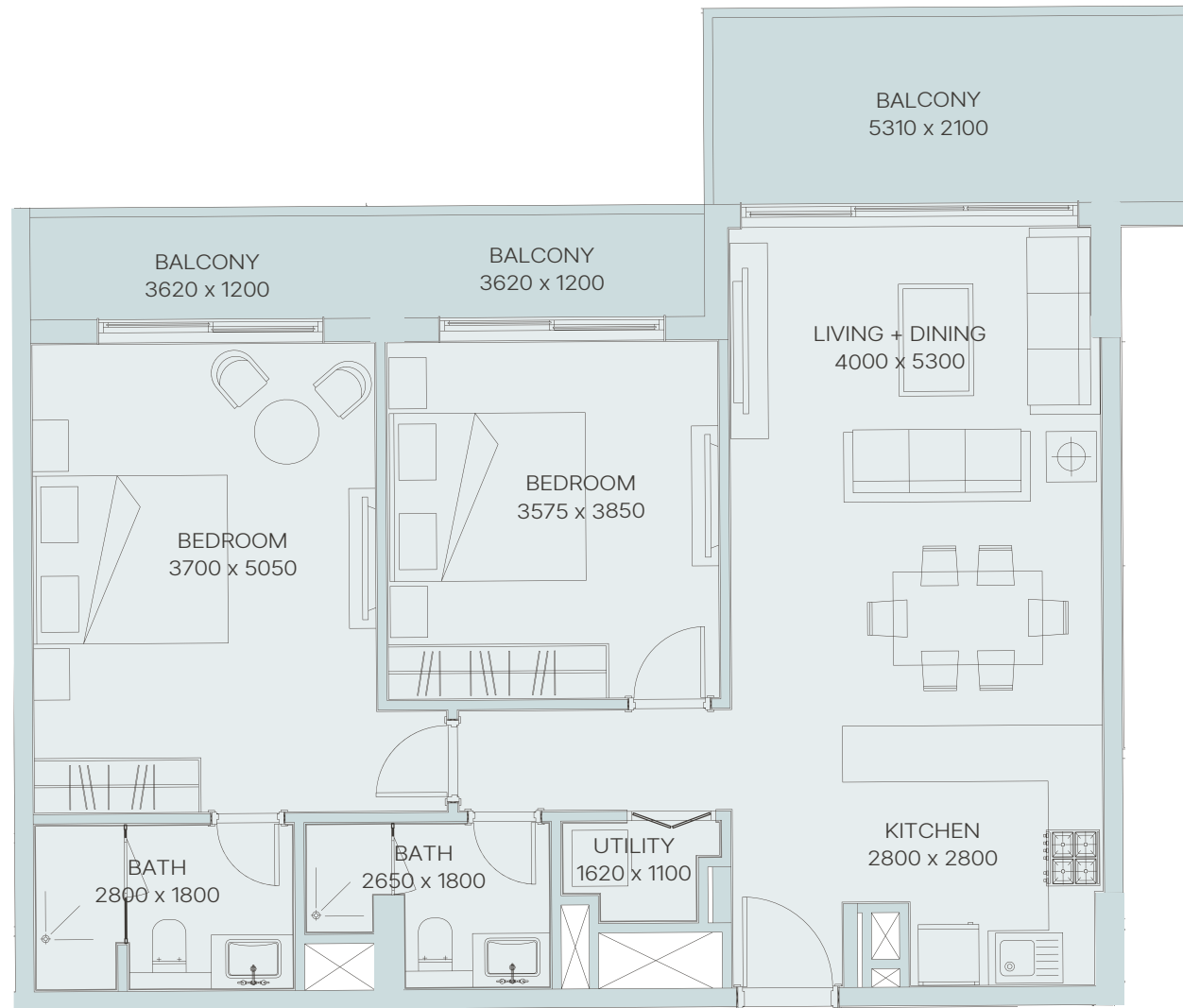

2 BEDROOM TYPE H

Internal Living Area	929.68 sq.ft
Outdoor Living Area	226.69 sq.ft
Total Living Area	1156.37 sq.ft

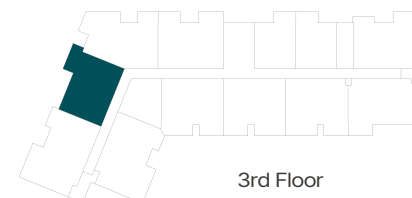
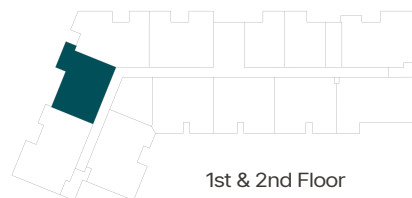

All floor plans, layouts, and measurements are provided for illustrative purposes only and are subject to change without prior notice

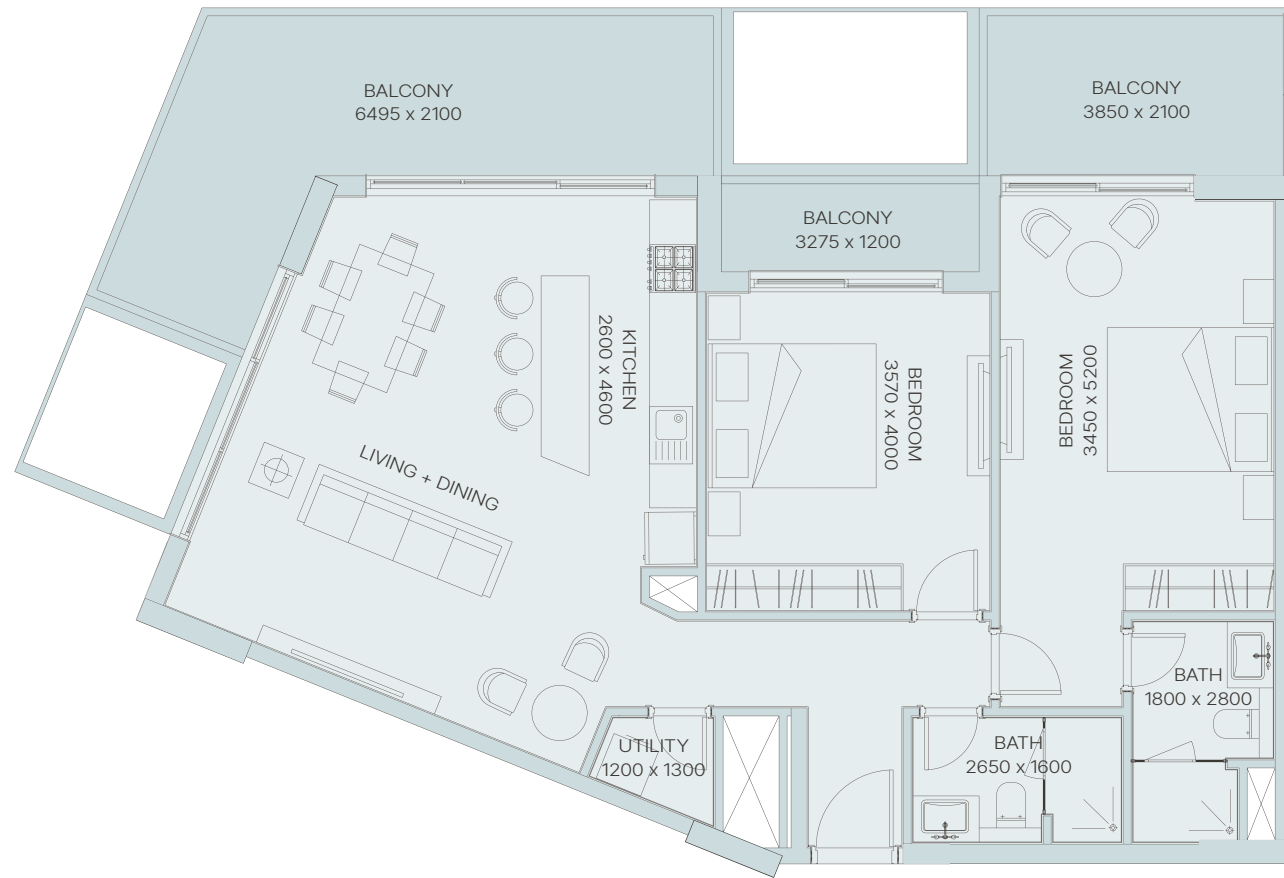
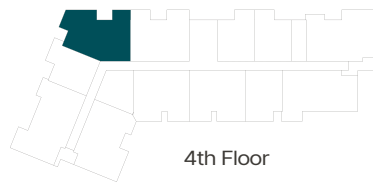
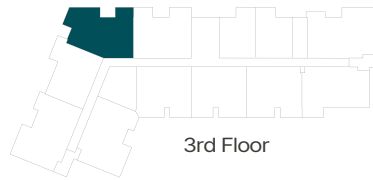
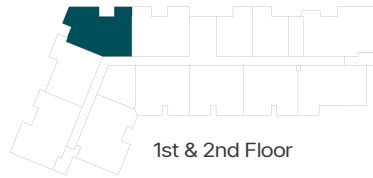

2 BEDROOM TYPE I

Internal Living Area	1013.10 sq.ft
Outdoor Living Area	345.52 sq.ft
Total Living Area	1358.62 sq.ft

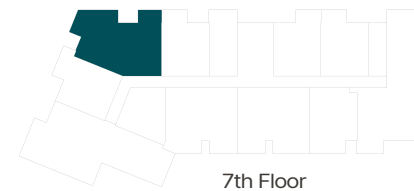

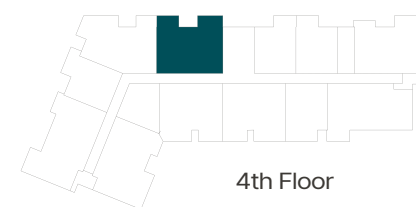
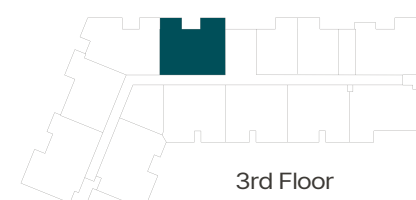
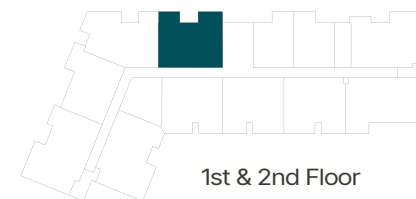
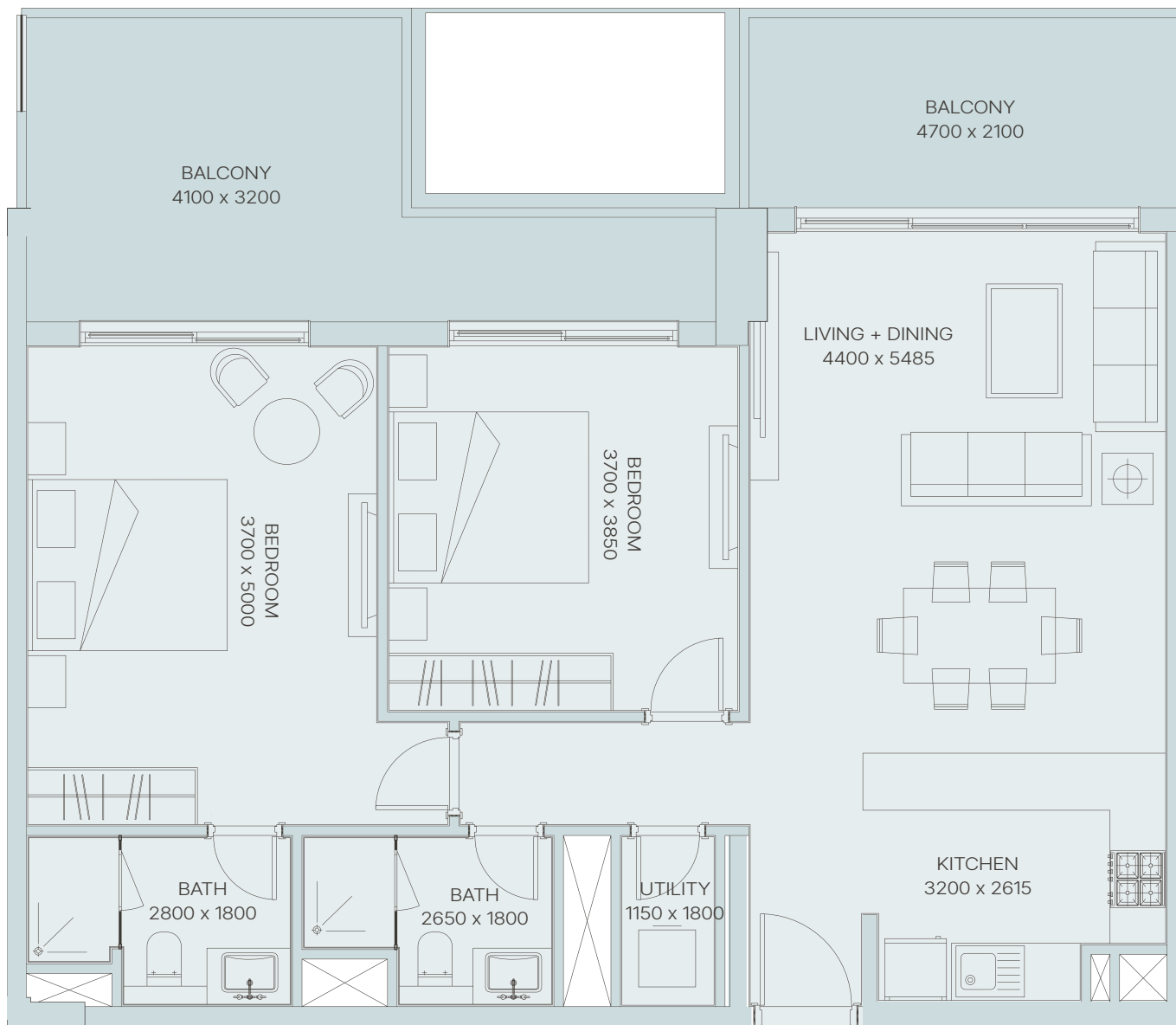

2 BEDROOM TYPE J

Internal Living Area	964.55 sq.ft
Outdoor Living Area	311.40 sq.ft
Total Living Area	1275.95 sq.ft



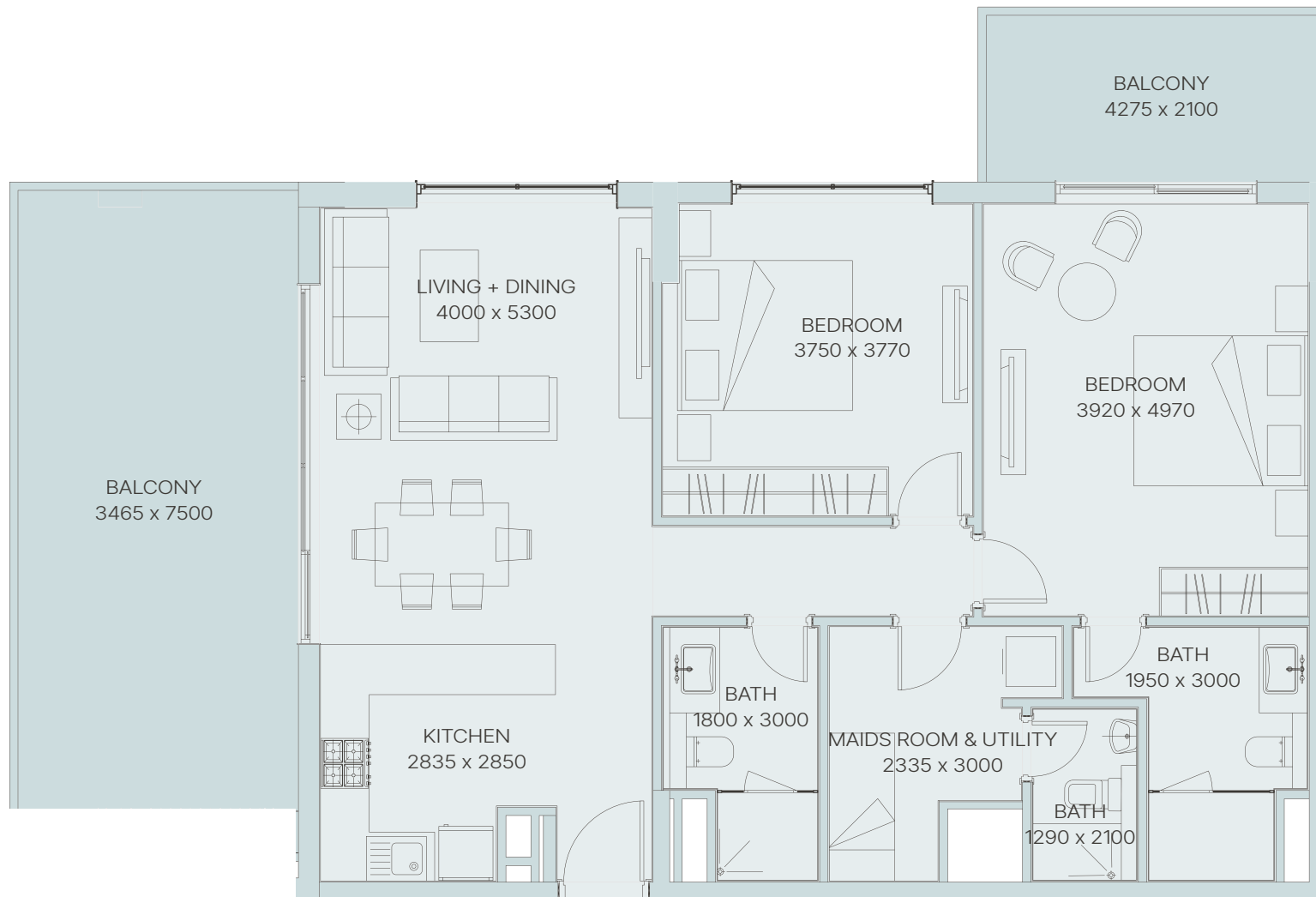

2 BEDROOM TYPE K

Internal Living Area	1072.73 sq.ft
Outdoor Living Area	396.54 sq.ft
Total Living Area	1469.27 sq.ft



All floor plans, layouts, and measurements are provided for illustrative purposes only and are subject to change without prior notice

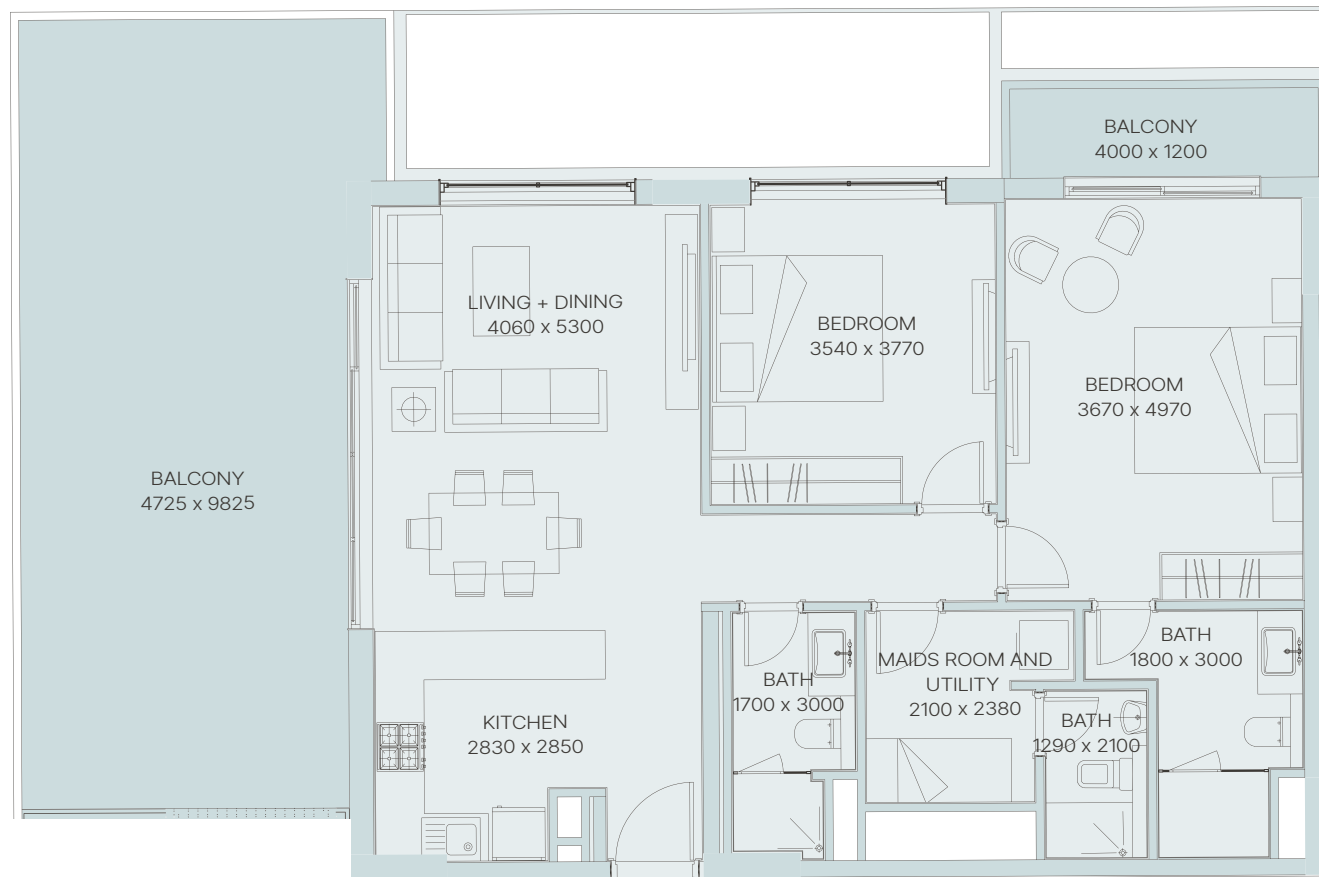

2 BEDROOM TYPE L

Internal Living Area	1031.61 sq.ft
Outdoor Living Area	526.35 sq.ft
Total Living Area	1557.97 sq.ft

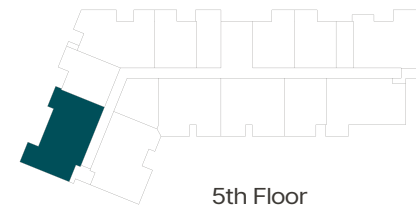
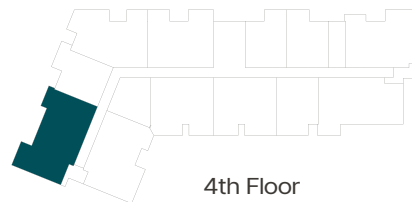

All floor plans, layouts, and measurements are provided for illustrative purposes only and are subject to change without prior notice

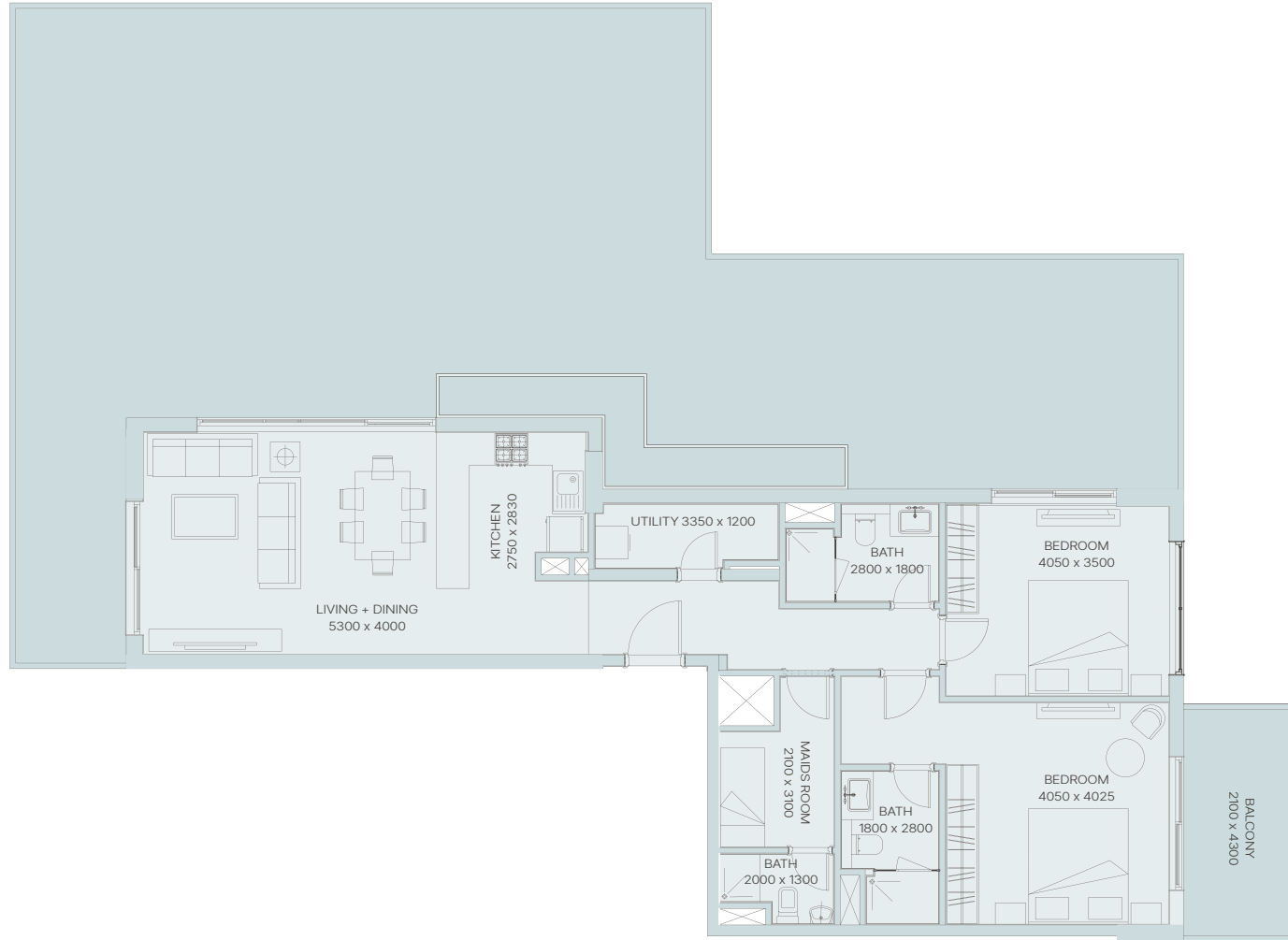

2 BEDROOM TYPE M

Internal Living Area	1135.81 sq.ft
Outdoor Living Area	1655.38 sq.ft
Total Living Area	2791.19 sq.ft

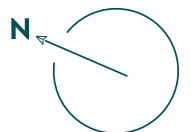
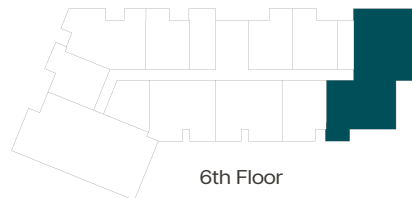

All floor plans, layouts, and measurements are provided for illustrative purposes only and are subject to change without prior notice

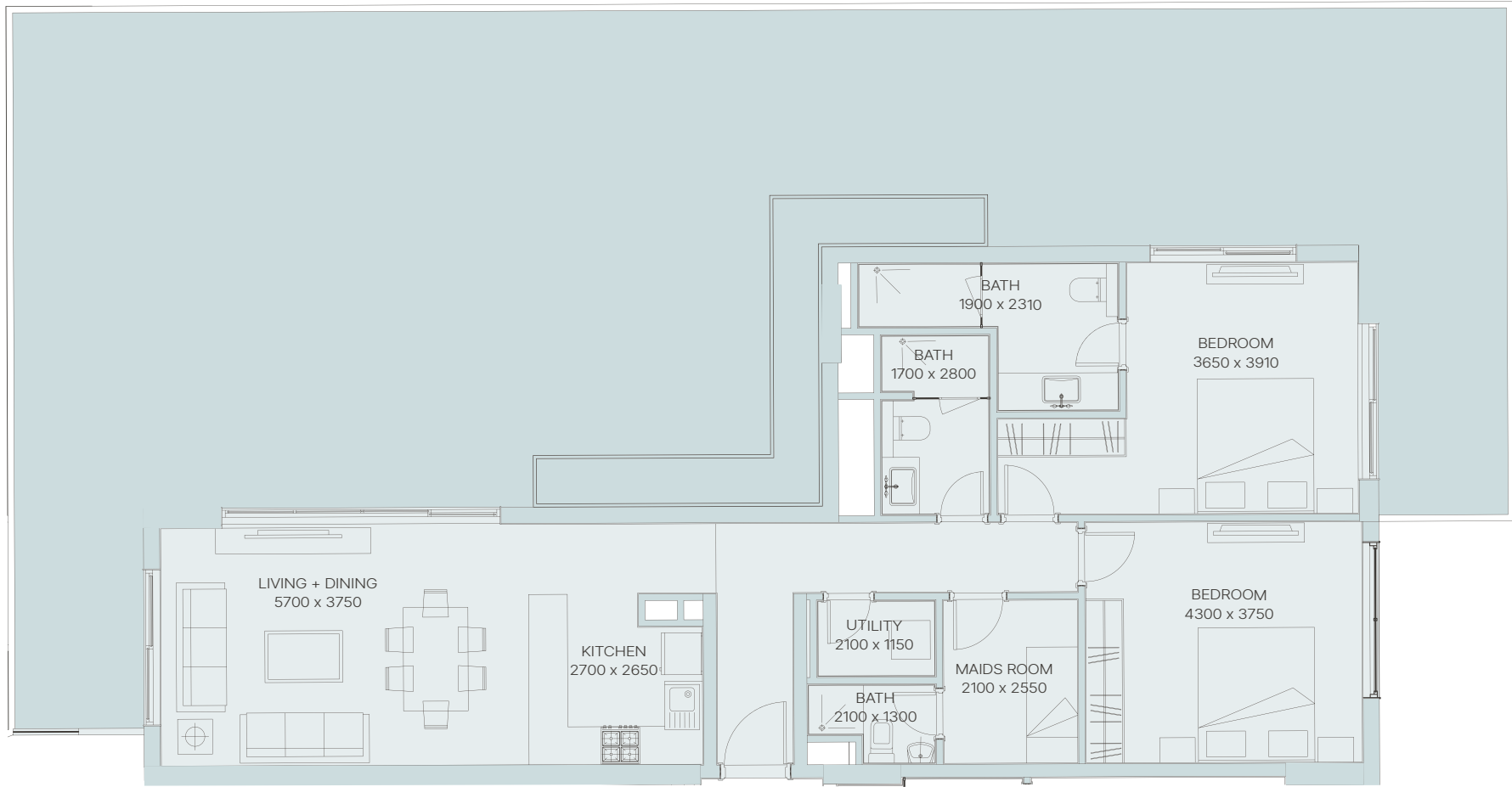

2 BEDROOM TYPE N

Internal Living Area	1140.44 sq.ft
Outdoor Living Area	1681.11 sq.ft
Total Living Area	2821.54 sq.ft

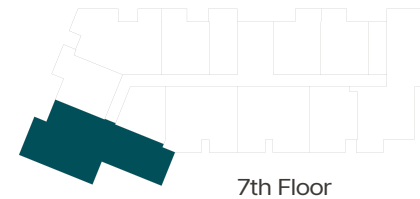
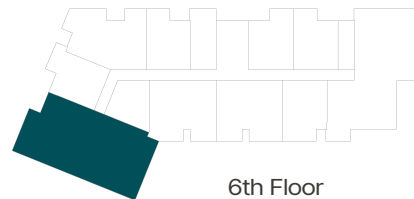

All floor plans, layouts, and measurements are provided for illustrative purposes only and are subject to change without prior notice



M E R A K I
DEVELOPERS

800-MERAKI (637254)

[MERAKIDEVELOPERS.COM](https://merakidevelopers.com)