

UNIT - AG01



## STUDIO

LEVEL : GROUND FLOOR	
UNIT NO : AG01	
SUITE AREA :	347 Sq.ft
BALCONY AREA :	81 Sq.ft
TOTAL AREA :	428 Sq.ft

Disclaimer: all pictures, plans, layouts, information, data and details included in this brochure are indicative only and may change at any time up to the final 'as built' status in accordance with the final designs of the project, regulatory approvals and planning permissions.

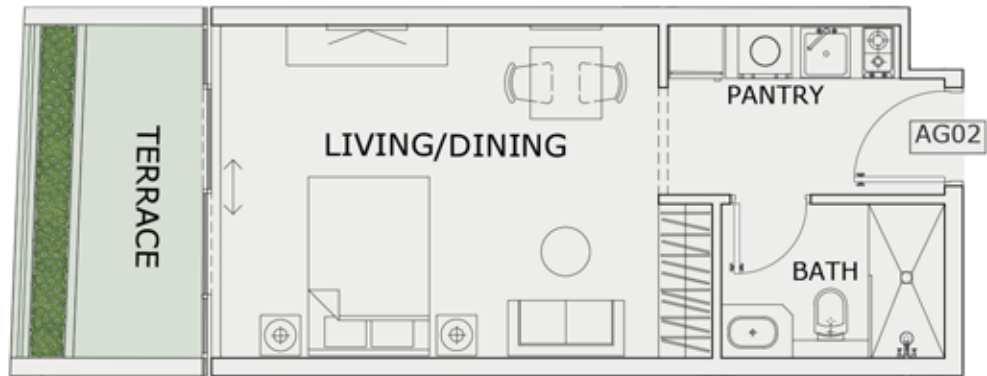

UNIT - AG02



## STUDIO

LEVEL : GROUND FLOOR	
UNIT NO : AG02	
SUITE AREA :	347 Sq.ft
BALCONY AREA :	88 Sq.ft
TOTAL AREA :	435 Sq.ft

Disclaimer: all pictures, plans, layouts, information, data and details included in this brochure are indicative only and may change at any time up to the final 'as built' status in accordance with the final designs of the project, regulatory approvals and planning permissions.

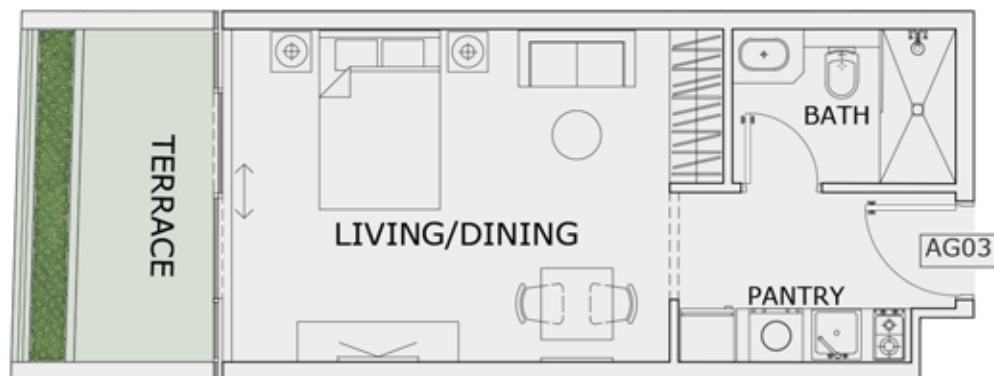

UNIT - AG03



## STUDIO

LEVEL : GROUND FLOOR	
UNIT NO : AG03	
SUITE AREA :	347 Sq.ft
BALCONY AREA :	93 Sq.ft
TOTAL AREA :	440 Sq.ft

Disclaimer: all pictures, plans, layouts, information, data and details included in this brochure are indicative only and may change at any time up to the final 'as built' status in accordance with the final designs of the project, regulatory approvals and planning permissions.

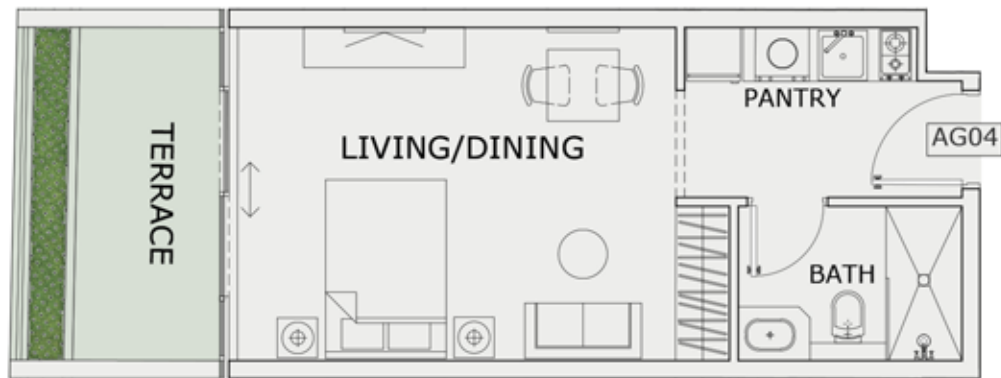

UNIT - AG04



## STUDIO

LEVEL : GROUND FLOOR	
UNIT NO : AG04	
SUITE AREA :	347 Sq.ft
BALCONY AREA :	98 Sq.ft
TOTAL AREA :	445 Sq.ft

Disclaimer: all pictures, plans, layouts, information, data and details included in this brochure are indicative only and may change at any time up to the final 'as built' status in accordance with the final designs of the project, regulatory approvals and planning permissions.



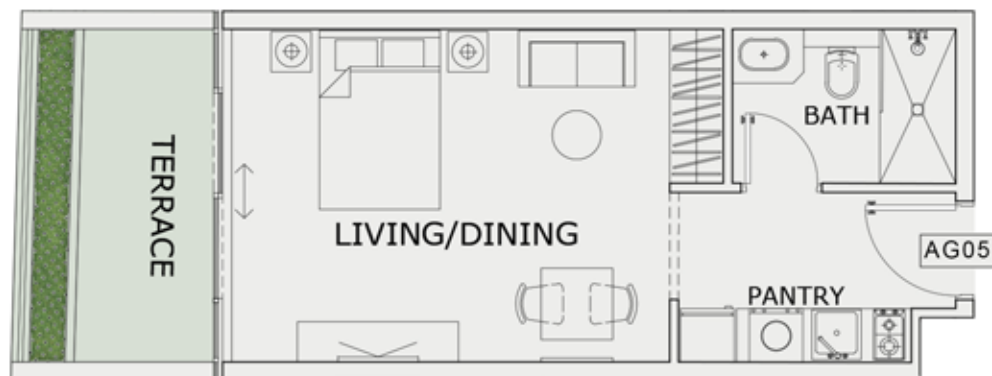

UNIT - AG05



STUDIO

LEVEL : GROUND FLOOR	
UNIT NO : AG05	
SUITE AREA :	347 Sq.ft
BALCONY AREA :	100 Sq.ft
TOTAL AREA :	447 Sq.ft

Disclaimer: all pictures, plans, layouts, information, data and details included in this brochure are indicative only and may change at any time up to the final 'as built' status in accordance with the final designs of the project, regulatory approvals and planning permissions.

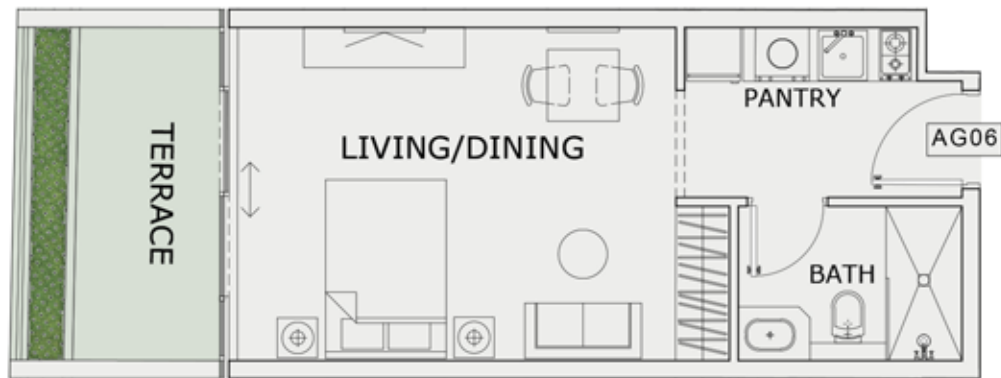

UNIT - AG06



## STUDIO

LEVEL : GROUND FLOOR	
UNIT NO : AG06	
SUITE AREA :	347 Sq.ft
BALCONY AREA :	102 Sq.ft
TOTAL AREA :	449 Sq.ft

Disclaimer: all pictures, plans, layouts, information, data and details included in this brochure are indicative only and may change at any time up to the final 'as built' status in accordance with the final designs of the project, regulatory approvals and planning permissions.

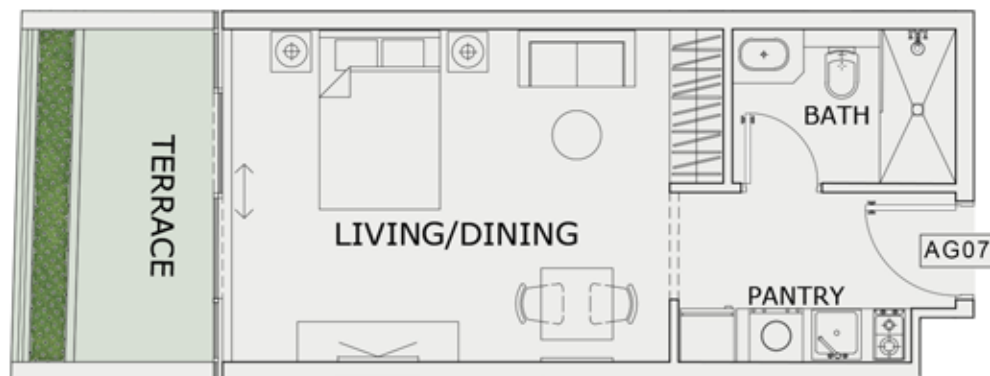

UNIT - AG07



## STUDIO

LEVEL : GROUND FLOOR

UNIT NO : AG07

SUITE AREA : 347 Sq.ft

BALCONY AREA : 102 Sq.ft

TOTAL AREA : 449 Sq.ft

Disclaimer: all pictures, plans, layouts, information, data and details included in this brochure are indicative only and may change at any time up to the final 'as built' status in accordance with the final designs of the project, regulatory approvals and planning permissions.

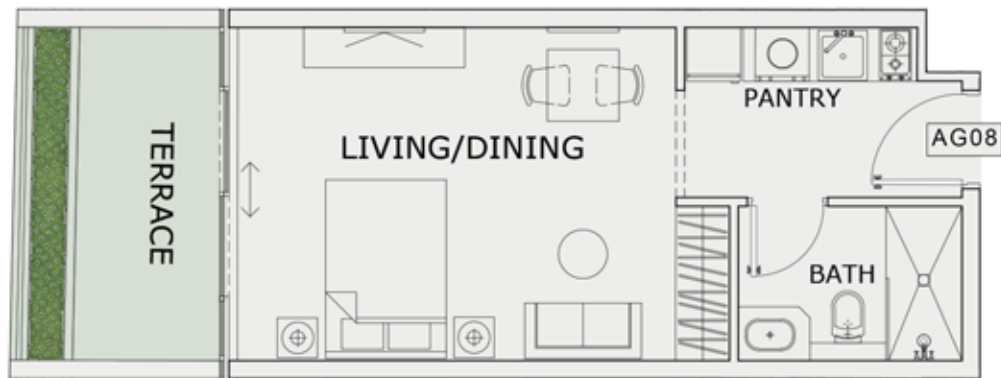

UNIT - AG08



## STUDIO

LEVEL : GROUND FLOOR	
UNIT NO : AG08	
SUITE AREA :	347 Sq.ft
BALCONY AREA :	101 Sq.ft
TOTAL AREA :	448 Sq.ft

Disclaimer: all pictures, plans, layouts, information, data and details included in this brochure are indicative only and may change at any time up to the final 'as built' status in accordance with the final designs of the project, regulatory approvals and planning permissions.

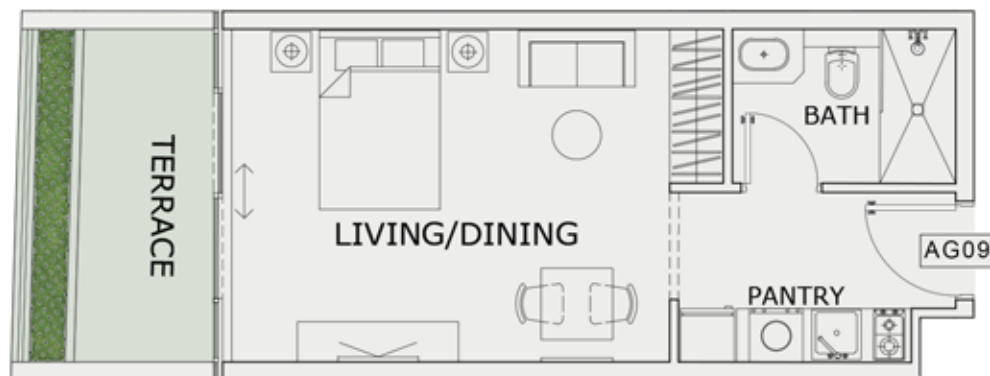

UNIT - AG09



## STUDIO

LEVEL : GROUND FLOOR	
UNIT NO : AG09	
SUITE AREA :	347 Sq.ft
BALCONY AREA :	98 Sq.ft
TOTAL AREA :	445 Sq.ft

Disclaimer: all pictures, plans, layouts, information, data and details included in this brochure are indicative only and may change at any time up to the final 'as built' status in accordance with the final designs of the project, regulatory approvals and planning permissions.



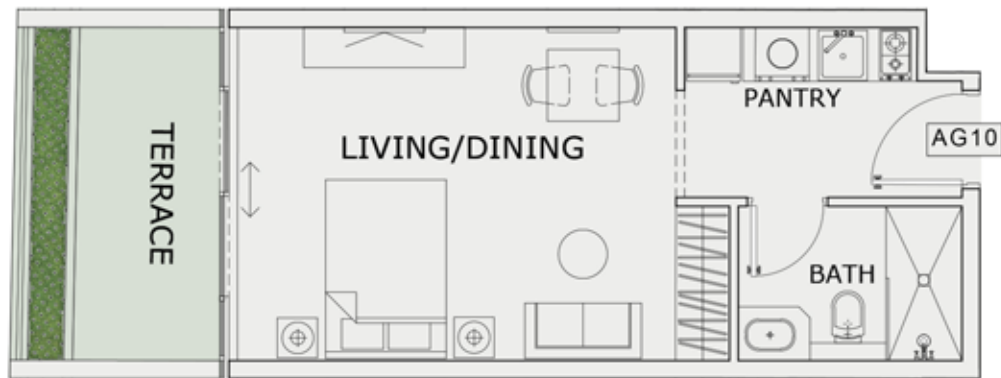

UNIT - AG10



STUDIO

LEVEL : GROUND FLOOR	
UNIT NO : AG10	
SUITE AREA :	347 Sq.ft
BALCONY AREA :	94 Sq.ft
TOTAL AREA :	441 Sq.ft

Disclaimer: all pictures, plans, layouts, information, data and details included in this brochure are indicative only and may change at any time up to the final 'as built' status in accordance with the final designs of the project, regulatory approvals and planning permissions.

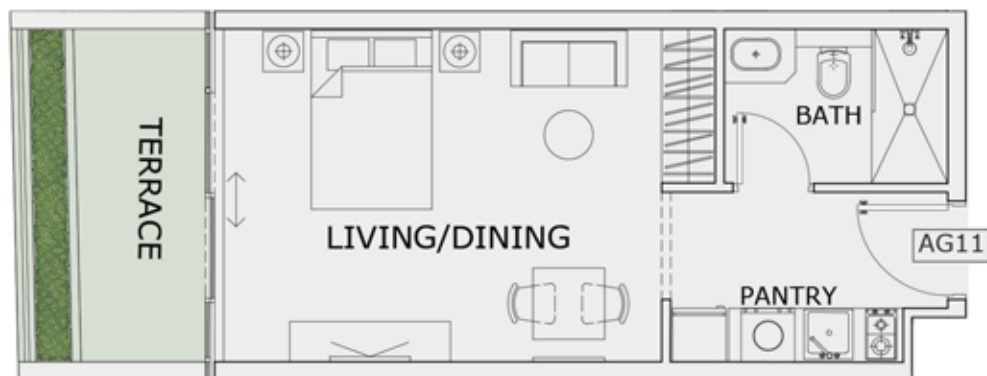

UNIT - AG11



## STUDIO

LEVEL : GROUND FLOOR

UNIT NO : AG11

SUITE AREA : 347 Sq.ft

BALCONY AREA : 90 Sq.ft

TOTAL AREA : 437 Sq.ft

Disclaimer: all pictures, plans, layouts, information, data and details included in this brochure are indicative only and may change at any time up to the final 'as built' status in accordance with the final designs of the project, regulatory approvals and planning permissions.

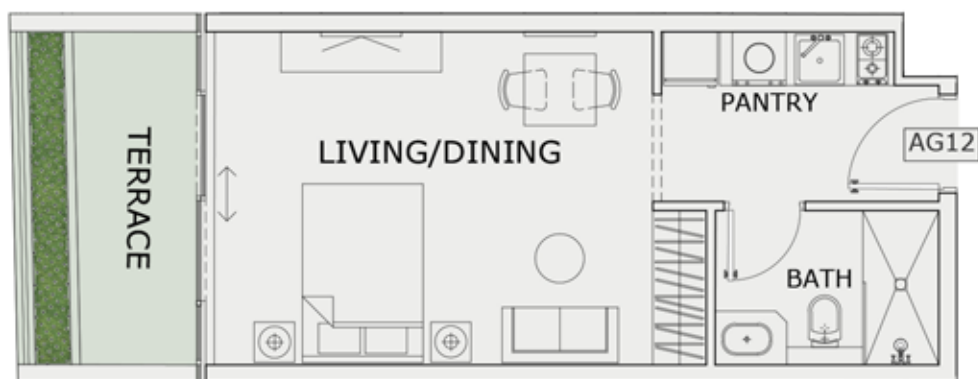

UNIT - AG12



## STUDIO

LEVEL : GROUND FLOOR	
UNIT NO : AG12	
SUITE AREA :	347 Sq.ft
BALCONY AREA :	86 Sq.ft
TOTAL AREA :	433 Sq.ft

Disclaimer: all pictures, plans, layouts, information, data and details included in this brochure are indicative only and may change at any time up to the final 'as built' status in accordance with the final designs of the project, regulatory approvals and planning permissions.

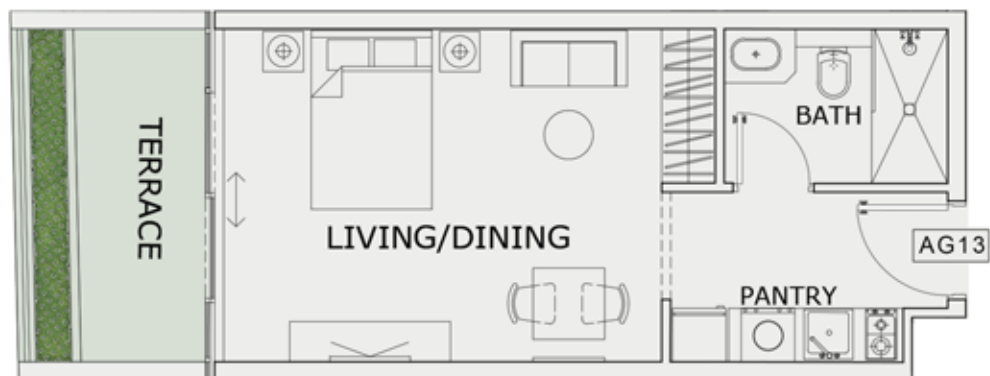

UNIT - AG13



STUDIO

LEVEL : GROUND FLOOR	
UNIT NO : AG13	
SUITE AREA :	347 Sq.ft
BALCONY AREA :	83 Sq.ft
TOTAL AREA :	430 Sq.ft

Disclaimer: all pictures, plans, layouts, information, data and details included in this brochure are indicative only and may change at any time up to the final 'as built' status in accordance with the final designs of the project, regulatory approvals and planning permissions.

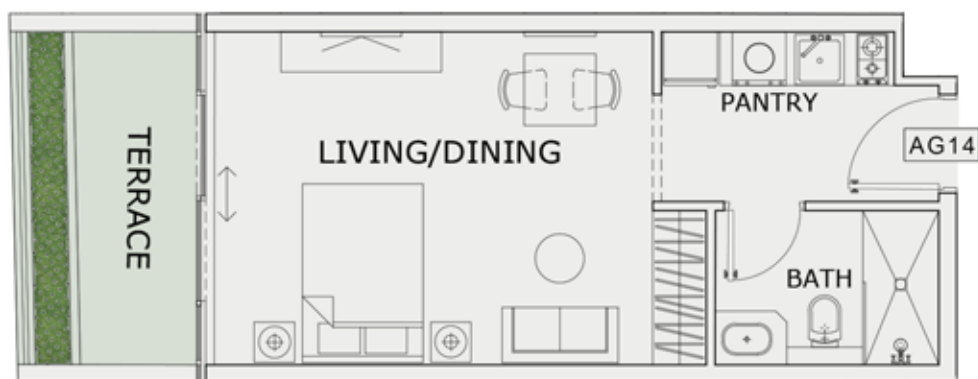

UNIT - AG14



## STUDIO

LEVEL : GROUND FLOOR

UNIT NO : AG14

SUITE AREA : 347 Sq.ft

BALCONY AREA : 79 Sq.ft

TOTAL AREA : 426 Sq.ft

Disclaimer: all pictures, plans, layouts, information, data and details included in this brochure are indicative only and may change at any time up to the final 'as built' status in accordance with the final designs of the project, regulatory approvals and planning permissions.



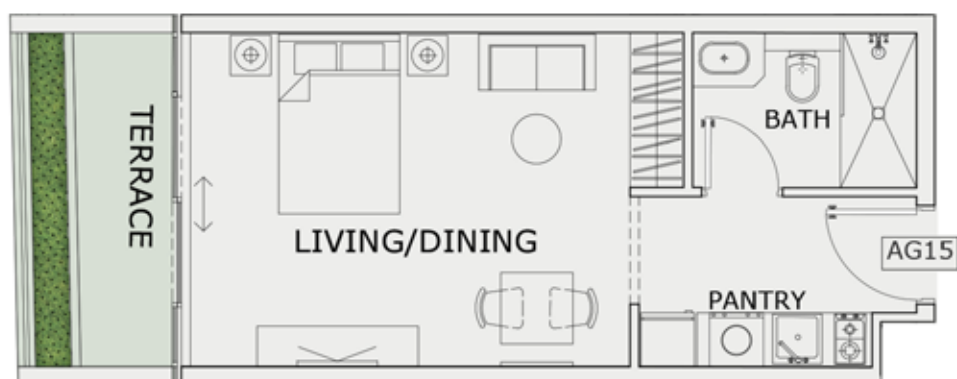

UNIT - AG15



STUDIO

LEVEL : GROUND FLOOR	
UNIT NO : AG15	
SUITE AREA :	347 Sq.ft
BALCONY AREA :	75 Sq.ft
TOTAL AREA :	422 Sq.ft

Disclaimer: all pictures, plans, layouts, information, data and details included in this brochure are indicative only and may change at any time up to the final 'as built' status in accordance with the final designs of the project, regulatory approvals and planning permissions.



UNIT - AG16



## STUDIO

LEVEL : GROUND FLOOR

UNIT NO : AG16

SUITE AREA : 347 Sq.ft

BALCONY AREA : 71 Sq.ft

TOTAL AREA : 418 Sq.ft

Disclaimer: all pictures, plans, layouts, information, data and details included in this brochure are indicative only and may change at any time up to the final 'as built' status in accordance with the final designs of the project, regulatory approvals and planning permissions.



UNIT - AG17

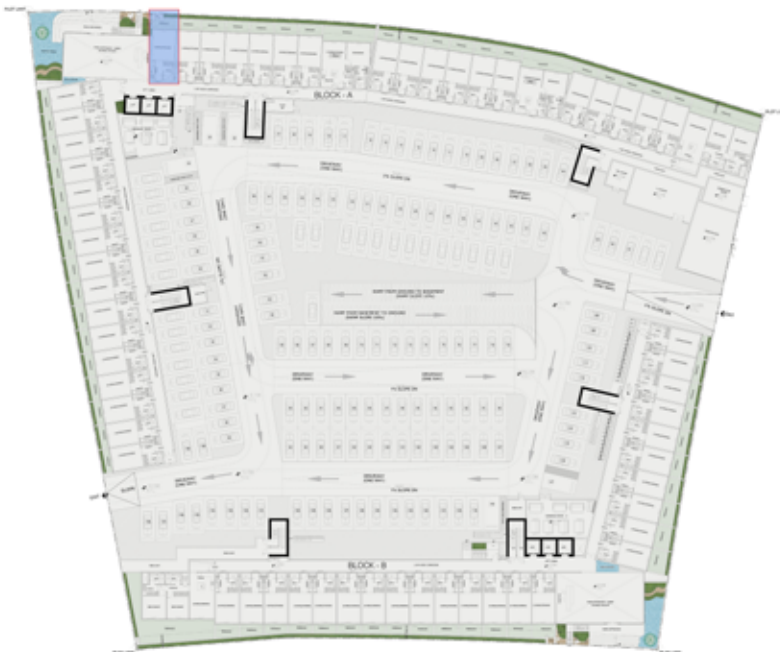

## STUDIO

LEVEL : GROUND FLOOR	
UNIT NO : AG17	
SUITE AREA :	347 Sq.ft
BALCONY AREA :	77 Sq.ft
TOTAL AREA :	424 Sq.ft

Disclaimer: all pictures, plans, layouts, information, data and details included in this brochure are indicative only and may change at any time up to the final 'as built' status in accordance with the final designs of the project, regulatory approvals and planning permissions.



UNIT - AG18



## STUDIO

LEVEL : GROUND FLOOR

UNIT NO : AG18

SUITE AREA :	347 Sq.ft
--------------	-----------

BALCONY AREA :	80 Sq.ft
----------------	----------

TOTAL AREA :	427 Sq.ft
--------------	-----------

Disclaimer: all pictures, plans, layouts, information, data and details included in this brochure are indicative only and may change at any time up to the final 'as built' status in accordance with the final designs of the project, regulatory approvals and planning permissions.



UNIT - AG19



## STUDIO

LEVEL : GROUND FLOOR	
UNIT NO : AG19	
SUITE AREA :	347 Sq.ft
BALCONY AREA :	80 Sq.ft
TOTAL AREA :	427 Sq.ft

Disclaimer: all pictures, plans, layouts, information, data and details included in this brochure are indicative only and may change at any time up to the final 'as built' status in accordance with the final designs of the project, regulatory approvals and planning permissions.





UNIT - AG20



## STUDIO

LEVEL : GROUND FLOOR	
UNIT NO : AG20	
SUITE AREA :	347 Sq.ft
BALCONY AREA :	79 Sq.ft
TOTAL AREA :	426 Sq.ft

Disclaimer: all pictures, plans, layouts, information, data and details included in this brochure are indicative only and may change at any time up to the final 'as built' status in accordance with the final designs of the project, regulatory approvals and planning permissions.



UNIT - AG21

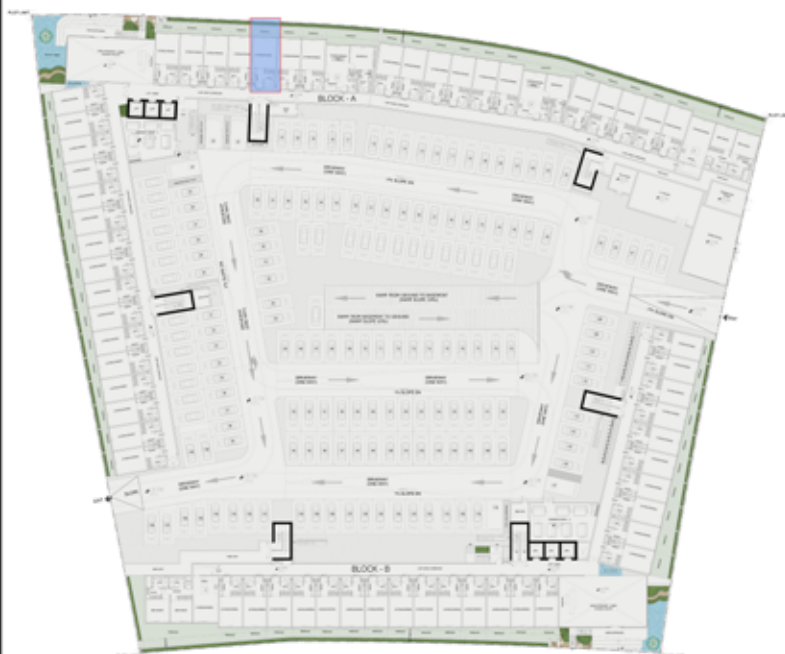

## STUDIO

LEVEL : GROUND FLOOR

UNIT NO : AG21

SUITE AREA : 347 Sq.ft

BALCONY AREA : 79 Sq.ft

TOTAL AREA : 426 Sq.ft

Disclaimer: all pictures, plans, layouts, information, data and details included in this brochure are indicative only and may change at any time up to the final 'as built' status in accordance with the final designs of the project, regulatory approvals and planning permissions.



UNIT - AG22



## STUDIO

LEVEL : GROUND FLOOR	
UNIT NO : AG22	
SUITE AREA :	347 Sq.ft
BALCONY AREA :	80 Sq.ft
TOTAL AREA :	427 Sq.ft

Disclaimer: all pictures, plans, layouts, information, data and details included in this brochure are indicative only and may change at any time up to the final 'as built' status in accordance with the final designs of the project, regulatory approvals and planning permissions.



UNIT - AG23

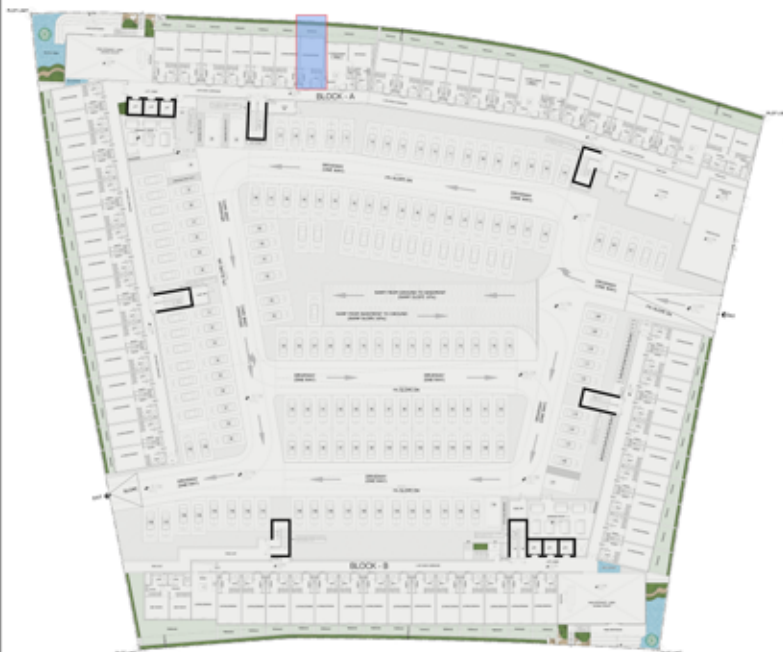

## STUDIO

LEVEL : GROUND FLOOR

UNIT NO : AG23

SUITE AREA : 347 Sq.ft

BALCONY AREA : 79 Sq.ft

TOTAL AREA : 426 Sq.ft

Disclaimer: all pictures, plans, layouts, information, data and details included in this brochure are indicative only and may change at any time up to the final 'as built' status in accordance with the final designs of the project, regulatory approvals and planning permissions.

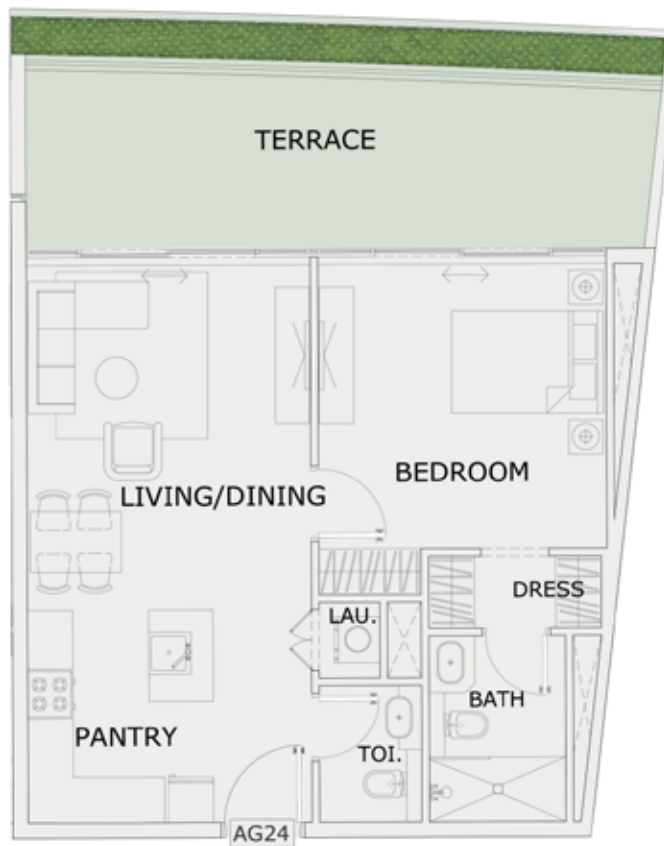

UNIT - AG24

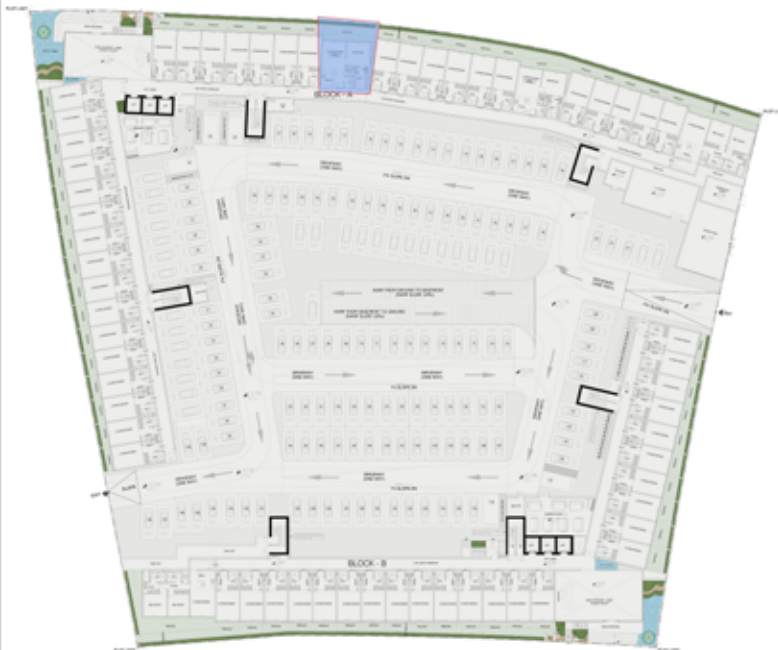

1 BHK

LEVEL : GROUND FLOOR	
UNIT NO : AG24	
SUITE AREA :	612 Sq.ft
BALCONY AREA :	224 Sq.ft
TOTAL AREA :	836 Sq.ft

Disclaimer: all pictures, plans, layouts, information, data and details included in this brochure are indicative only and may change at any time up to the final 'as built' status in accordance with the final designs of the project, regulatory approvals and planning permissions.





UNIT - AG25



## STUDIO

LEVEL : GROUND FLOOR	
UNIT NO : AG25	
SUITE AREA :	347 Sq.ft
BALCONY AREA :	73 Sq.ft
TOTAL AREA :	420 Sq.ft

Disclaimer: all pictures, plans, layouts, information, data and details included in this brochure are indicative only and may change at any time up to the final 'as built' status in accordance with the final designs of the project, regulatory approvals and planning permissions.



UNIT - AG26

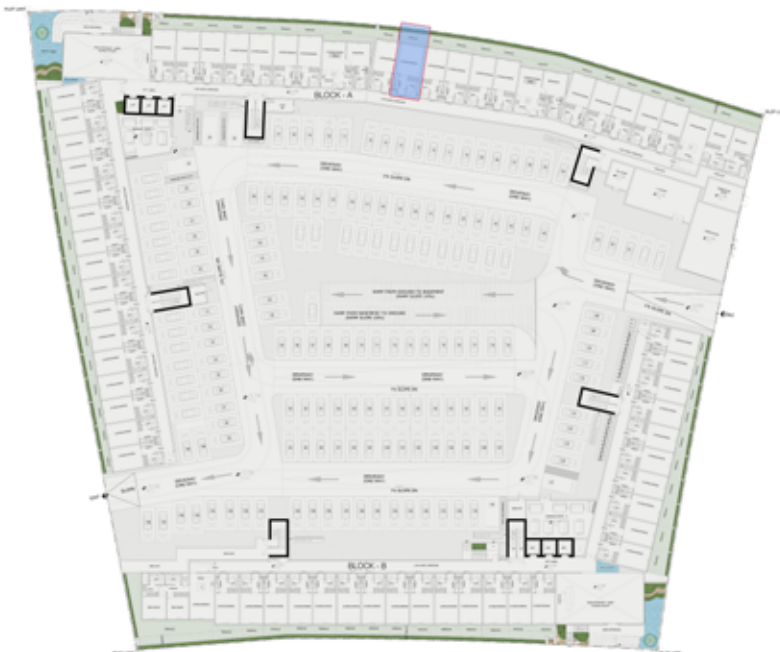

## STUDIO

LEVEL : GROUND FLOOR

UNIT NO : AG26

SUITE AREA : 347 Sq.ft

BALCONY AREA : 80 Sq.ft

TOTAL AREA : 427 Sq.ft

Disclaimer: all pictures, plans, layouts, information, data and details included in this brochure are indicative only and may change at any time up to the final 'as built' status in accordance with the final designs of the project, regulatory approvals and planning permissions.



UNIT - AG27



## STUDIO

LEVEL : GROUND FLOOR	
UNIT NO : AG27	
SUITE AREA :	347 Sq.ft
BALCONY AREA :	86 Sq.ft
TOTAL AREA :	433 Sq.ft

Disclaimer: all pictures, plans, layouts, information, data and details included in this brochure are indicative only and may change at any time up to the final 'as built' status in accordance with the final designs of the project, regulatory approvals and planning permissions.



UNIT - AG28



## STUDIO

LEVEL : GROUND FLOOR	
UNIT NO : AG28	
SUITE AREA :	347 Sq.ft
BALCONY AREA :	88 Sq.ft
TOTAL AREA :	435 Sq.ft

Disclaimer: all pictures, plans, layouts, information, data and details included in this brochure are indicative only and may change at any time up to the final 'as built' status in accordance with the final designs of the project, regulatory approvals and planning permissions.



UNIT - AG29



## STUDIO

LEVEL : GROUND FLOOR	
UNIT NO : AG29	
SUITE AREA :	347 Sq.ft
BALCONY AREA :	89 Sq.ft
TOTAL AREA :	436 Sq.ft

Disclaimer: all pictures, plans, layouts, information, data and details included in this brochure are indicative only and may change at any time up to the final 'as built' status in accordance with the final designs of the project, regulatory approvals and planning permissions.





UNIT - AG30

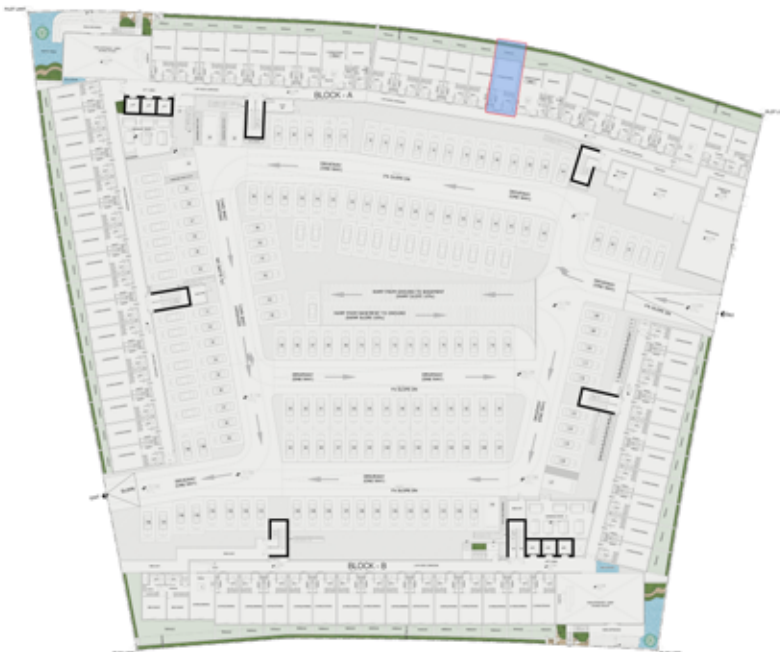

## STUDIO

LEVEL : GROUND FLOOR

UNIT NO : AG30

SUITE AREA : 347 Sq.ft

BALCONY AREA : 86 Sq.ft

TOTAL AREA : 433 Sq.ft

Disclaimer: all pictures, plans, layouts, information, data and details included in this brochure are indicative only and may change at any time up to the final 'as built' status in accordance with the final designs of the project, regulatory approvals and planning permissions.

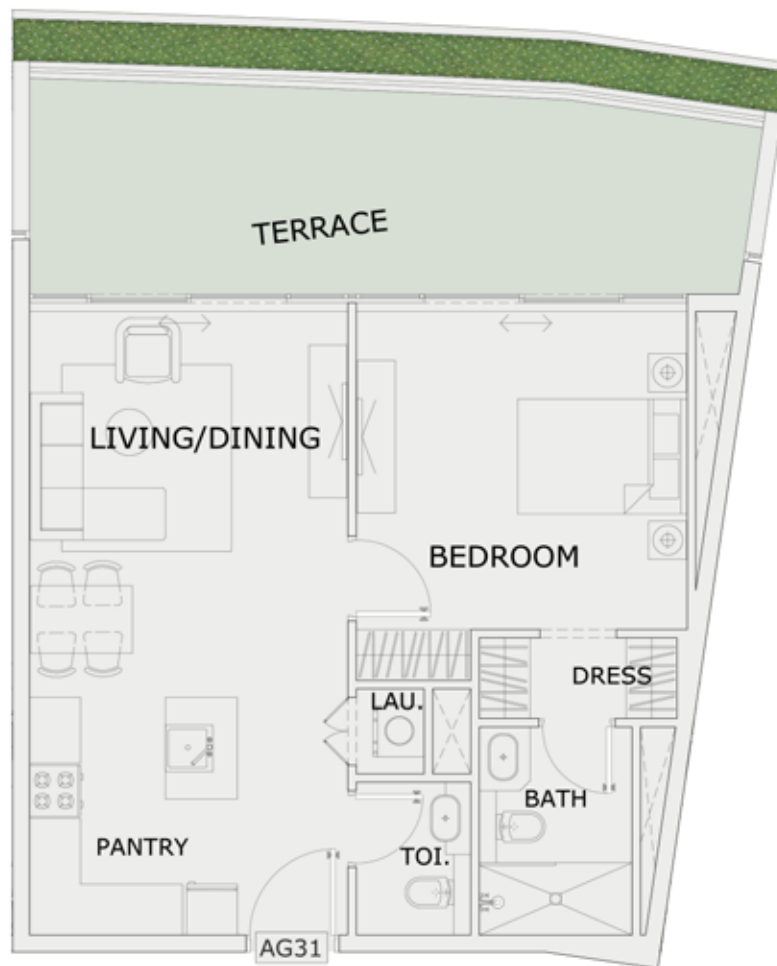

UNIT - AG31

1 BHK

LEVEL : GROUND FLOOR	
UNIT NO : AG31	
SUITE AREA :	616 Sq.ft
BALCONY AREA :	239 Sq.ft
TOTAL AREA :	855 Sq.ft



Disclaimer: all pictures, plans, layouts, information, data and details included in this brochure are indicative only and may change at any time up to the final 'as built' status in accordance with the final designs of the project, regulatory approvals and planning permissions.



UNIT - AG32



## STUDIO

LEVEL : GROUND FLOOR	
UNIT NO : AG32	
SUITE AREA :	347 Sq.ft
BALCONY AREA :	71 Sq.ft
TOTAL AREA :	418 Sq.ft

Disclaimer: all pictures, plans, layouts, information, data and details included in this brochure are indicative only and may change at any time up to the final 'as built' status in accordance with the final designs of the project, regulatory approvals and planning permissions.



UNIT - AG33



## STUDIO

LEVEL : GROUND FLOOR	
UNIT NO : AG33	
SUITE AREA :	347 Sq.ft
BALCONY AREA :	71 Sq.ft
TOTAL AREA :	418 Sq.ft

Disclaimer: all pictures, plans, layouts, information, data and details included in this brochure are indicative only and may change at any time up to the final 'as built' status in accordance with the final designs of the project, regulatory approvals and planning permissions.



UNIT - AG34



## STUDIO

LEVEL : GROUND FLOOR

UNIT NO : AG34

SUITE AREA : 347 Sq.ft

BALCONY AREA : 71 Sq.ft

TOTAL AREA : 418 Sq.ft

Disclaimer: all pictures, plans, layouts, information, data and details included in this brochure are indicative only and may change at any time up to the final 'as built' status in accordance with the final designs of the project, regulatory approvals and planning permissions.





UNIT - AG35



## STUDIO

LEVEL : GROUND FLOOR	
UNIT NO : AG35	
SUITE AREA :	347 Sq.ft
BALCONY AREA :	72 Sq.ft
TOTAL AREA :	419 Sq.ft

Disclaimer: all pictures, plans, layouts, information, data and details included in this brochure are indicative only and may change at any time up to the final 'as built' status in accordance with the final designs of the project, regulatory approvals and planning permissions.



UNIT - AG36



## STUDIO

LEVEL : GROUND FLOOR	
UNIT NO : AG36	
SUITE AREA :	347 Sq.ft
BALCONY AREA :	72 Sq.ft
TOTAL AREA :	419 Sq.ft

Disclaimer: all pictures, plans, layouts, information, data and details included in this brochure are indicative only and may change at any time up to the final 'as built' status in accordance with the final designs of the project, regulatory approvals and planning permissions.



UNIT - AG37



2 BHK

LEVEL : GROUND FLOOR	
UNIT NO : AG37	
SUITE AREA :	1019 Sq.ft
BALCONY AREA :	305 Sq.ft
TOTAL AREA :	1324 Sq.ft

Disclaimer: all pictures, plans, layouts, information, data and details included in this brochure are indicative only and may change at any time up to the final 'as built' status in accordance with the final designs of the project, regulatory approvals and planning permissions.

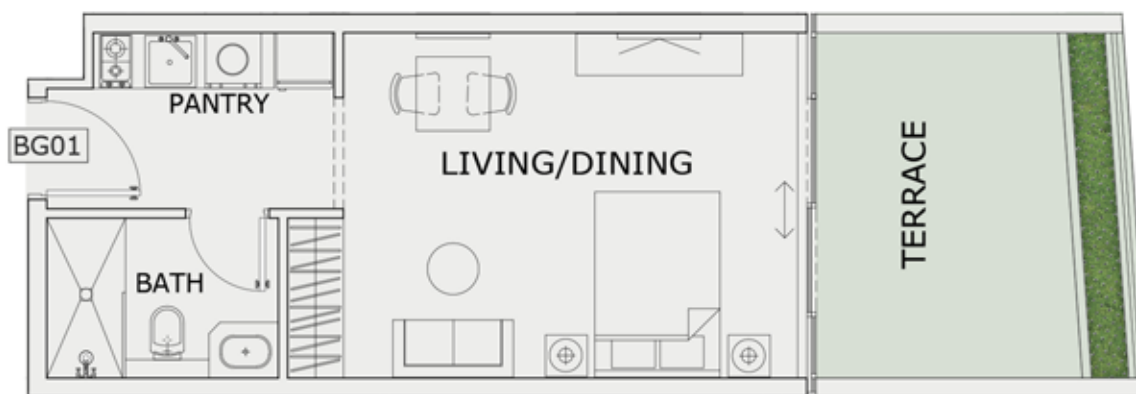

UNIT - BG01

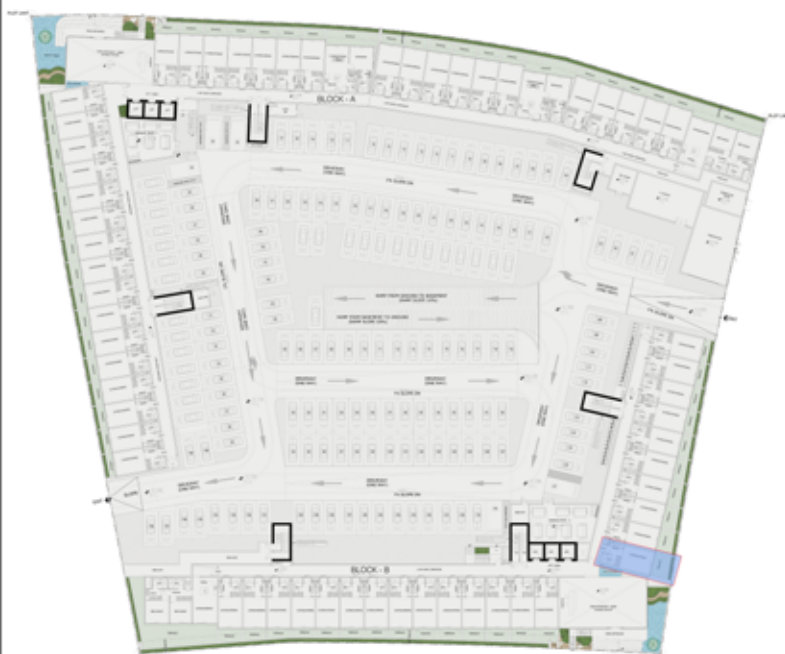

## STUDIO

LEVEL : GROUND FLOOR

UNIT NO : BG01

SUITE AREA : 347 Sq.ft

BALCONY AREA : 145 Sq.ft

TOTAL AREA : 492 Sq.ft

Disclaimer: all pictures, plans, layouts, information, data and details included in this brochure are indicative only and may change at any time up to the final 'as built' status in accordance with the final designs of the project, regulatory approvals and planning permissions.

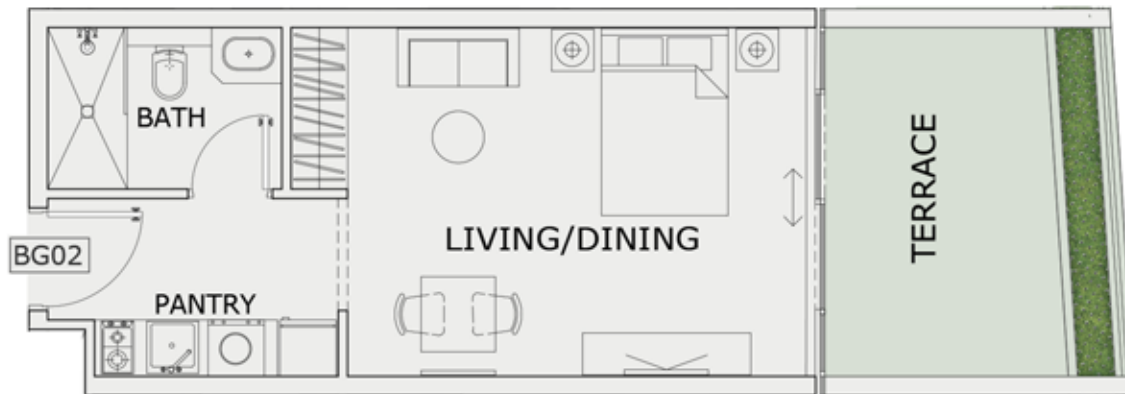

UNIT - BG02



STUDIO

LEVEL : GROUND FLOOR	
UNIT NO : BG02	
SUITE AREA :	347 Sq.ft
BALCONY AREA :	134 Sq.ft
TOTAL AREA :	481 Sq.ft

Disclaimer: all pictures, plans, layouts, information, data and details included in this brochure are indicative only and may change at any time up to the final 'as built' status in accordance with the final designs of the project, regulatory approvals and planning permissions.



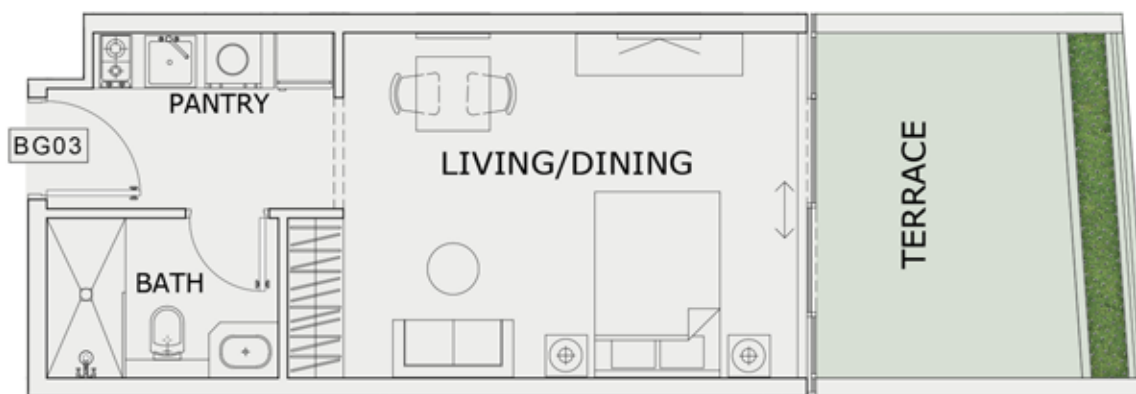

UNIT - BG03



## STUDIO

LEVEL : GROUND FLOOR

UNIT NO : BG03

SUITE AREA : 347 Sq.ft

BALCONY AREA : 124 Sq.ft

TOTAL AREA : 471 Sq.ft

Disclaimer: all pictures, plans, layouts, information, data and details included in this brochure are indicative only and may change at any time up to the final 'as built' status in accordance with the final designs of the project, regulatory approvals and planning permissions.

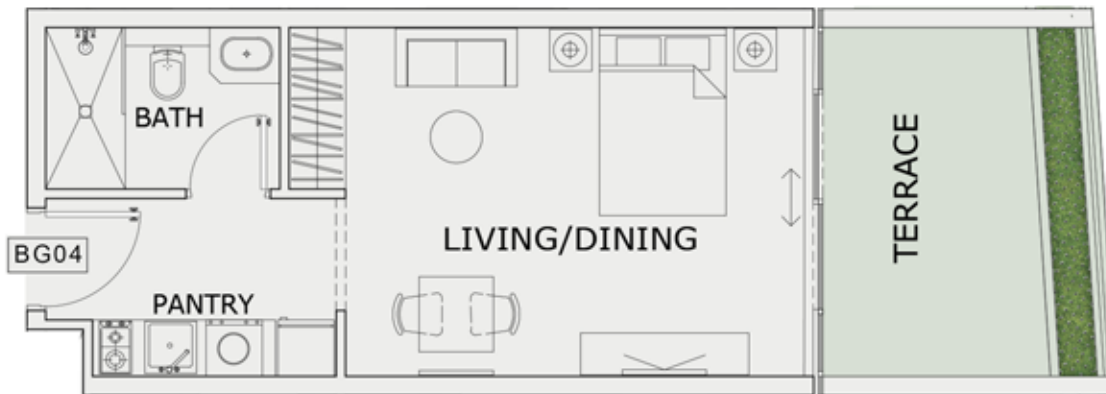

UNIT - BG04

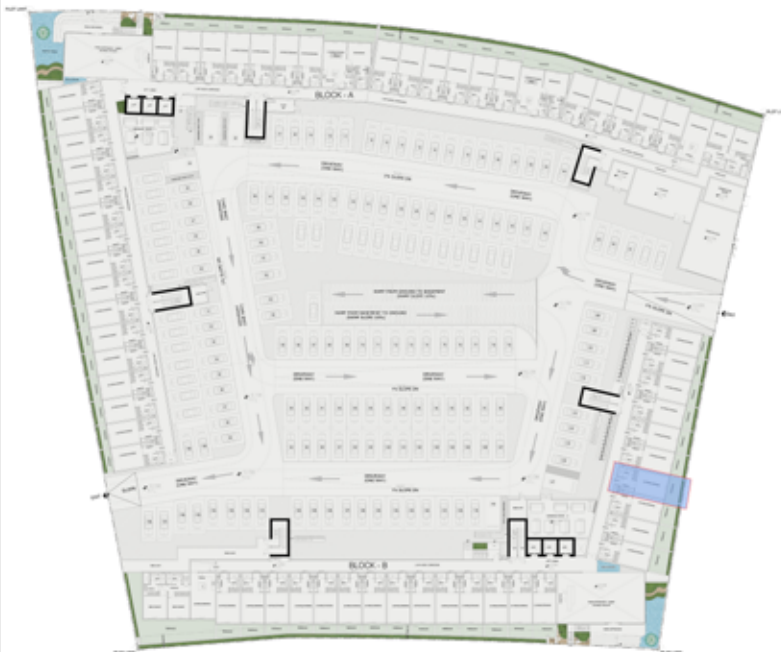

STUDIO

LEVEL : GROUND FLOOR	
UNIT NO : BG04	
SUITE AREA :	347 Sq.ft
BALCONY AREA :	114 Sq.ft
TOTAL AREA :	461 Sq.ft

Disclaimer: all pictures, plans, layouts, information, data and details included in this brochure are indicative only and may change at any time up to the final 'as built' status in accordance with the final designs of the project, regulatory approvals and planning permissions.

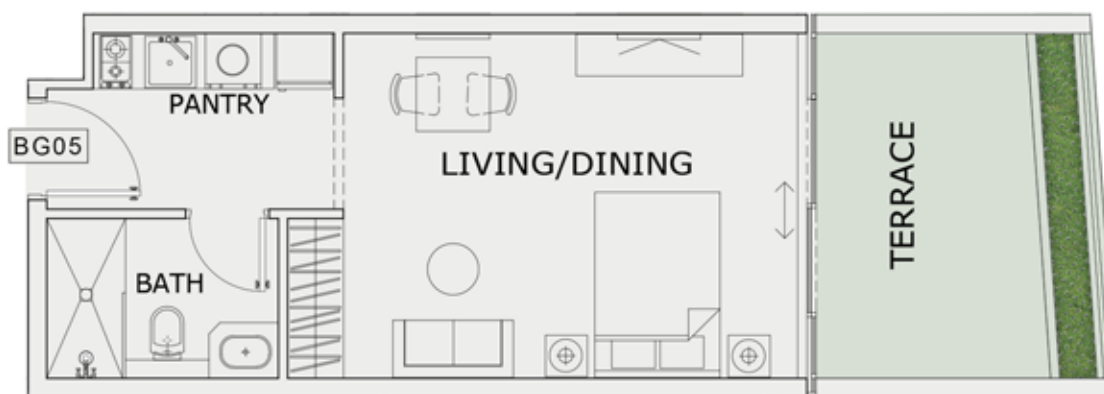

UNIT - BG05



## STUDIO

LEVEL : GROUND FLOOR

UNIT NO : BG05

SUITE AREA : 347 Sq.ft

BALCONY AREA : 105 Sq.ft

TOTAL AREA : 452 Sq.ft

Disclaimer: all pictures, plans, layouts, information, data and details included in this brochure are indicative only and may change at any time up to the final 'as built' status in accordance with the final designs of the project, regulatory approvals and planning permissions.

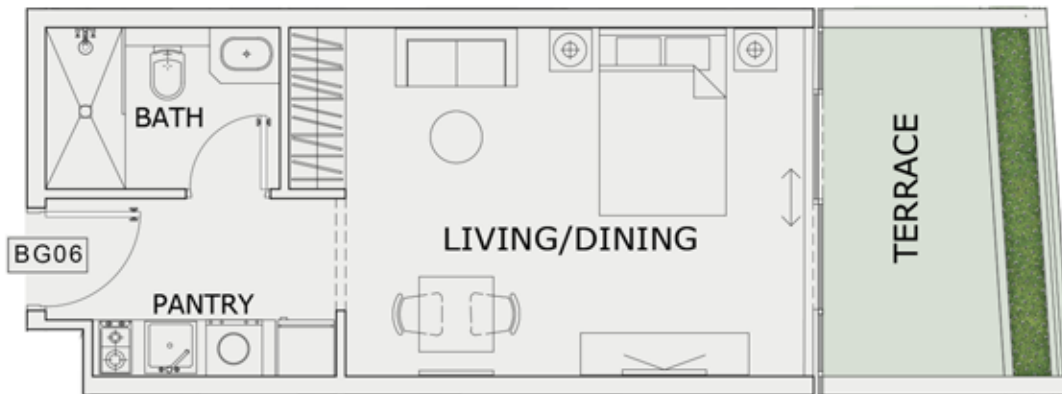

UNIT - BG06



STUDIO

LEVEL : GROUND FLOOR	
UNIT NO : BG06	
SUITE AREA :	347 Sq.ft
BALCONY AREA :	97 Sq.ft
TOTAL AREA :	444 Sq.ft

Disclaimer: all pictures, plans, layouts, information, data and details included in this brochure are indicative only and may change at any time up to the final 'as built' status in accordance with the final designs of the project, regulatory approvals and planning permissions.

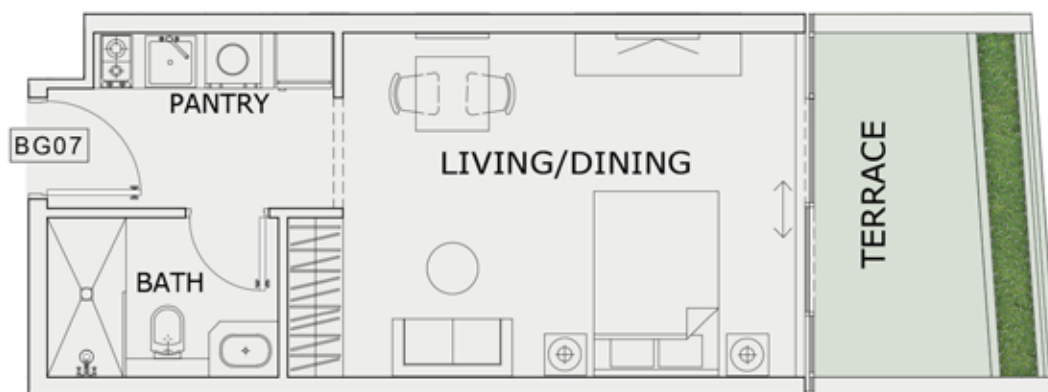

UNIT - BG07



## STUDIO

LEVEL : GROUND FLOOR

UNIT NO : BG07

SUITE AREA : 347 Sq.ft

BALCONY AREA : 90 Sq.ft

TOTAL AREA : 437 Sq.ft

Disclaimer: all pictures, plans, layouts, information, data and details included in this brochure are indicative only and may change at any time up to the final 'as built' status in accordance with the final designs of the project, regulatory approvals and planning permissions.



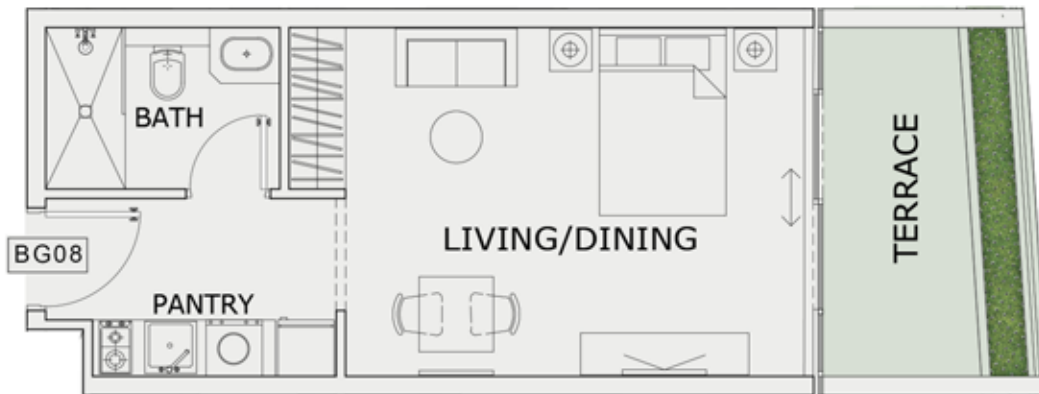

UNIT - BG08



STUDIO

LEVEL : GROUND FLOOR	
UNIT NO : BG08	
SUITE AREA :	347 Sq.ft
BALCONY AREA :	83 Sq.ft
TOTAL AREA :	430 Sq.ft

Disclaimer: all pictures, plans, layouts, information, data and details included in this brochure are indicative only and may change at any time up to the final 'as built' status in accordance with the final designs of the project, regulatory approvals and planning permissions.

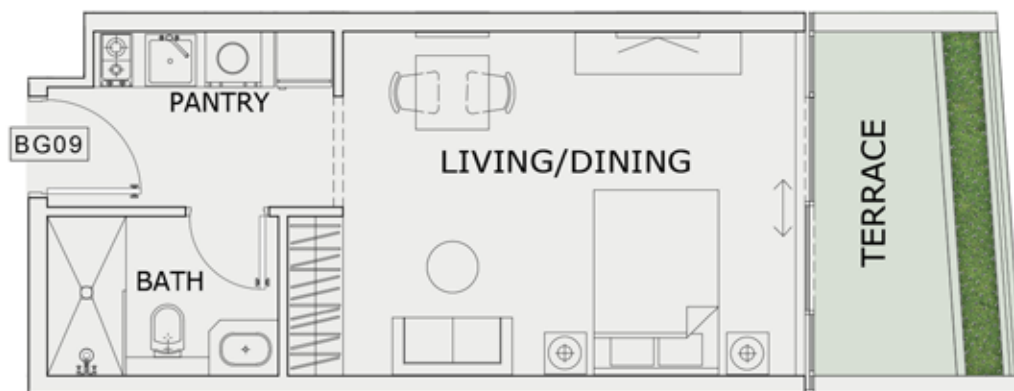

UNIT - BG09



## STUDIO

LEVEL : GROUND FLOOR

UNIT NO : BG09

SUITE AREA : 347 Sq.ft

BALCONY AREA : 77 Sq.ft

TOTAL AREA : 424 Sq.ft

Disclaimer: all pictures, plans, layouts, information, data and details included in this brochure are indicative only and may change at any time up to the final 'as built' status in accordance with the final designs of the project, regulatory approvals and planning permissions.

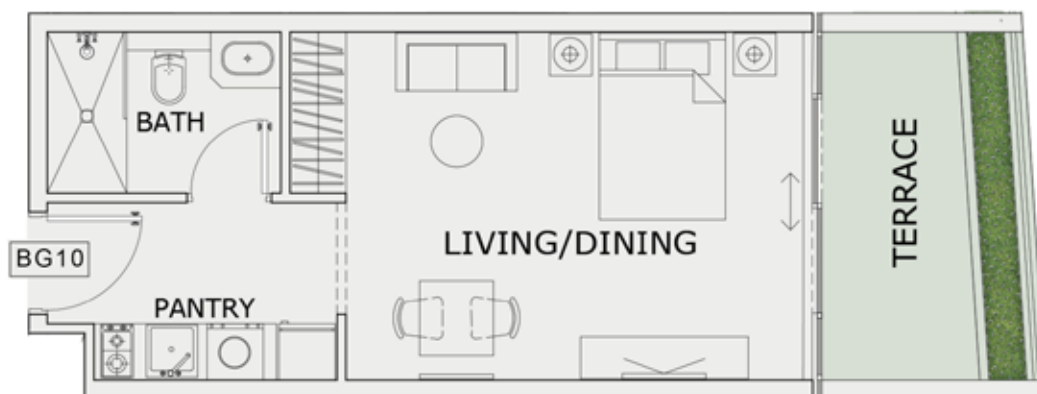

UNIT - BG10



STUDIO

LEVEL : GROUND FLOOR	
UNIT NO : BG10	
SUITE AREA :	347 Sq.ft
BALCONY AREA :	72 Sq.ft
TOTAL AREA :	419 Sq.ft

Disclaimer: all pictures, plans, layouts, information, data and details included in this brochure are indicative only and may change at any time up to the final 'as built' status in accordance with the final designs of the project, regulatory approvals and planning permissions.



UNIT - BG11

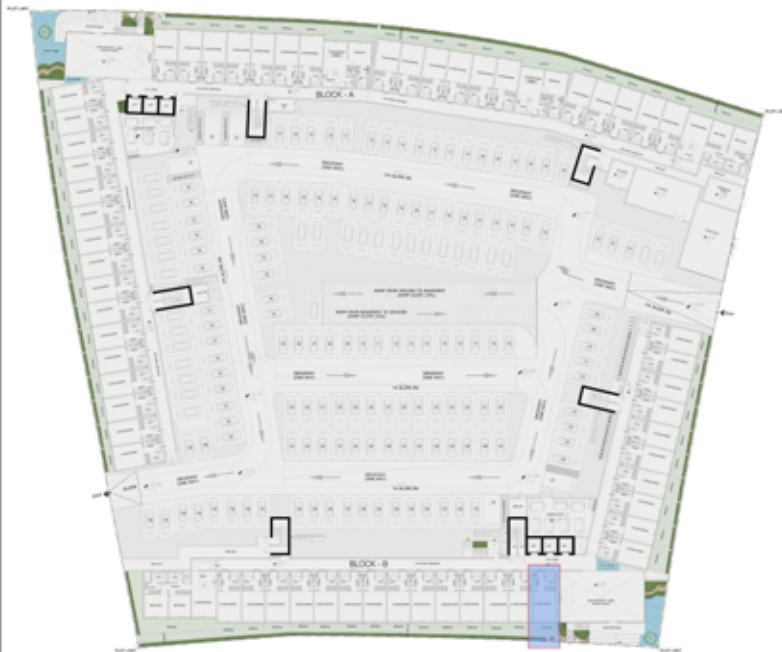

## STUDIO

LEVEL : GROUND FLOOR

UNIT NO : BG11

SUITE AREA : 347 Sq.ft

BALCONY AREA : 100 Sq.ft

TOTAL AREA : 447 Sq.ft

Disclaimer: all pictures, plans, layouts, information, data and details included in this brochure are indicative only and may change at any time up to the final 'as built' status in accordance with the final designs of the project, regulatory approvals and planning permissions.



UNIT - BG12



## STUDIO

LEVEL : GROUND FLOOR

UNIT NO : BG12

SUITE AREA : 347 Sq.ft

BALCONY AREA : 97 Sq.ft

TOTAL AREA : 444 Sq.ft

Disclaimer: all pictures, plans, layouts, information, data and details included in this brochure are indicative only and may change at any time up to the final 'as built' status in accordance with the final designs of the project, regulatory approvals and planning permissions.





UNIT - BG13

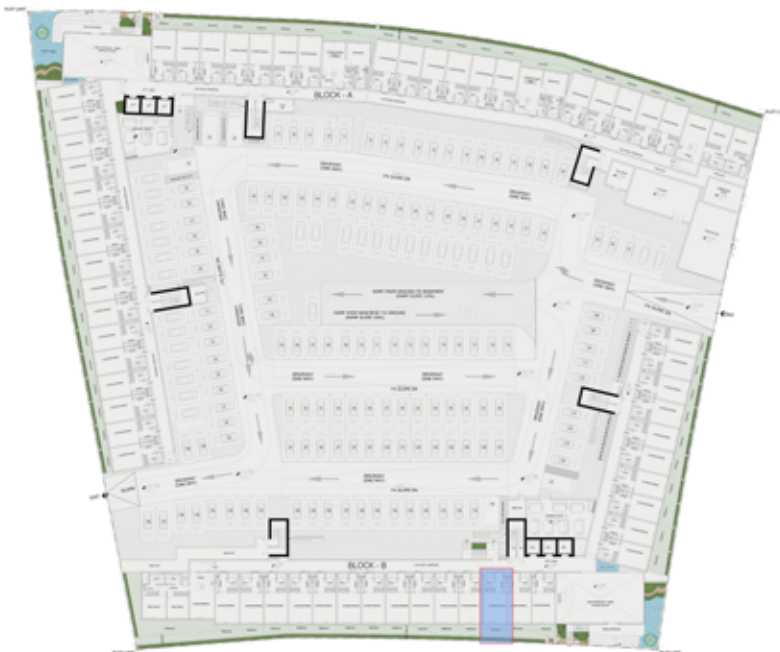

## STUDIO

LEVEL : GROUND FLOOR

UNIT NO : BG13

SUITE AREA : 347 Sq.ft

BALCONY AREA : 91 Sq.ft

TOTAL AREA : 438 Sq.ft

Disclaimer: all pictures, plans, layouts, information, data and details included in this brochure are indicative only and may change at any time up to the final 'as built' status in accordance with the final designs of the project, regulatory approvals and planning permissions.



UNIT - BG14

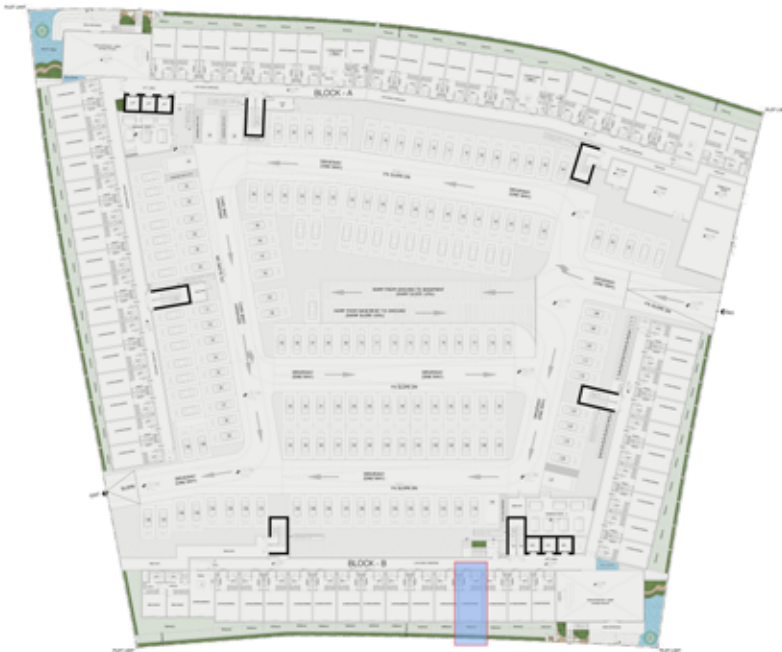

## STUDIO

LEVEL : GROUND FLOOR

UNIT NO : BG14

SUITE AREA : 347 Sq.ft

BALCONY AREA : 85 Sq.ft

TOTAL AREA : 432 Sq.ft

Disclaimer: all pictures, plans, layouts, information, data and details included in this brochure are indicative only and may change at any time up to the final 'as built' status in accordance with the final designs of the project, regulatory approvals and planning permissions.



UNIT - BG15

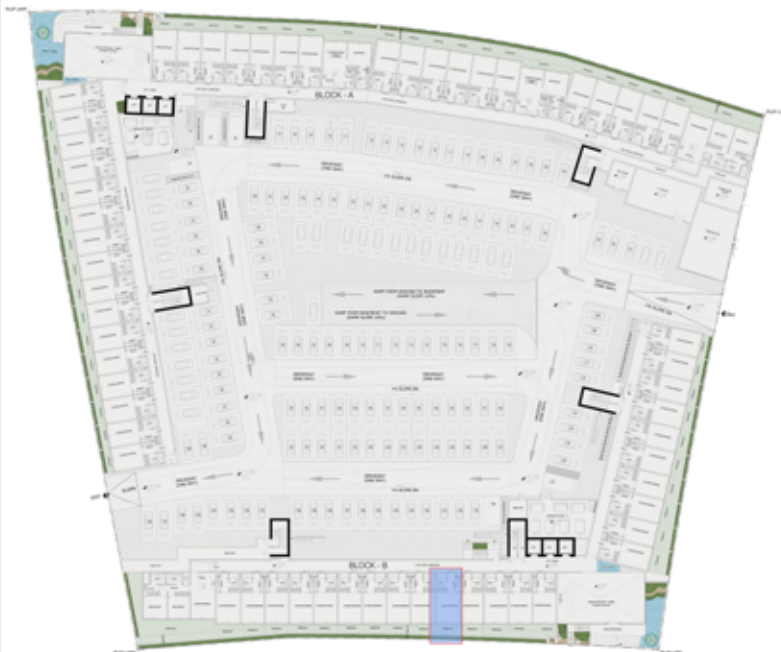

## STUDIO

LEVEL : GROUND FLOOR

UNIT NO : BG15

SUITE AREA : 347 Sq.ft

BALCONY AREA : 81 Sq.ft

TOTAL AREA : 428 Sq.ft

Disclaimer: all pictures, plans, layouts, information, data and details included in this brochure are indicative only and may change at any time up to the final 'as built' status in accordance with the final designs of the project, regulatory approvals and planning permissions.



UNIT - BG16

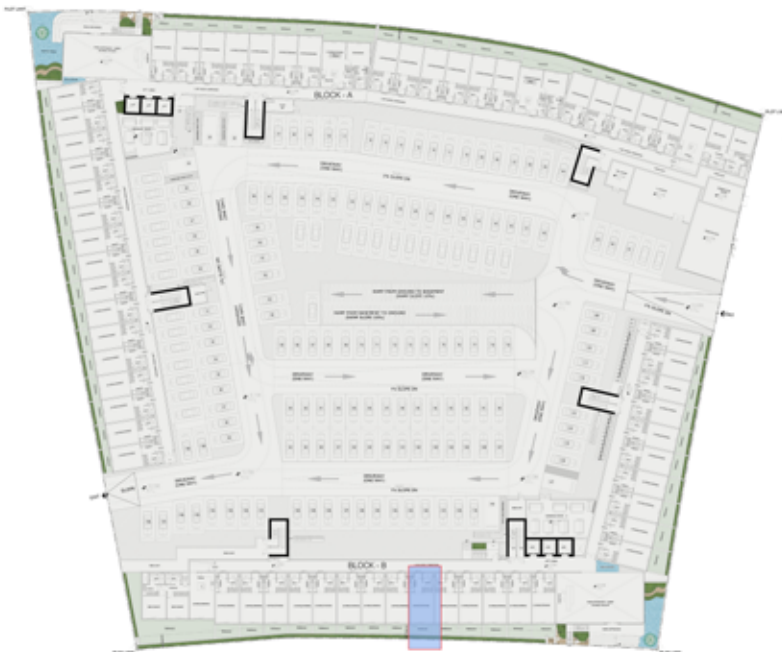

## STUDIO

LEVEL : GROUND FLOOR	
UNIT NO : BG16	
SUITE AREA :	347 Sq.ft
BALCONY AREA :	76 Sq.ft
TOTAL AREA :	423 Sq.ft

Disclaimer: all pictures, plans, layouts, information, data and details included in this brochure are indicative only and may change at any time up to the final 'as built' status in accordance with the final designs of the project, regulatory approvals and planning permissions.



UNIT - BG17

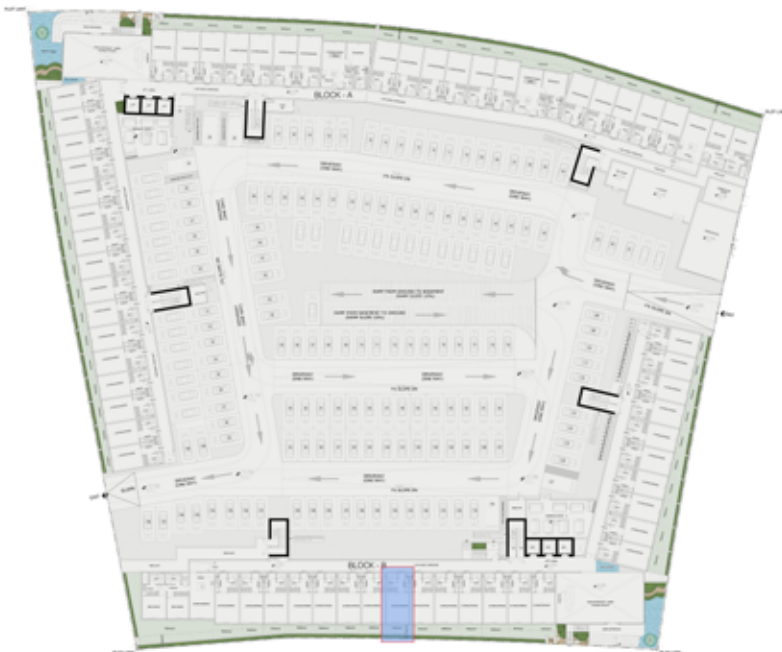

## STUDIO

LEVEL : GROUND FLOOR	
UNIT NO : BG17	
SUITE AREA :	347 Sq.ft
BALCONY AREA :	73 Sq.ft
TOTAL AREA :	420 Sq.ft

Disclaimer: all pictures, plans, layouts, information, data and details included in this brochure are indicative only and may change at any time up to the final 'as built' status in accordance with the final designs of the project, regulatory approvals and planning permissions.





UNIT - BG18

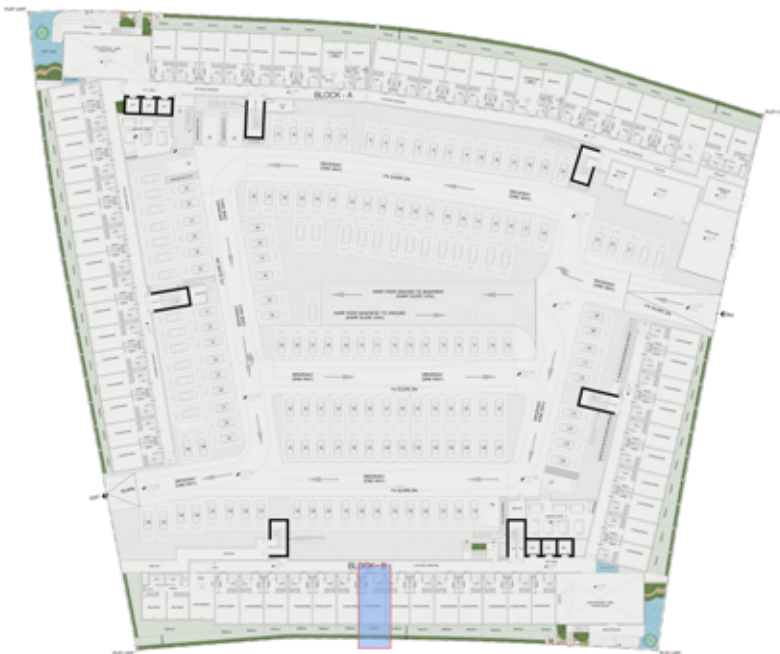

## STUDIO

LEVEL : GROUND FLOOR	
UNIT NO : BG18	
SUITE AREA :	347 Sq.ft
BALCONY AREA :	70 Sq.ft
TOTAL AREA :	417 Sq.ft

Disclaimer: all pictures, plans, layouts, information, data and details included in this brochure are indicative only and may change at any time up to the final 'as built' status in accordance with the final designs of the project, regulatory approvals and planning permissions.



UNIT - BG19



## STUDIO

LEVEL : GROUND FLOOR	
UNIT NO : BG19	
SUITE AREA :	347 Sq.ft
BALCONY AREA :	68 Sq.ft
TOTAL AREA :	415 Sq.ft

Disclaimer: all pictures, plans, layouts, information, data and details included in this brochure are indicative only and may change at any time up to the final 'as built' status in accordance with the final designs of the project, regulatory approvals and planning permissions.



UNIT - BG20

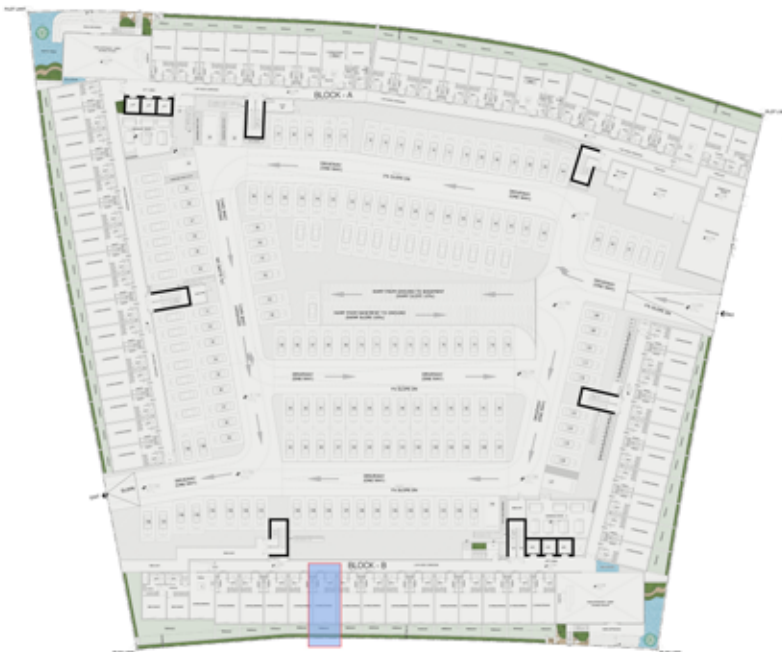

## STUDIO

LEVEL : GROUND FLOOR	
UNIT NO : BG20	
SUITE AREA :	347 Sq.ft
BALCONY AREA :	67 Sq.ft
TOTAL AREA :	414 Sq.ft

Disclaimer: all pictures, plans, layouts, information, data and details included in this brochure are indicative only and may change at any time up to the final 'as built' status in accordance with the final designs of the project, regulatory approvals and planning permissions.

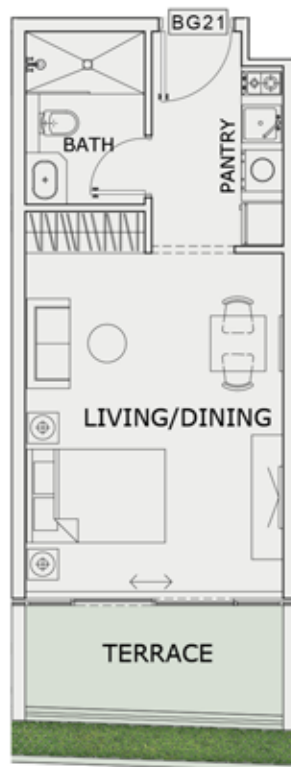

UNIT - BG21

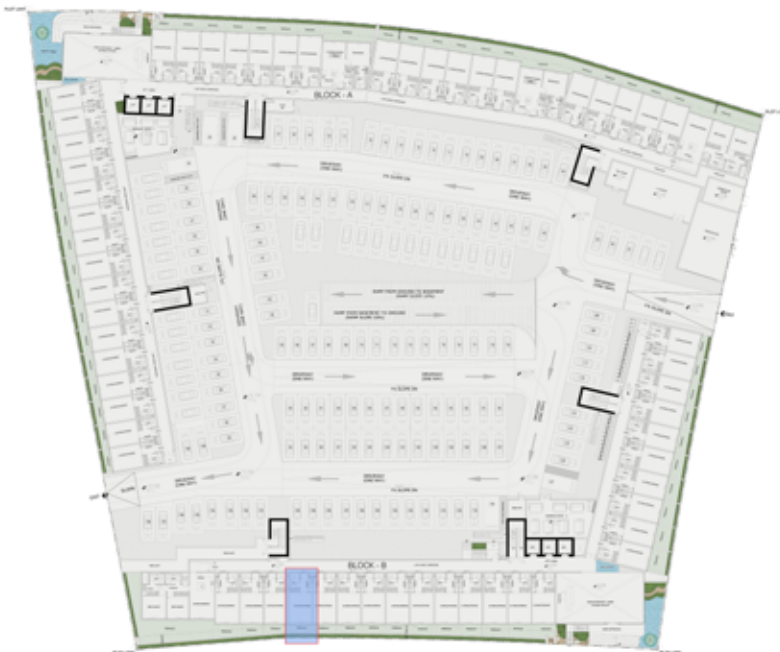

## STUDIO

LEVEL : GROUND FLOOR

UNIT NO : BG21

SUITE AREA :	347 Sq.ft
--------------	-----------

BALCONY AREA :	67 Sq.ft
----------------	----------

TOTAL AREA :	414 Sq.ft
--------------	-----------

Disclaimer: all pictures, plans, layouts, information, data and details included in this brochure are indicative only and may change at any time up to the final 'as built' status in accordance with the final designs of the project, regulatory approvals and planning permissions.

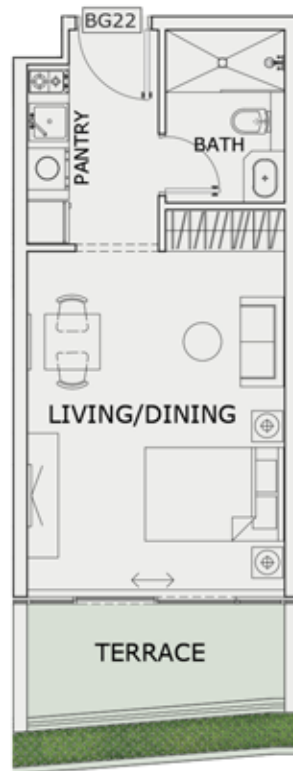

UNIT - BG22



## STUDIO

LEVEL : GROUND FLOOR	
UNIT NO : BG22	
SUITE AREA :	347 Sq.ft
BALCONY AREA :	72 Sq.ft
TOTAL AREA :	419 Sq.ft

Disclaimer: all pictures, plans, layouts, information, data and details included in this brochure are indicative only and may change at any time up to the final 'as built' status in accordance with the final designs of the project, regulatory approvals and planning permissions.





UNIT - BG23



## STUDIO

LEVEL : GROUND FLOOR

UNIT NO : BG23

SUITE AREA : 347 Sq.ft

BALCONY AREA : 85 Sq.ft

TOTAL AREA : 432 Sq.ft

Disclaimer: all pictures, plans, layouts, information, data and details included in this brochure are indicative only and may change at any time up to the final 'as built' status in accordance with the final designs of the project, regulatory approvals and planning permissions.



UNIT - BG24

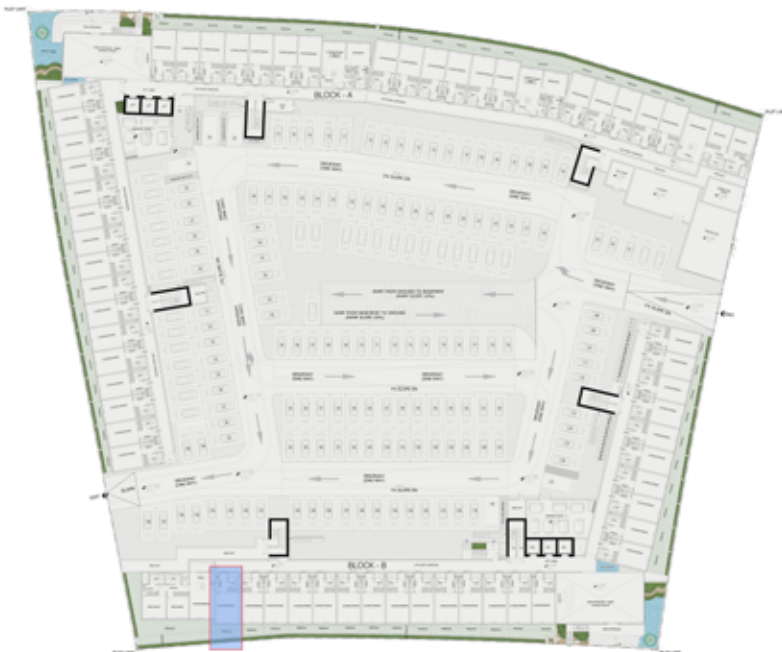

## STUDIO

LEVEL : GROUND FLOOR	
UNIT NO : BG24	
SUITE AREA :	347 Sq.ft
BALCONY AREA :	98 Sq.ft
TOTAL AREA :	445 Sq.ft

Disclaimer: all pictures, plans, layouts, information, data and details included in this brochure are indicative only and may change at any time up to the final 'as built' status in accordance with the final designs of the project, regulatory approvals and planning permissions.

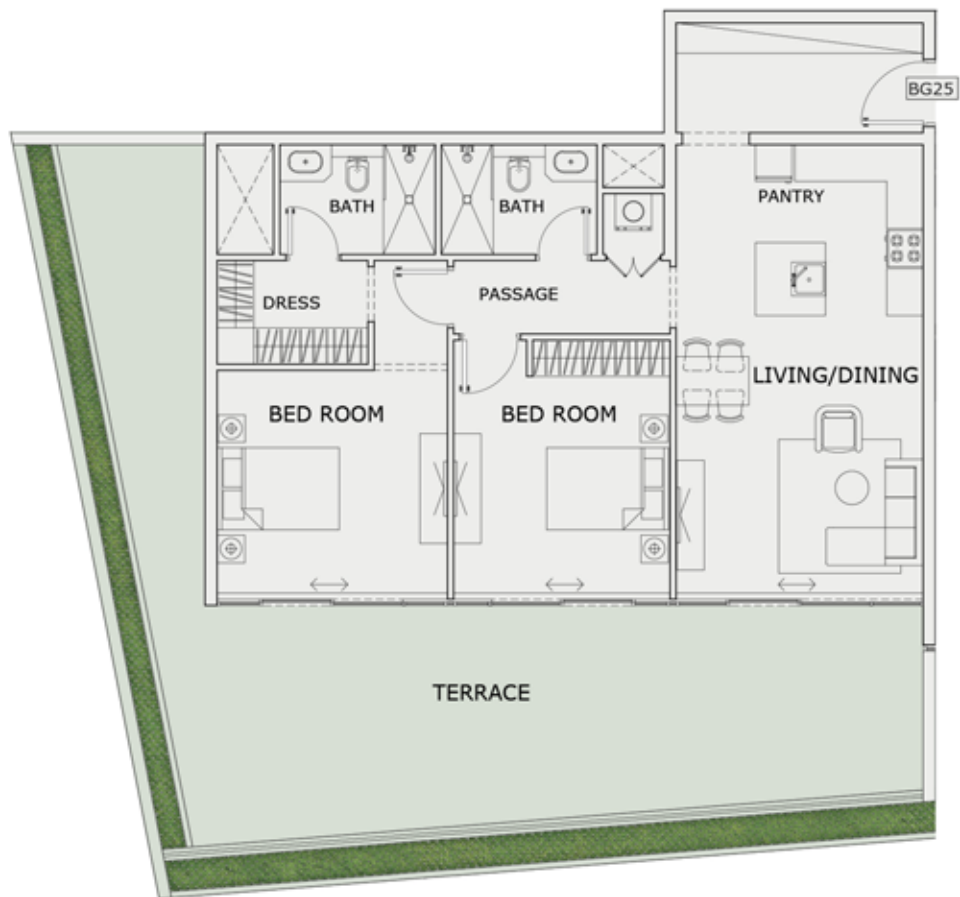

UNIT - BG25

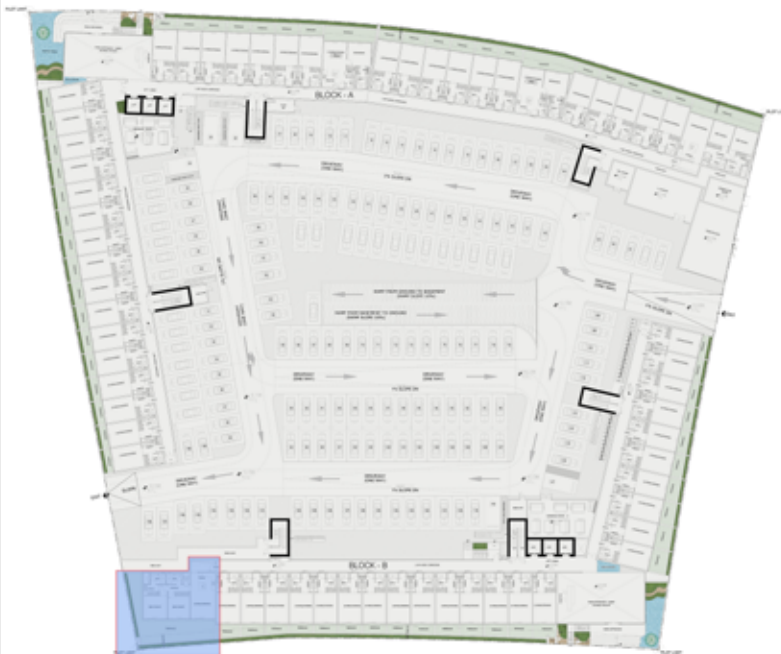

2 BHK

LEVEL : GROUND FLOOR	
UNIT NO : BG25	
SUITE AREA :	1015 Sq.ft
BALCONY AREA :	723 Sq.ft
TOTAL AREA :	1738 Sq.ft

Disclaimer: all pictures, plans, layouts, information, data and details included in this brochure are indicative only and may change at any time up to the final 'as built' status in accordance with the final designs of the project, regulatory approvals and planning permissions.