

# VELA VIENTO

)( *Dorchester Collection*  
DUBAI

OMNIYAT

*Soon,*  
a timeless vision  
will ascend *in Marasi Bay...*

Embodying the Latin meaning  
for ‘sail’ and ‘wind’,  
VELA VIENTO represents the spirited dance  
of the wind; the invisible force that breathes life  
into sails and carries us ever forward.

A realm  
*above*  
the ordinary



With a bold vision for Marasi Bay,  
OMNIYAT introduces VELA VIENTO,  
ascending to celestial heights of magnificence  
in Burj Khalifa District.

VELA VIENTO builds on the uplifting legacy  
of its sister property, VELA, in a powerfully  
transformative setting of waterfront living  
that shines with boundless possibilities.



*Where land  
and water  
converge  
into a lifestyle  
beyond compare,  
the possibilities  
unfold*

# *Unveiling the future*

At the dawn of Dubai's new luxury district,  
and framing the gateway to Downtown Dubai,  
VELA VIENTO draws the eye towards the future  
of this evolving city.

As a lofty expression of OMNIYAT's vision  
to reshape Marasi Bay into Dubai's foremost,  
ultra-luxury waterfront community,  
VELA VIENTO takes crowning pride  
of place in the dynamic hub of Dubai's new cultural  
scene and offers a life in motion, borne upon the  
song of the wind.

VELA  
VIENTO  
Dorchester Collection  
DUBAI

VELA  
Dorchester Collection  
DUBAI

THE  
LANA  
RESIDENCES, DUBAI  
DORCHESTER COLLECTION



MARASI BAY MARINA  
BY OMNIYAT

*An*  
exceptional  
*location*

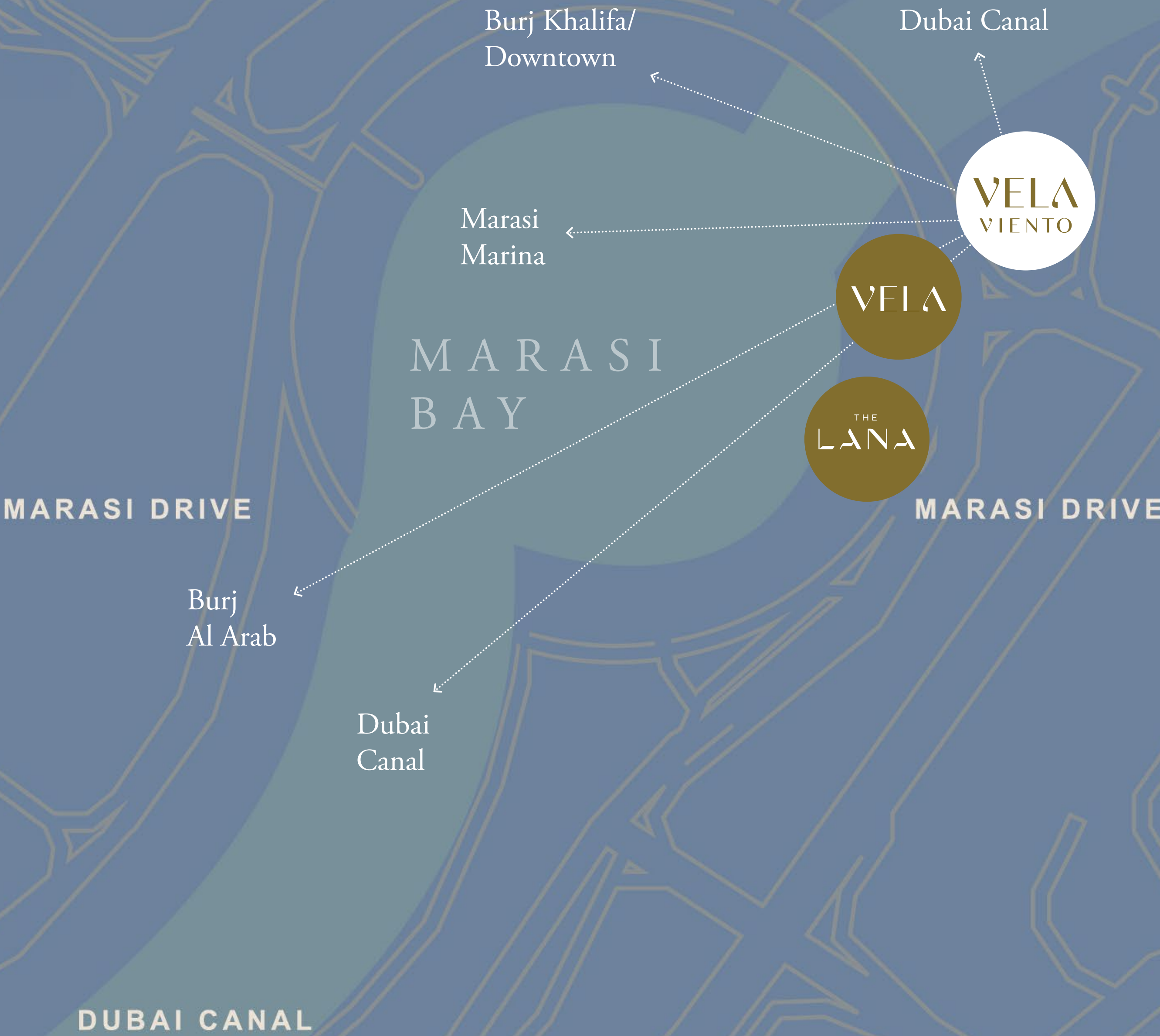

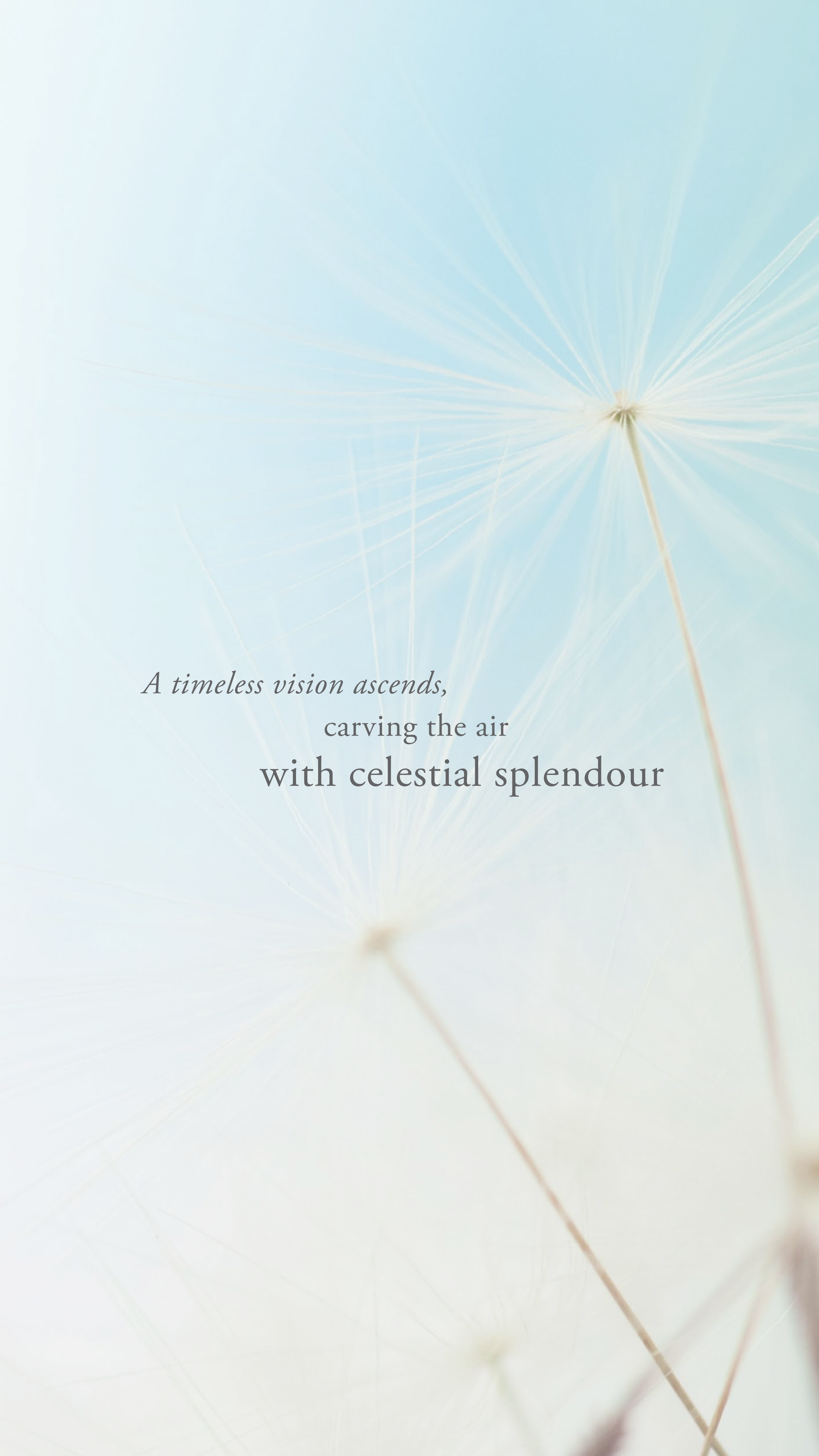
A close-up, low-angle shot of a dandelion seed head against a clear, light blue sky. The seed head is in sharp focus, with its numerous white, feathery seeds radiating outwards. The stem of the dandelion is visible, extending from the bottom right towards the seed head. The background is a soft, out-of-focus blue sky.

*A timeless vision ascends,*  
carving the air  
with celestial splendour

# *Revealing unseen wonders*



Continuing OMNIYAT's commitment to imagining the extraordinary and building it into reality, VELA VIENTO was conceived by the finest designers who push boundaries to create global masterpieces.

Award-winning practice Foster + Partners crafted VELA VIENTO's horizontal lines and smooth curves into a fascinating rhythm that dances across OMNIYAT's properties, from VELA VIENTO and VELA to The Lana and beyond.

Parisian designer duo Gilles & Boissier have once again brought their signature style to an OMNIYAT property in an exquisite illustration of luxury interior design.

# *Architecture by* **Foster + Partners**

Foster + Partners have used space and form with imagination at their heart to bring VELA VIENTO's ethereal beauty to life.

In the design of VELA VIENTO, The power of space is as relevant as the structures around it. Spaces contain multitudes. They reveal the past and the present. They frame the future and fill it with flowing possibilities.

## Portfolio includes

- Apple headquarters, California
- Millau Viaduct, France
- Gherkin tower, London
- VELA, Dorchester Collection, Dubai
- The Lana, Dorchester Collection, Dubai
- ORLA, Dorchester Collection, Dubai

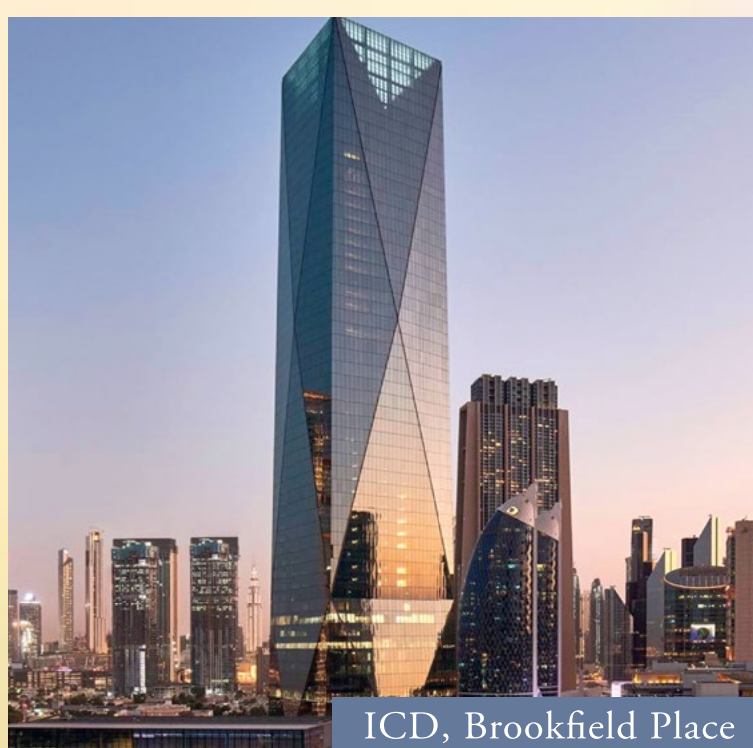
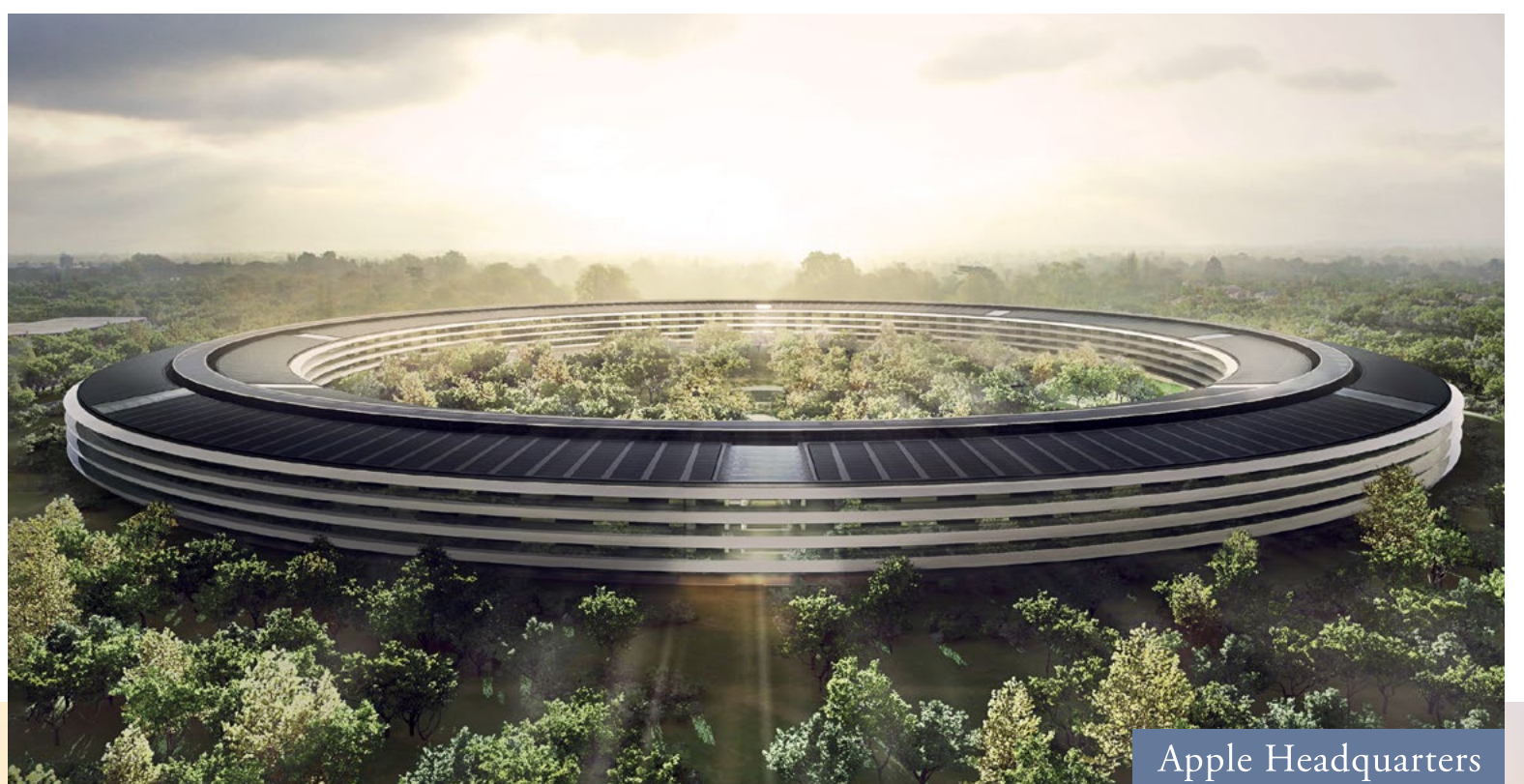

Voids are the soul of VELA VIENTO,  
connecting the interior and exterior realms  
in an interplay of light, shadow, and space.

*They frame the future  
and fill it with possibilities.*



# *Interior Design by* **GILLES & BOISSIER**

Distilling the essence of elegance and singularity into an art form, Gilles & Boissier seamlessly blend modernity with timeless allure in VELA VIENTO's captivating spaces.

The result is a harmonious juxtaposition of contemporary elements and classical features in a design concept that transcends trends and embodies everlasting beauty.

## Portfolio includes

- Mandarin Oriental, Paris
- Mandarin Oriental Ritz, Madrid
- Hakkasan restaurants in Dubai and USA
- The Lana, Dorchester Collection, Dubai
- VELA, Dorchester Collection, Dubai



*A gateway to horizons*  
that transcend and inspire



# *A sublime arrival*

Surrounded by lush landscaping and majestic layers of water, the grand, ramping approach leads you to an elevated lobby. Here, the Burj Khalifa is framed as a perfect view between the airy elevations of VELA VIENTO.

Step into the warm welcome of Dorchester Collection's exceptional care, where your valet and doorman await you.

The double-height entrance lounge, designed by Gilles & Bossier, provides a wonderful first impression and luxurious meeting place for residents and visitors.

Beyond the glass, the views are wonderful in every direction.



*In a shining beacon  
of luxury and sophistication,  
celestial beauty awaits*

*An alchemy of  
beauty  
and possibility*



The 92 residences range from two to four-bedroom apartments and are crowned by two extraordinary penthouses.

The residences exemplify the delights of indoor-outdoor living, with select residences boasting private terrace pools and double-height spaces. Generous proportions create an ambiance of vastness, ideal for relaxation, entertainment, and savoring the panoramic views of Marasi Bay, Burj Khalifa and Downtown Dubai.



Generous proportions create an ambiance of vastness,  
ideal for relaxation, entertainment, and savoring  
the panoramic views of Marasi Bay, Burj Khalifa  
and Downtown Dubai.



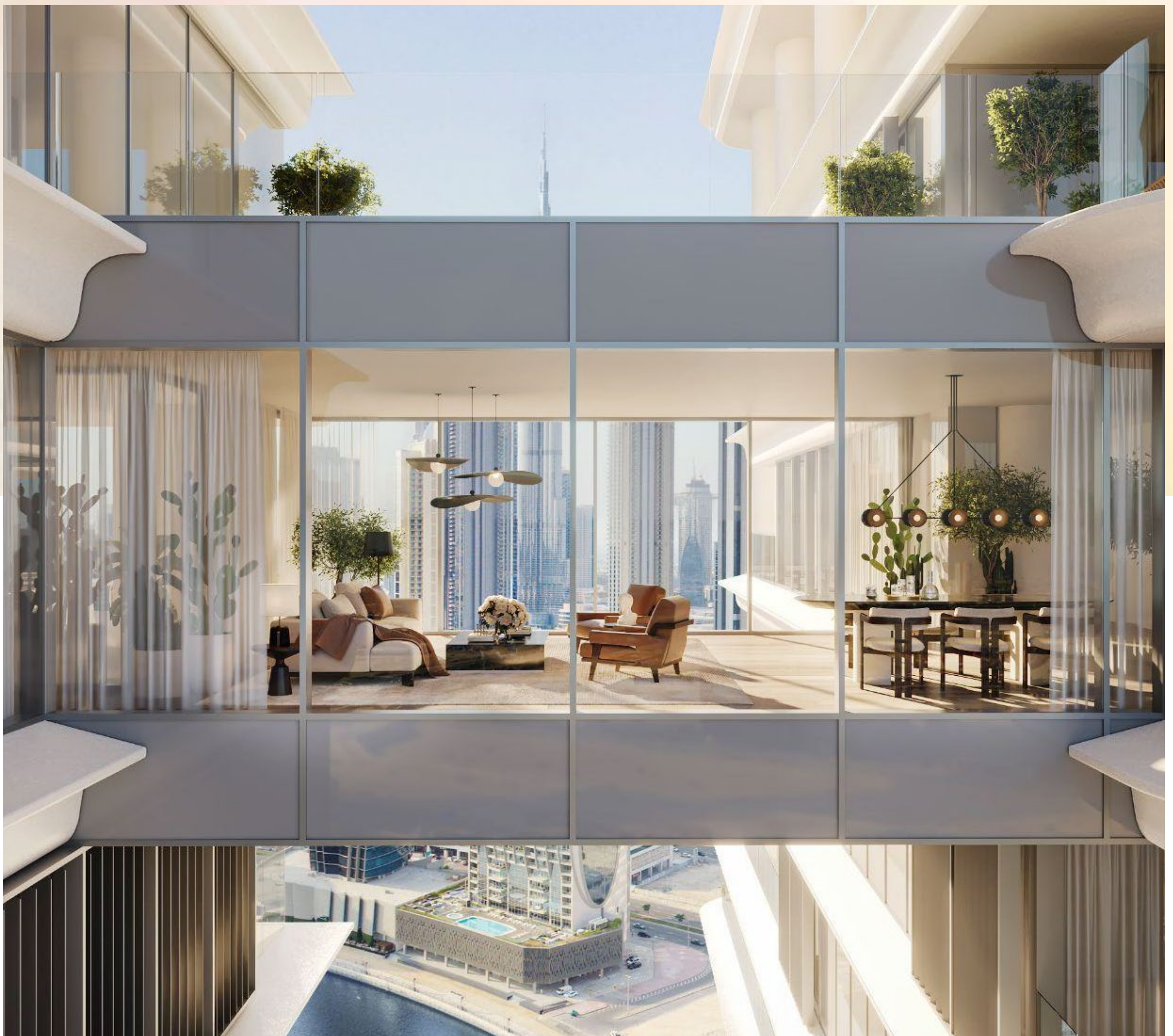

The spaces and bridges between the towers form 'hanging' dining rooms - an outstanding feature of three unique residences that turn a daily experience into a transcendent moment that blurs glass with sky, the earthly with the celestial.

# VELA VIENTO

## *Residences*

- 92 Exquisite residences
- Fully-furnished and designed by Gilles & Boissier
- Glorious terraces and floor-to-ceiling windows
- Select residences enjoy private pools and double-height spaces
- Panoramic views of Marasi Bay, Downtown Dubai and Burj Khalifa

### Celestial Penthouses

- 4 Bedroom - 13,100 to 14,413 sq. ft.

### Horizon Residences

- 4 Bedroom – 6,200 to 9,569 sq. ft.
- 3 bedroom – 4,273 sq. ft.

### Viento Residences

- 4 Bedroom – 5,403 to 10,032 sq. ft.
- 3 Bedroom – 4,101 to 5,511 sq. ft.
- 2 Bedroom – 2,852 to 5,134 sq. ft.

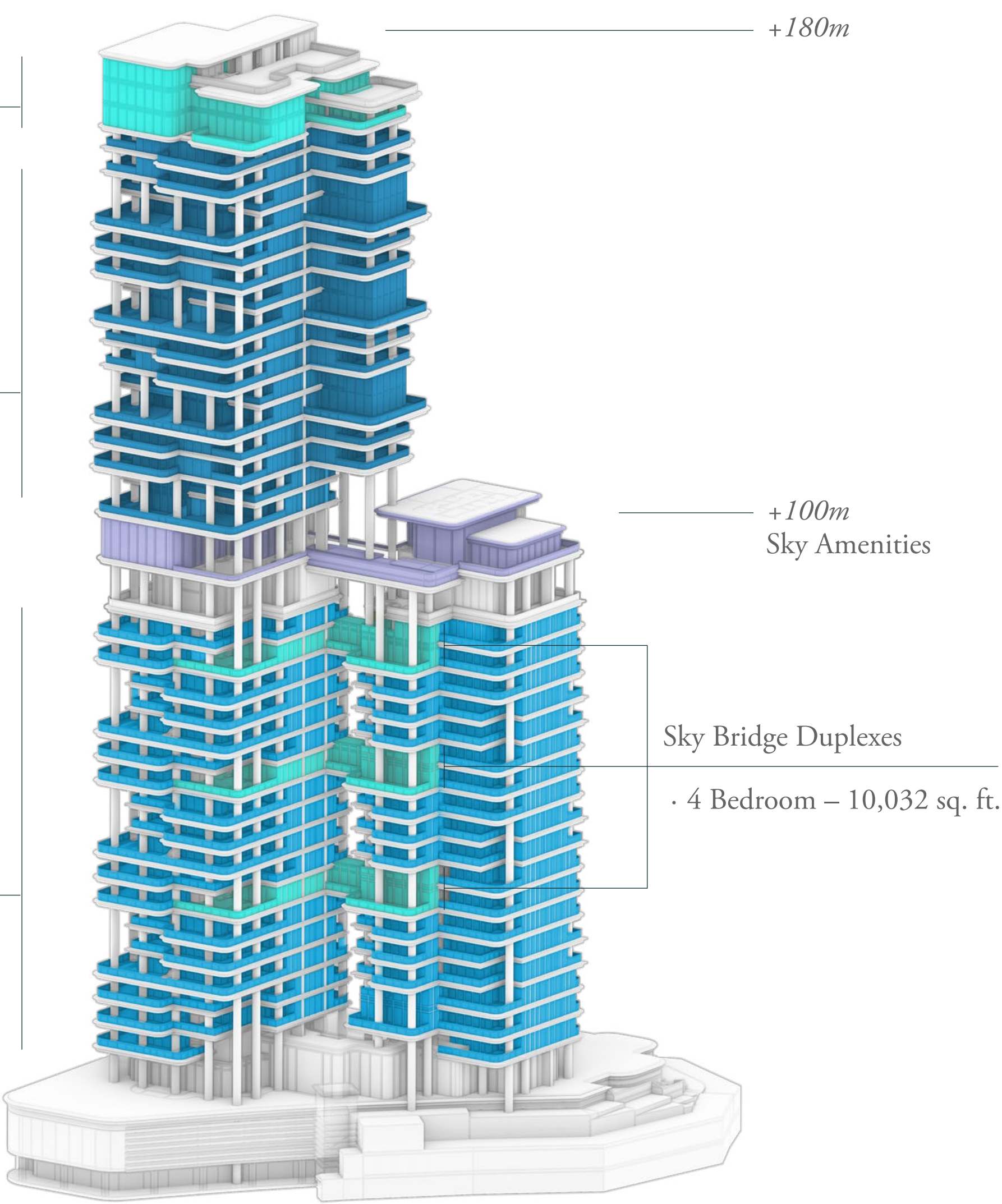

*Enchanting spaces*  
*that beckon*  
with the promise of  
*grand serenity*



# *The pinnacle of wellbeing*

VELA VIENTO redefines the essence of luxury living with ethereal spaces that enhance self-care and wellbeing.

Touching the sky at 100 metres high at over half of the height of the building, the 'Sky Amenities Deck' is an architectural and experiential feature with a spectacular infinity pool, double-height gym, yoga studio and lounge areas, all overlooking the stunning vistas that surround.

*Sunsets never felt so good.*

These are complemented by additional amenities on the podium levels, including indoor pools, spa and meeting rooms, as well as direct access to VELA and The Lana Hotel amenities via the waterfront promenade.



# *Sky* Amenities

- Full-floor amenity deck on Level 21 (100m high)
- Stunning infinity-edge pool
- Sun decks and lounges
- Double height gym
- Dedicated yoga studio



# *Podium* Amenities

- Indoor lap pool & children's pool
- Private spa
- Meeting rooms
- Direct promenade access
- Golf car service to VELA and The Lana



One at Palm Jumeirah



The Lana

## *Your key to a world of privileges*

As a VELA VIENTO homeowner, you're invited to immerse yourself in a world of unparalleled benefits, including access to a range of exceptional amenities across selected OMNIYAT properties.

Indulge in the convenience of access to the nearby VELA facilities, complemented by a membership program that grants entry to The Lana hotel facilities and spa. Golf-buggy service is available on hand for easy transportation along the promenade.

Embrace seaside leisure with access to the Beach Club at One at Palm Jumeriah by OMNIYAT. The glorious 100-metre white sand private beach is managed by Dorchester Collection and features a private jetty and direct access to the waterfront promenade. For the ultimate voyage, a 'flying' yacht can be arranged to sail you away from Marasi Bay, directly arriving to the jetty.

# *Outstanding Hospitality*

Managed by

**)(** *Dorchester Collection*

## *Classic*

- Common area maintenance
- 24/7 Residence concierge
- Doorman and porter services
- Valet parking
- Lifeguard and gym service
- 24/7 Security services

## *À La Carte*

- Housekeeping
- Laundry
- Maintenance
- Bespoke in-residence catering services
- One-off dining events & functions
- Floristry services
- Bookings, reservations & appointments
- Five-star experiences at home



# OMNIYAT

THE ART OF ELEVATION

OMNIYAT is a renowned developer of luxurious architectural masterpieces. The Art of Elevation embodies our dedication to imagining the extraordinary and building it into reality. We elevate the exceptional to create immersive living masterpieces framed by Dubai's iconic skylines.

Since our establishment in 2005, OMNIYAT has redefined each project as an extraordinary, rare piece of art, partnering with global pioneers such as Foster + Partners, Zaha Hadid, Gilles & Boissier, Dorchester Collection and more.

The OMNIYAT touch lies in our ability to enhance experiences and shape the future of luxury living.

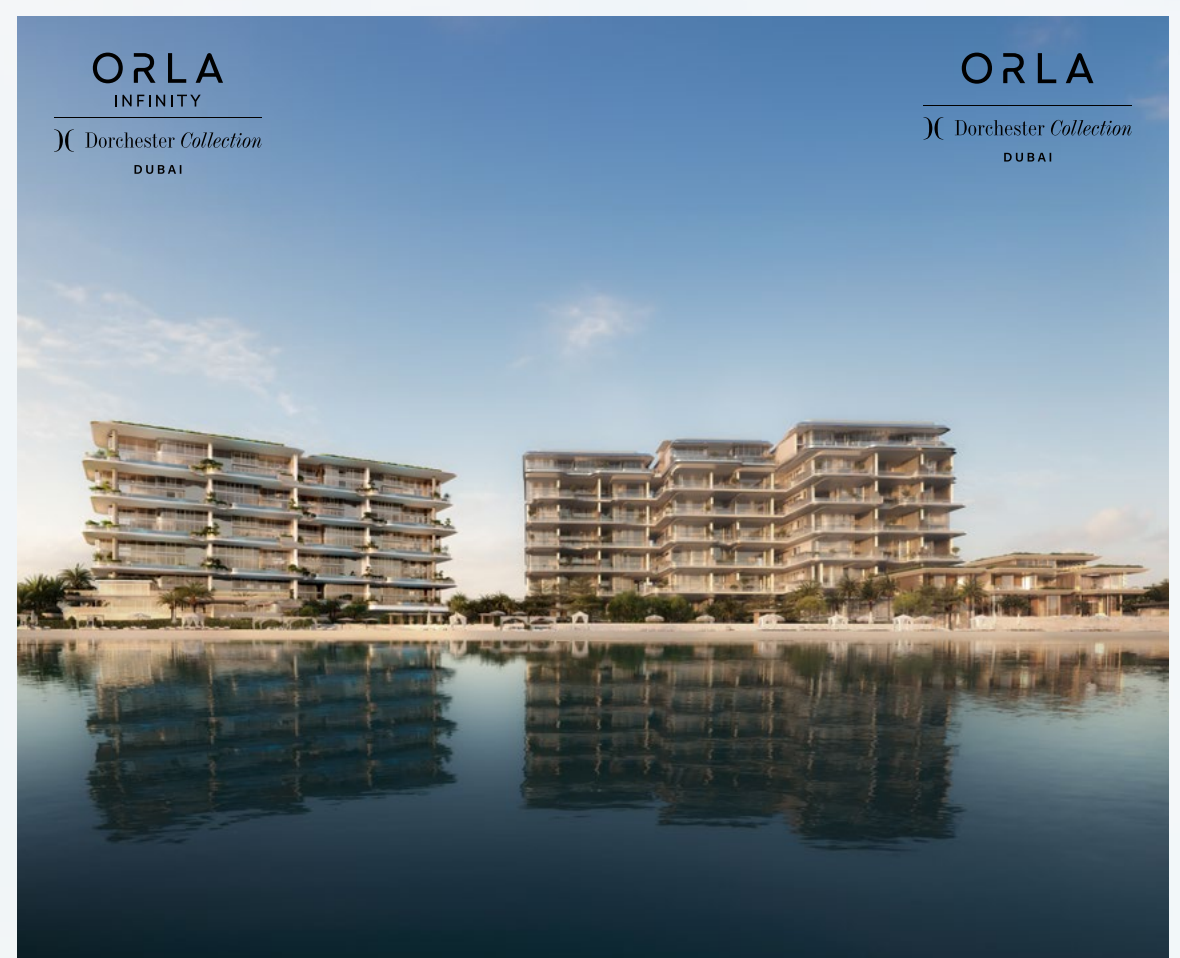

# OMNIYAT

The images, artist representations, amenities and interior decorations, finishes, appliances and furnishings contained in this brochure are provided for illustrative purposes only. Nothing in this brochure and/or any accompanying document and/or communication from OMNIYAT (whether verbal or in writing) constitutes a promise, representation and/ or warranty in any form whatsoever.

OMNIYAT reserves the right to substitute at any time without notice all or parts of the materials, appliances, equipment, fixtures and other construction and design details specified herein with similar materials, appliances, equipment and/or fixtures of equal or better quality, determined at the sole discretion of OMNIYAT. All square footages and dimensions are approximate only and may be subject to change at any time without notice.