

**nickelodeon**<sup>TM</sup>  
HOTELS & RESORTS

AIDA, OMAN



**Did you know  
your getaway  
can come  
with a dose of  
Nickelodeon fun?**





**Smiles,  
Epic Days,  
And The  
Slime Of  
Your Life**

An aerial view of a cliffside resort in Oman, featuring a large, modern building complex built into the rugged, brown hills. The resort is surrounded by a lush green landscape with golf courses and swimming pools. In the foreground, a cartoon character with orange fur and a pink headband is driving a white and pink flying car over a turquoise bay. The car has a large pink wing and a propeller. The background shows a vast desert landscape with rolling hills and a winding river.

**AIDA**

MUSCAT, OMAN

## **A First In The Middle East**

**DarGlobal partners with Paramount to bring  
Nickelodeon Hotels & Resorts to AIDA, Oman.**

Set 130m above the sea, this clifftop resort blends world-class  
hospitality with Nickelodeon fun.



Concept Artwork



# I'm The Map! I'm The Map! I'm The Map!

- 1 MIN** Nikki Beach Resort & Spa
- 1 MIN** Yiti Beach
- 5 MIN** Yenkit Beach
- 5 MIN** Marina Sustainable City
- 7 MIN** Shangri-La Hike
- 7 MIN** Muscat Bay
- 7 MIN** Jumeirah Muscat
- 7 MIN** Shangri-La Resort
- 10 MIN** Al Bustan Palace Ritz Carlton
- 20 MIN** Downtown Muscat
- 25 MIN** Muscat International Airport

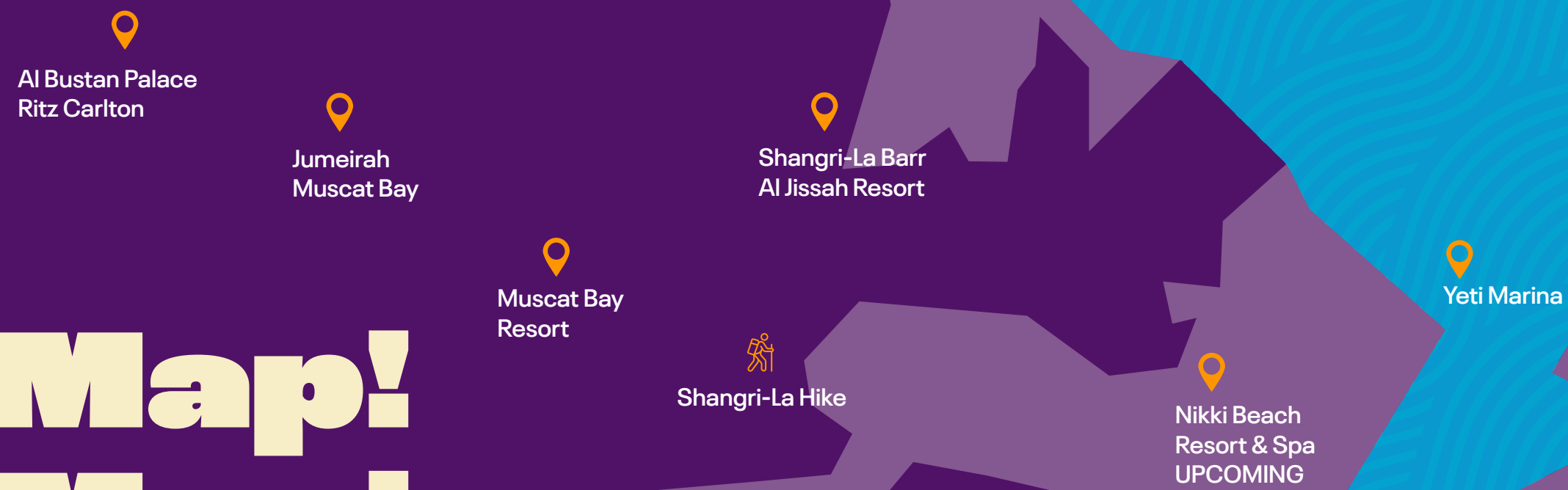

INDIAN OCEAN

# The Best Place To Live Out Loud



## **AIDA Amenities**

### **Signature Lifestyle & Luxury**

Trump International Hotel

Plazas, Cafes & Restaurants

Shft Night Club

Aida Beach

Trump 18-Hole Championship  
Golf Course

Trump International Golf Club

Wellness Spa Center

### **Leisure & Community Life**

Sunset Lounges

Swimming Pools

Gyms

Supermarkets

Outdoor Cinema

Sprk Dating Park

Pilates/Yoga Lawn

Kids Play Areas

AIDA Mosque

### **Adventure & Nature Escapes**

Running & Hiking Trails

Mountain Bike Trails

Rock Climbing

Diving Center

Stargazing

Tennis

Viewing Decks



**At The Heart Of AIDA,  
Find Nickelodeon**

**A family destination built on entertainment. The clincher? You get to call it home.**





# Are You Ready To Play?

LIVE SHOWS

GAMES & ACTIVITIES

CHARACTER MEET  
& GREETINGS

CHARACTER DINING

SLIMINGS

SIGNATURE EVENTS

KIDS' CLUB  
PROGRAMMING

SPLASH ZONES





**nick**

**WATER SLIDES**

**LAZY RIVERS**

**SOAK SUMMIT  
TOWER**

**NICK JR. ZONE**

**SUPER SLIMING**

**POOLSIDE GAMES  
& ACTIVITIES**



# Club Nick The Kids HQ

Fully supervised for ages 4-12, Club Nick is packed with themed games, crafts, surprises, and character pop-ins. A daily lineup of activities keeps the energy high, while parents relax knowing the kids are safe, engaged, and having a blast.



**With  
Club Nick  
On Duty,  
You Get  
To Hit The  
Nightclub  
Or The  
Greens**



**The Only Place  
Where Your  
Investment  
Comes With A  
Side Of **Slime****





# Invest In Hotel Rooms

Coming Soon!

# Choose Between Residences Or Hotel Rooms

Every space comes with a side of play.

## Invest In Residences

Choose from 1, 2, or 3 bedroom residences



Concept Artwork



# Not Just A Hotel A World Of Play

Nickelodeon Hotels & Resorts AIDA,  
Oman blends luxury hospitality with  
a playful edge.



# Nickelodeon Residences

# Furnished And Designed To Delight

1, 2, 3 bedroom residences  
with a Nickelodeon twist.

Live in it year-round, holiday  
when you like, or rent it  
out the rest of the year.





# 15 Reasons To Invest In **AIDA,** Oman

**1.** 100% foreign ownership.  
For special economic  
zone/free zone

**2.** 0% personal income tax.  
For special economic zone/  
free zone

**3.** 0% inheritance tax. Oman  
applies the inheritance laws of  
the investor's country of origin,  
not local laws

**4.** Lifetime residency visa  
and hassle-free bank  
account setup

**5.** 25-year exemption from  
corporate income tax.  
For special economic  
zone/free zone

**6.** 0% capital gains tax

**7.** Home to the Trump  
International Golf  
Club Oman

**8.** Free social membership  
to Trump International  
Golf Club Oman

**9.** Home to the most  
beautiful hotel in  
the world

**10.** Exclusive mortgage program  
in Oman. For resident  
and non-resident buyers,  
designed to enhance real  
estate returns

**11.** 5-Star recreational and  
dining options

**12.** 130 meters above  
the shores

**13.** One of the safest countries  
in the world

**14.** Upcoming railway  
project connecting UAE  
to Muscat, Oman

**15.** Upcoming highway connecting  
Saudi Arabia to Oman cutting  
travel by 16 hours, driving  
tourism and investment

# Floorplans

# Apartment Type 1A 1-Bed

Floors: Ground, 1 - 9

APARTMENT TOTAL AREA

SQM	SQFT
41 - 67	441 - 721

MASTER PLAN 

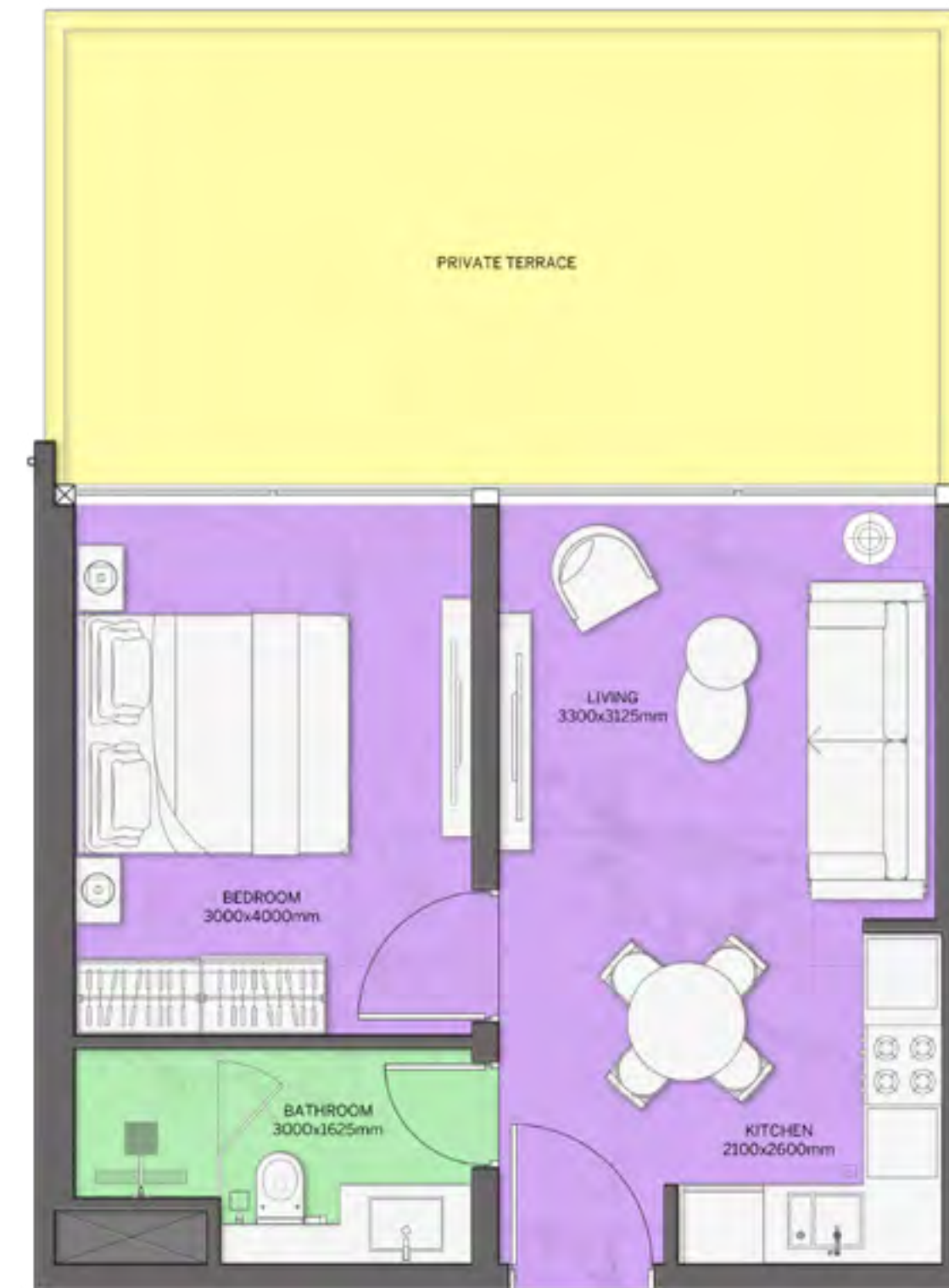
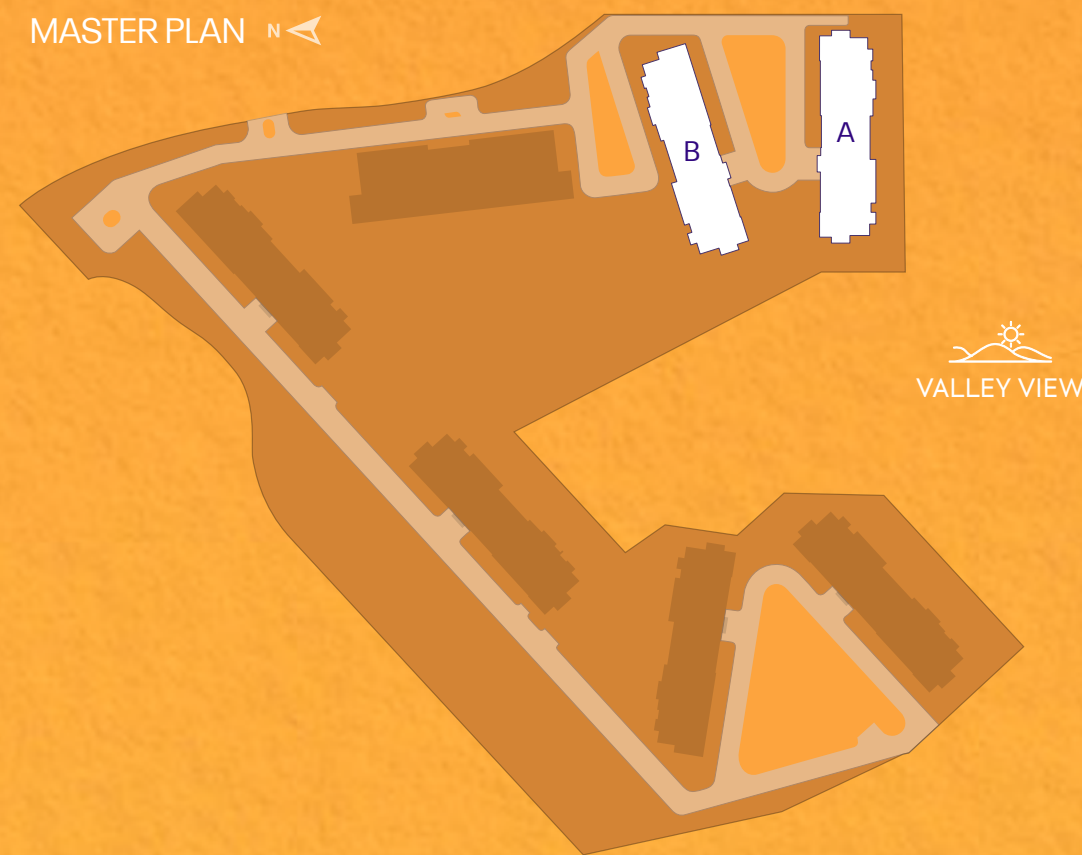

BUILDINGS: A, D, F  
GROUND FLOOR

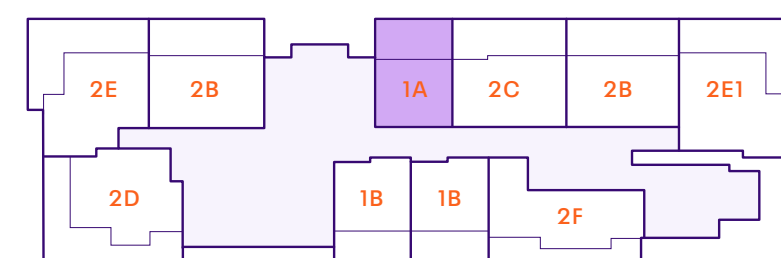

BUILDINGS: B, C, E  
GROUND FLOOR

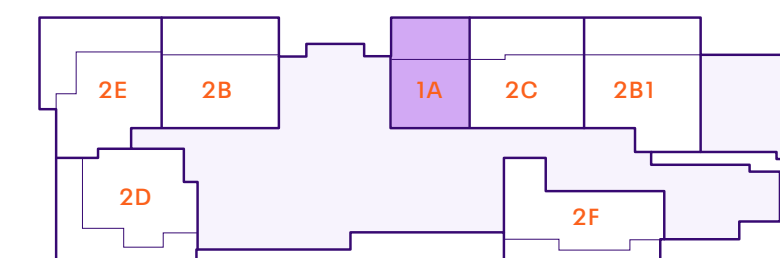

BUILDINGS: A, B, C, D, E, F  
LEVELS 1 - 9

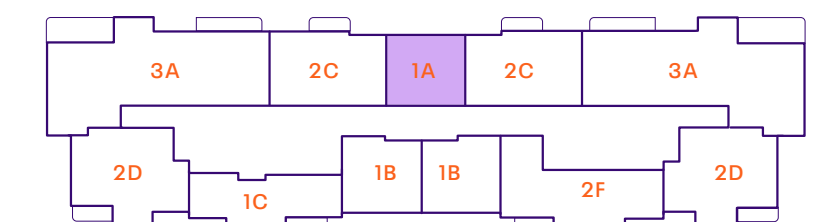

Disclaimer: All pictures, plans, layouts, information, data and details included in this brochure are indicative only and may change at any time up to the final 'as built' status in accordance with final designs of the project, regulatory approvals and planning permissions. All accessories and interior finishes such as wallpaper, chandeliers, furniture, electronics, white goods, curtains, hard and soft landscaping, pavements, features, gym, swimming pool(s) and other elements displayed in the brochure, or within the show apartment or between the plot boundary and the unit, are not part of the unit and are shown for illustrative purposes only.

# Apartment Type 1B 1-Bed

Floors: Ground, 1 - 9

APARTMENT TOTAL AREA

SQM	SQFT
41 - 67	441 - 721

MASTER PLAN 

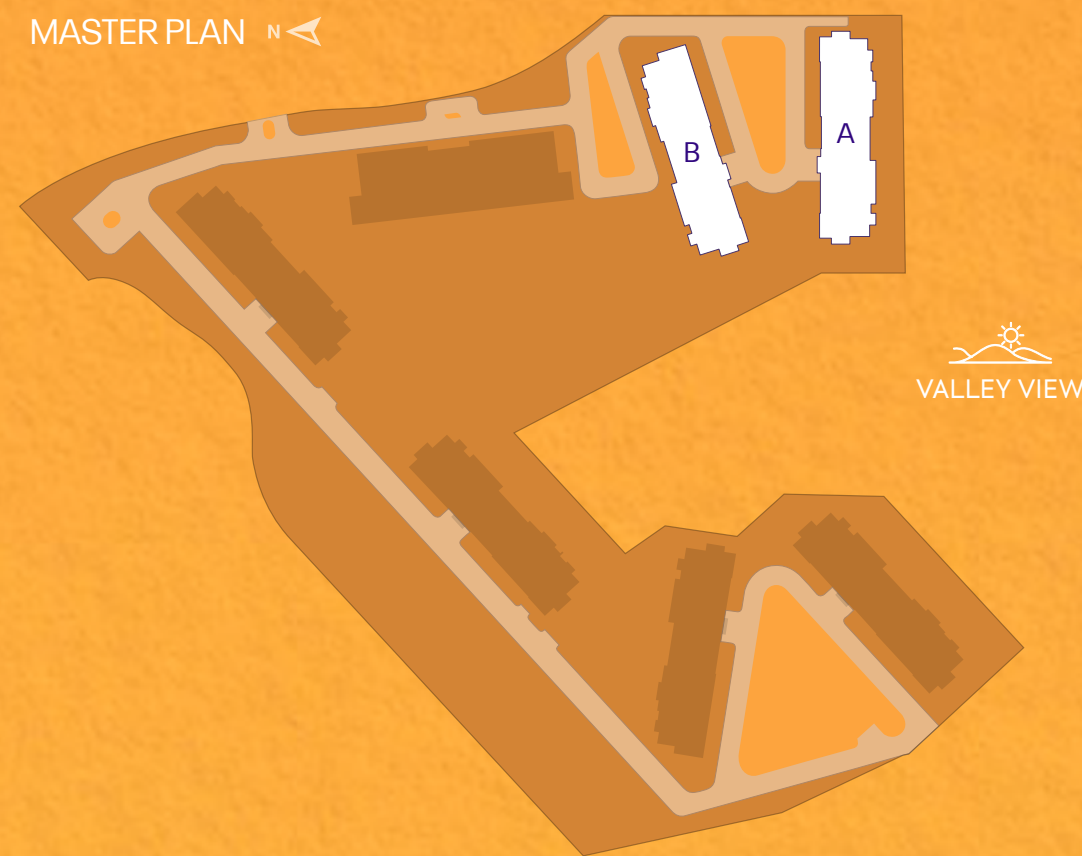

VALLEY VIEW

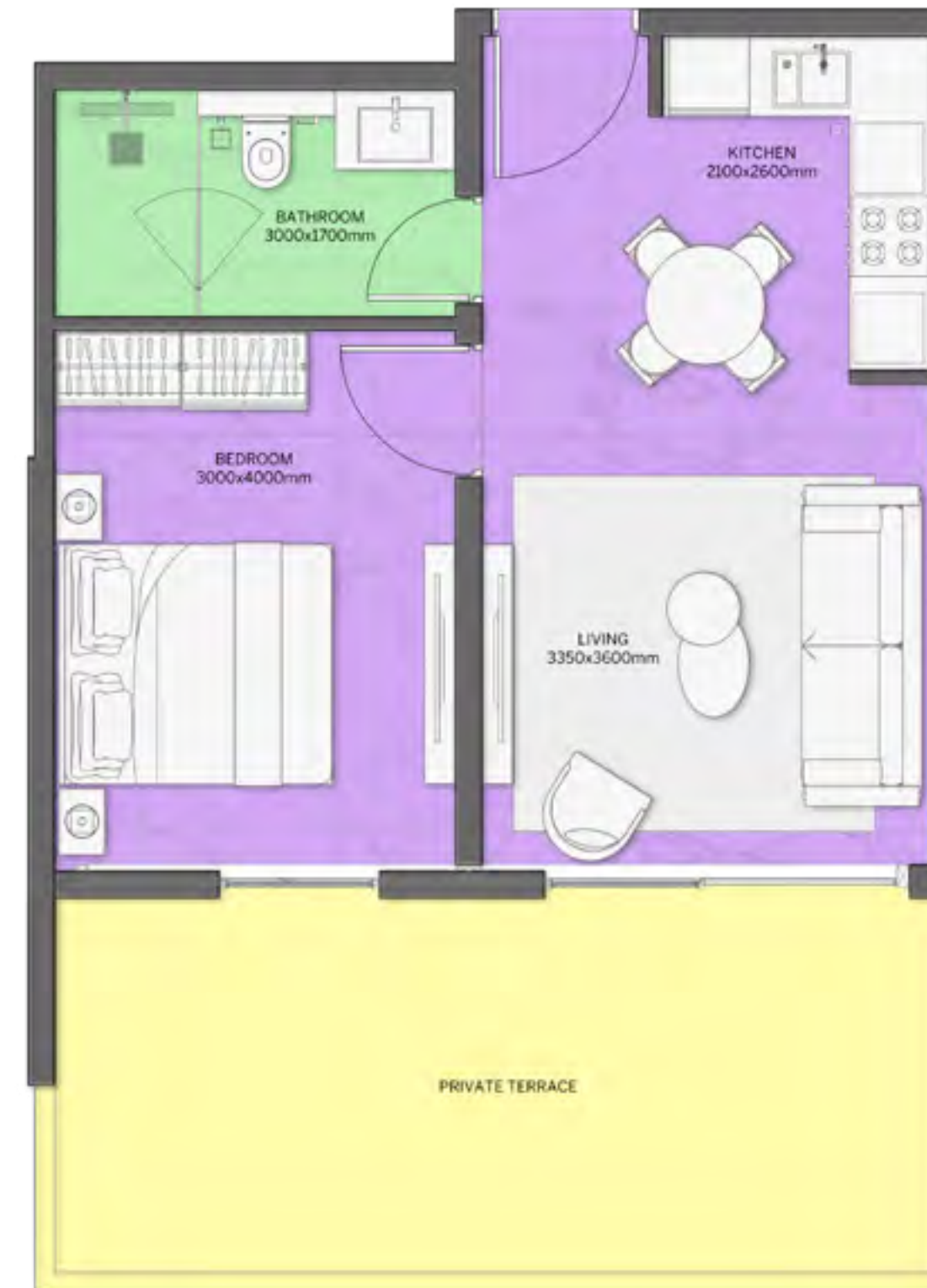

BUILDINGS: A, D, F  
GROUND FLOOR

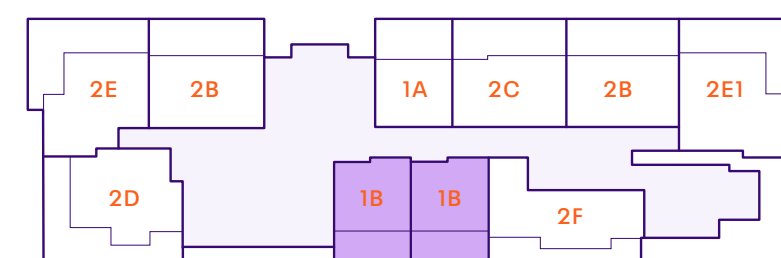

BUILDINGS: B, C, E  
GROUND FLOOR

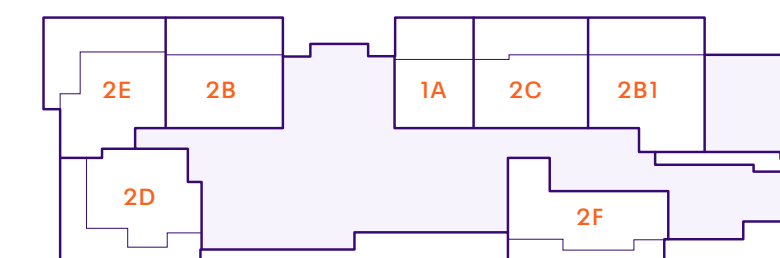

BUILDINGS: A, B, C, D, E, F  
LEVELS 1 - 9

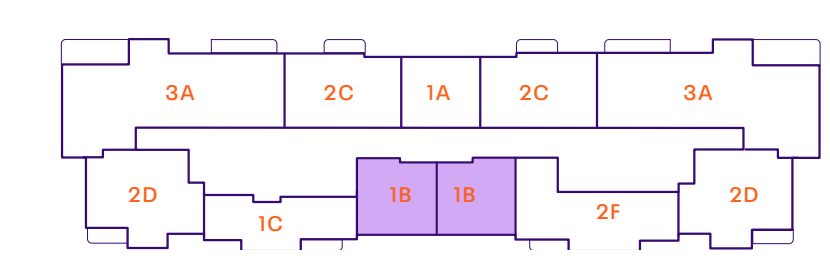

Disclaimer: All pictures, plans, layouts, information, data and details included in this brochure are indicative only and may change at any time up to the final 'as built' status in accordance with final designs of the project, regulatory approvals and planning permissions. All accessories and interior finishes such as wallpaper, chandeliers, furniture, electronics, white goods, curtains, hard and soft landscaping, pavements, features, gym, swimming pool(s) and other elements displayed in the brochure, or within the show apartment or between the plot boundary and the unit, are not part of the unit and are shown for illustrative purposes only.

# Apartment Type 1C 1-Bed

Floors: 1 - 9

APARTMENT TOTAL AREA

SQM	SQFT
41 - 67	441 - 721

MASTER PLAN 

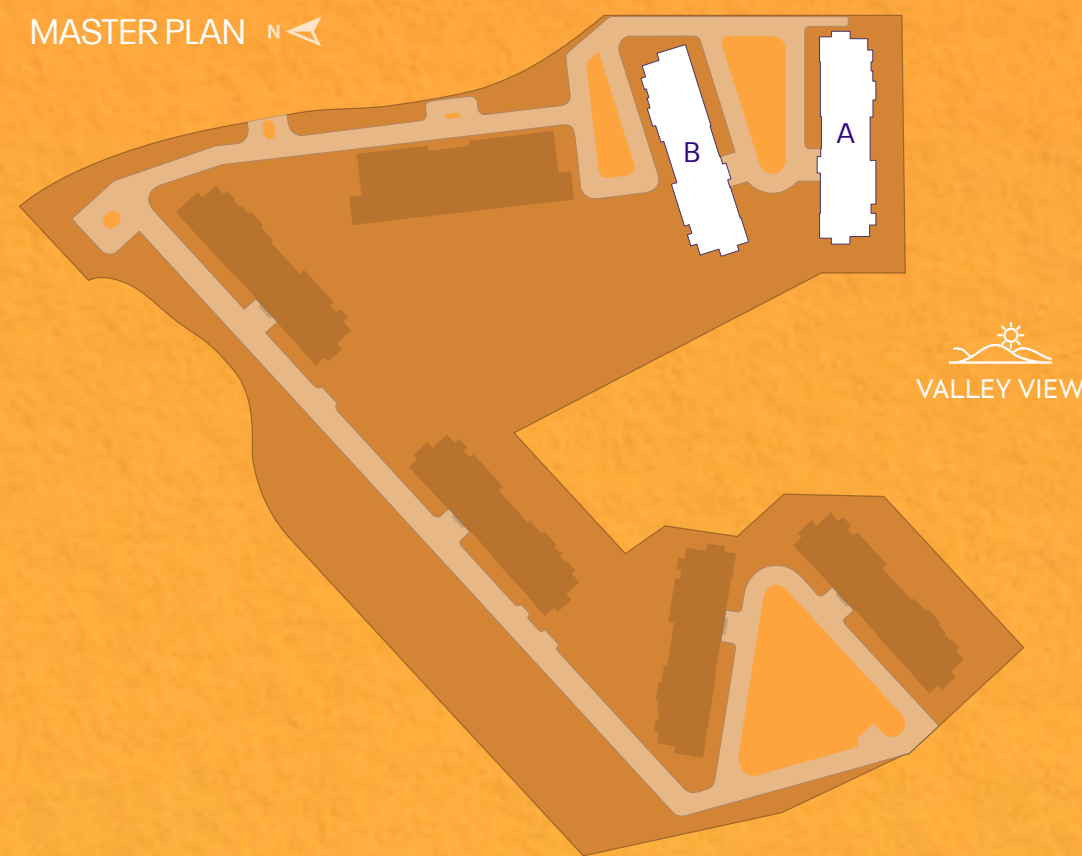

BUILDINGS: A, D, F  
GROUND FLOOR

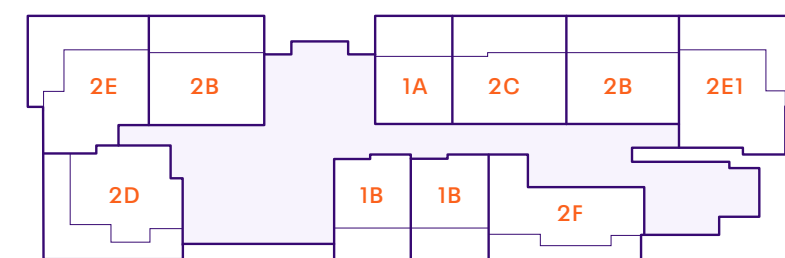

BUILDINGS: B, C, E  
GROUND FLOOR

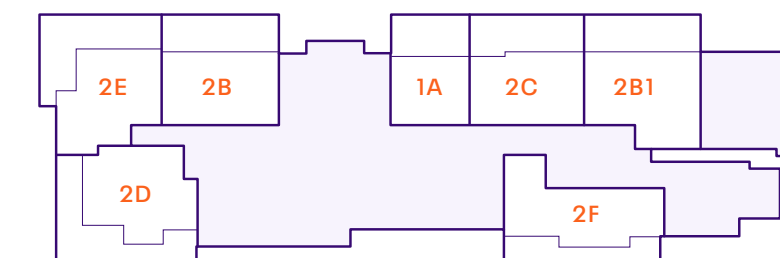

BUILDINGS: A, B, C, D, E, F  
LEVELS 1 - 9

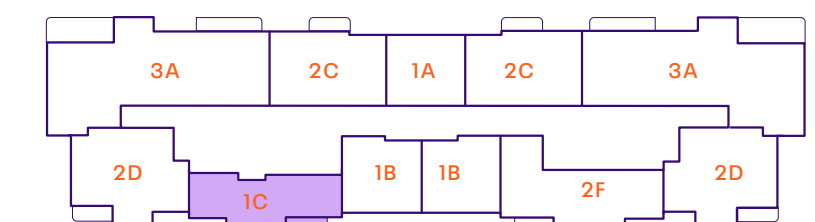

Disclaimer: All pictures, plans, layouts, information, data and details included in this brochure are indicative only and may change at any time up to the final 'as built' status in accordance with final designs of the project, regulatory approvals and planning permissions. All accessories and interior finishes such as wallpaper, chandeliers, furniture, electronics, white goods, curtains, hard and soft landscaping, pavements, features, gym, swimming pool(s) and other elements displayed in the brochure, or within the show apartment or between the plot boundary and the unit, are not part of the unit and are shown for illustrative purposes only.

# Apartment Type 2B 2-Bed

Floors: Ground, 1 - 8

APARTMENT TOTAL AREA

SQM	SQFT
67 - 122	721 - 1,313

MASTER PLAN 

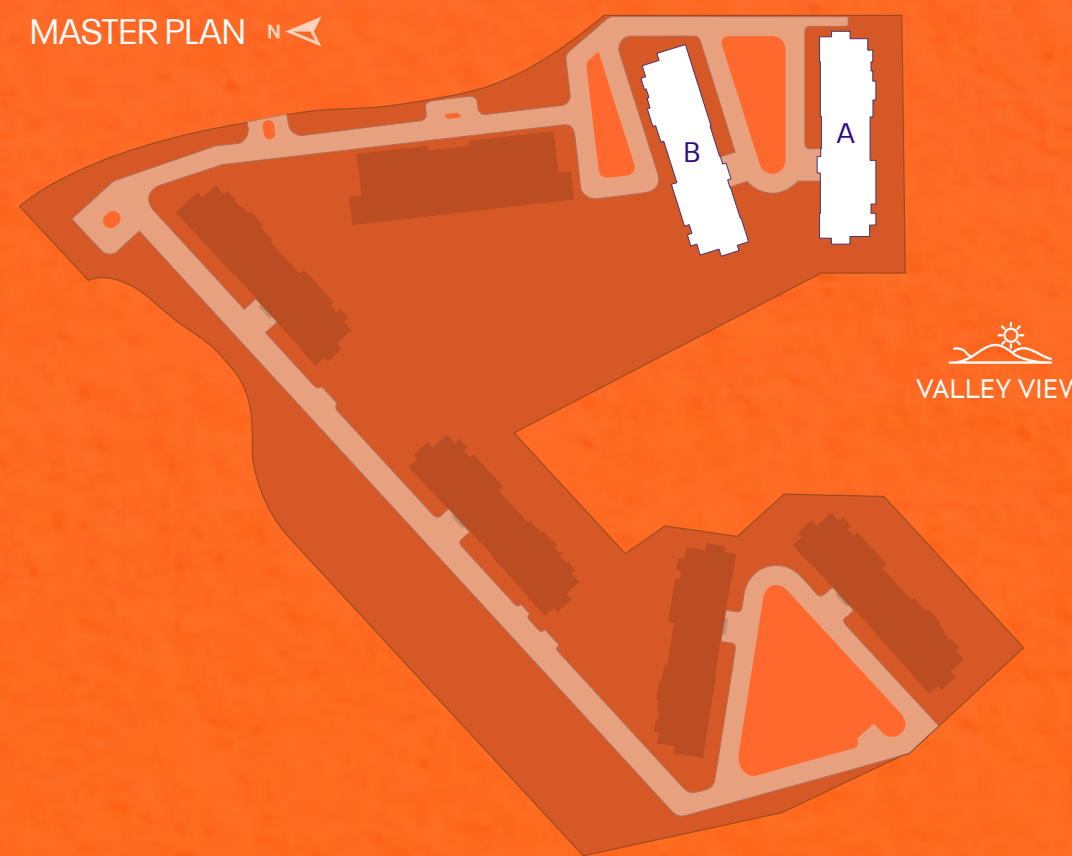

  
VALLEY VIEW

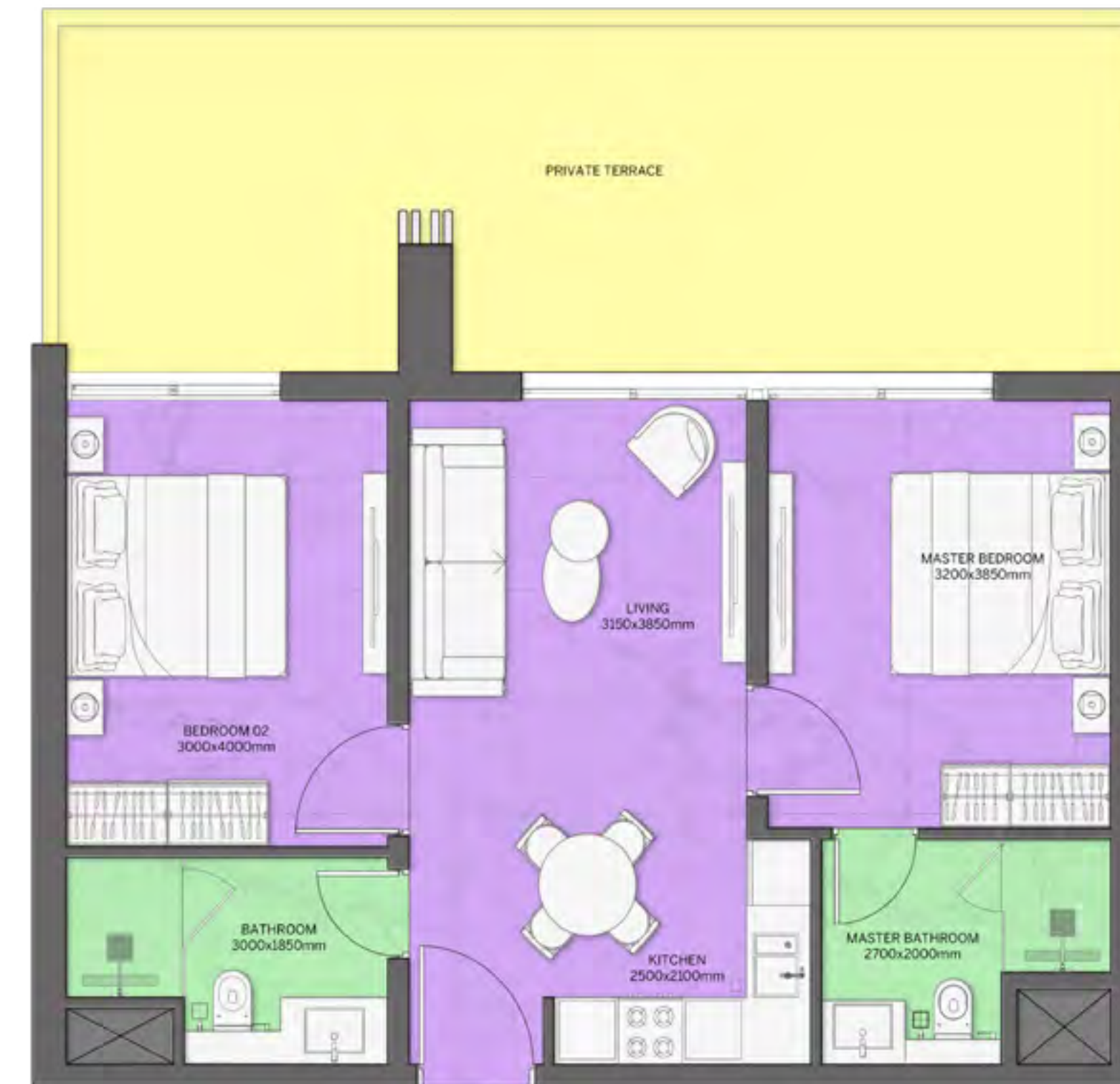

BUILDINGS: A, D, F  
GROUND FLOOR

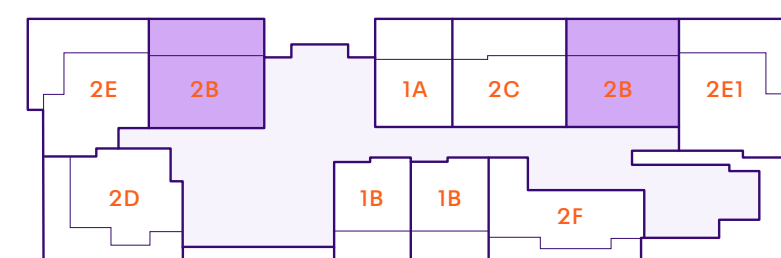

BUILDINGS: B, C, E  
GROUND FLOOR

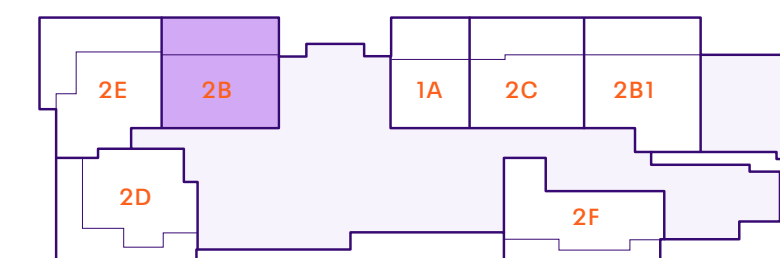

BUILDINGS: A, B, C, D, E, F  
LEVELS 1 - 8

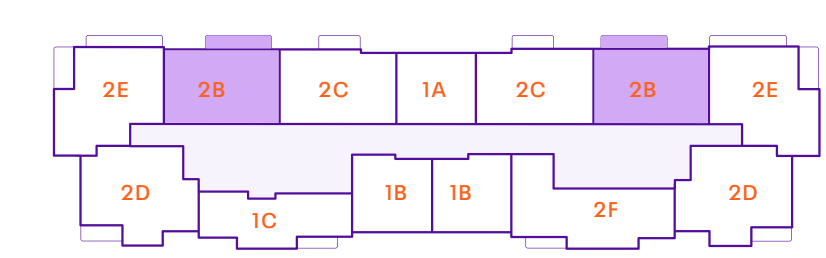

Disclaimer: All pictures, plans, layouts, information, data and details included in this brochure are indicative only and may change at any time up to the final 'as built' status in accordance with final designs of the project, regulatory approvals and planning permissions. All accessories and interior finishes such as wallpaper, chandeliers, furniture, electronics, white goods, curtains, hard and soft landscaping, pavements, features, gym, swimming pool(s) and other elements displayed in the brochure, or within the show apartment or between the plot boundary and the unit, are not part of the unit and are shown for illustrative purposes only.

# Apartment Type 2B1 2-Bed

Floor: Ground

APARTMENT TOTAL AREA

SQM	SQFT
67 - 122	721 - 1,313

MASTER PLAN 

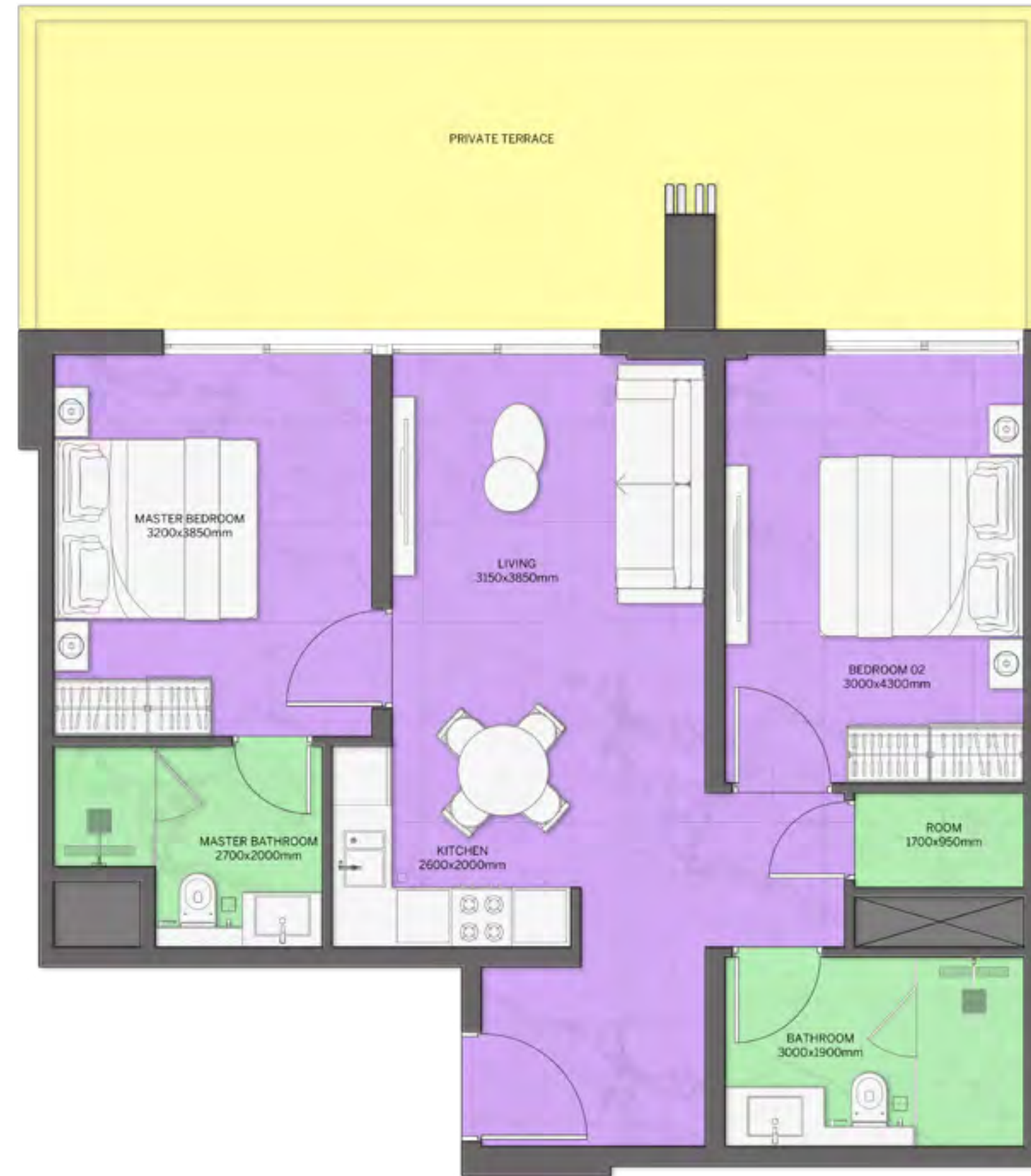
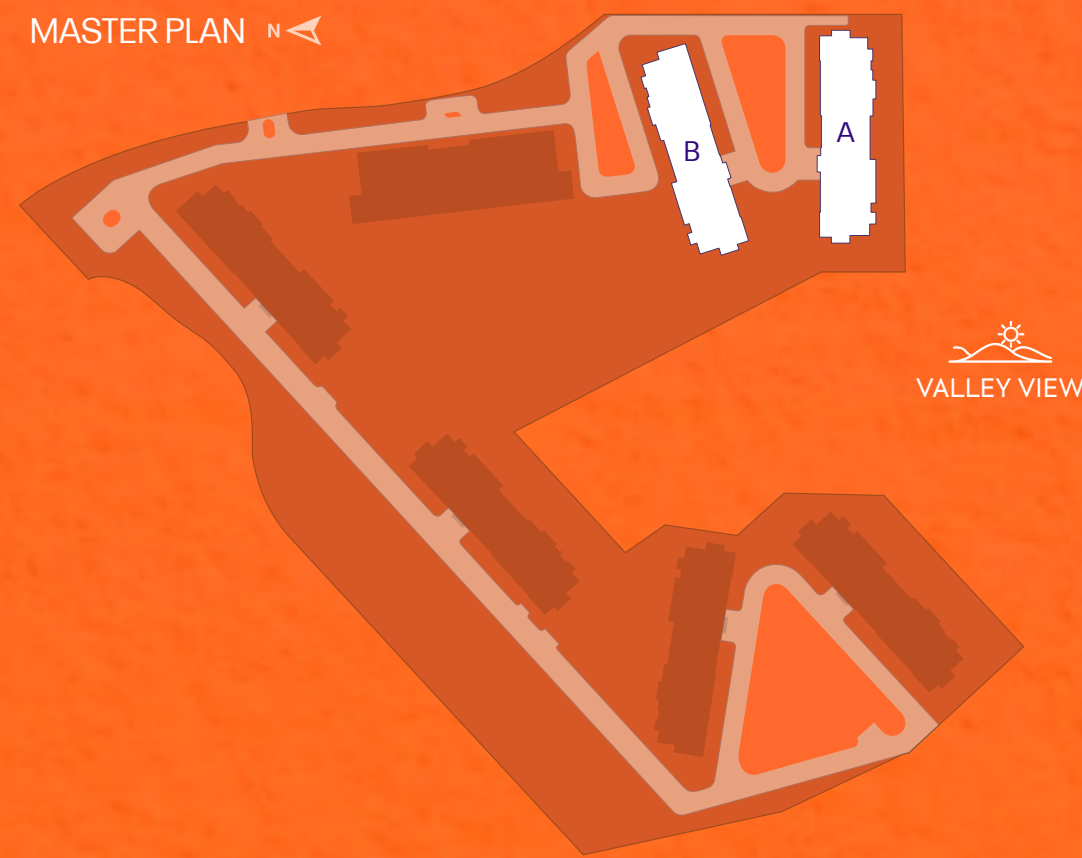

BUILDINGS: A, D, F  
GROUND FLOOR

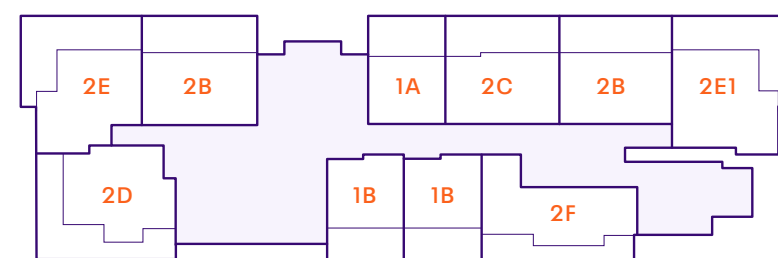

BUILDINGS: B, C, E  
GROUND FLOOR

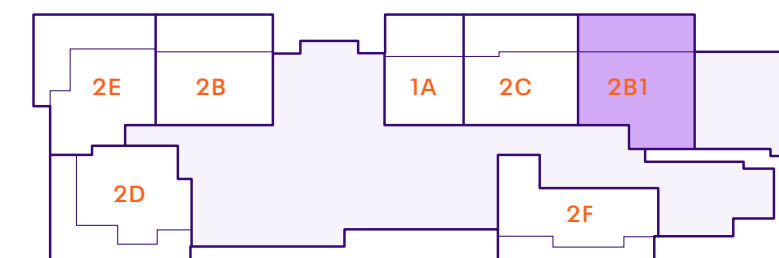

BUILDINGS: A, B, C, D, E, F  
LEVELS 1 - 9

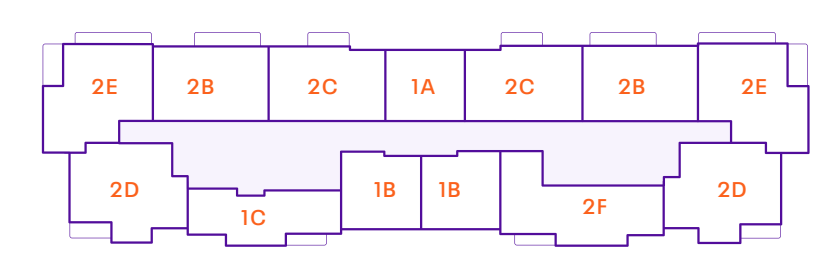

Disclaimer: All pictures, plans, layouts, information, data and details included in this brochure are indicative only and may change at any time up to the final 'as built' status in accordance with final designs of the project, regulatory approvals and planning permissions. All accessories and interior finishes such as wallpaper, chandeliers, furniture, electronics, white goods, curtains, hard and soft landscaping, pavements, features, gym, swimming pool(s) and other elements displayed in the brochure, or within the show apartment or between the plot boundary and the unit, are not part of the unit and are shown for illustrative purposes only.

# Apartment Type 2C 2-Bed

Floor: Ground, 1 - 9

APARTMENT TOTAL AREA

SQM	SQFT
67 - 122	721 - 1,313

MASTER PLAN 

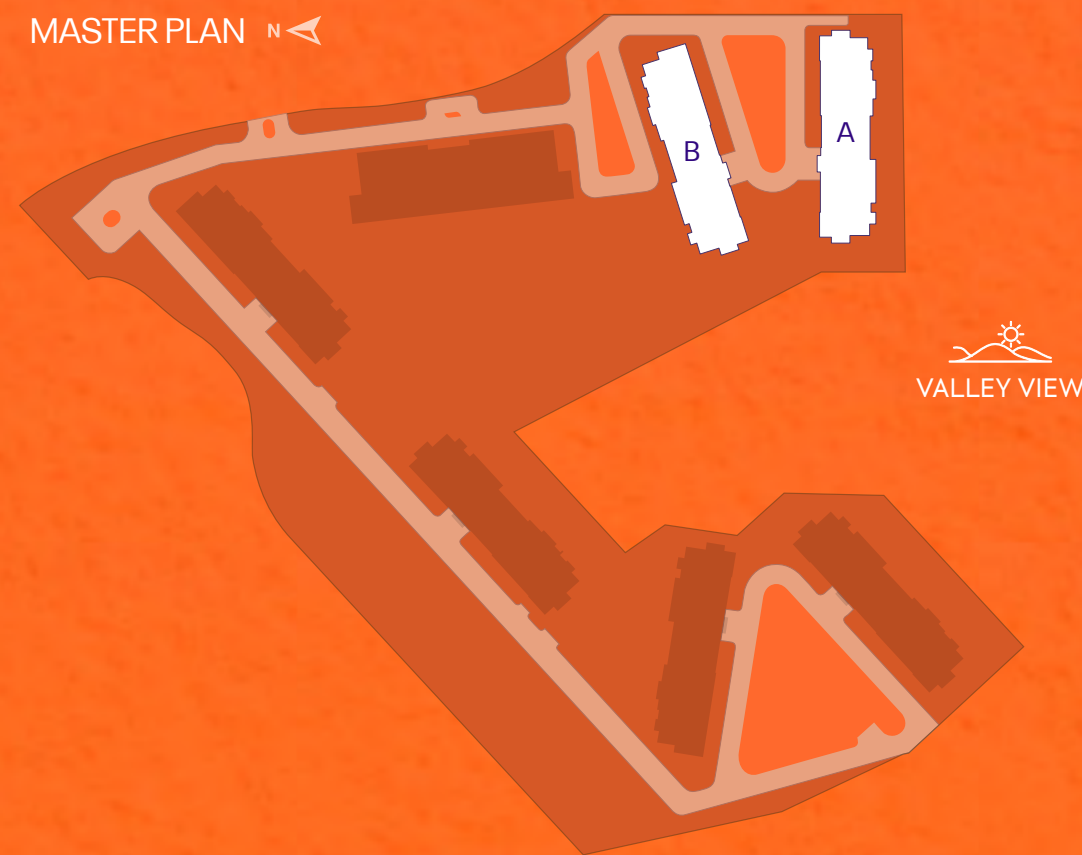

  
VALLEY VIEW



BUILDINGS: A, D, F  
GROUND FLOOR

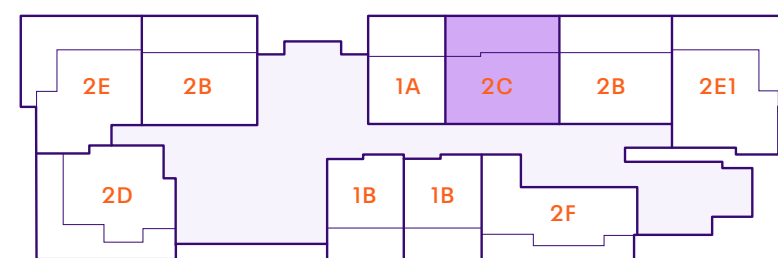

BUILDINGS: B, C, E  
GROUND FLOOR

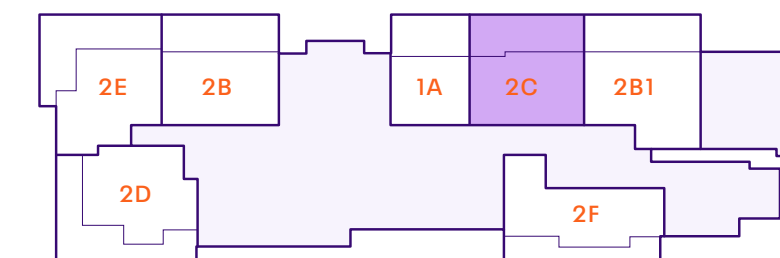

BUILDINGS: A, B, C, D, E, F  
LEVELS 1 - 9

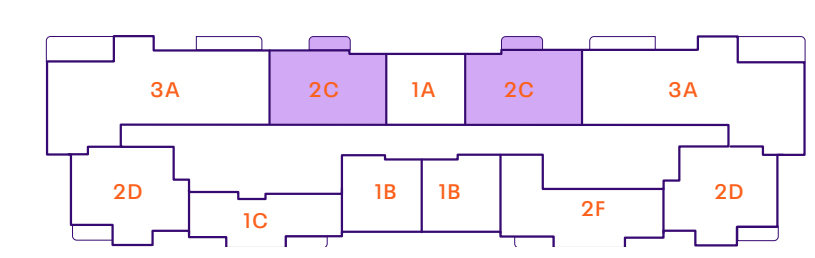

Disclaimer: All pictures, plans, layouts, information, data and details included in this brochure are indicative only and may change at any time up to the final 'as built' status in accordance with final designs of the project, regulatory approvals and planning permissions. All accessories and interior finishes such as wallpaper, chandeliers, furniture, electronics, white goods, curtains, hard and soft landscaping, pavements, features, gym, swimming pool(s) and other elements displayed in the brochure, or within the show apartment or between the plot boundary and the unit, are not part of the unit and are shown for illustrative purposes only.

# Apartment Type 2D 2-Bed

Floor: Ground, 1 - 9

APARTMENT TOTAL AREA

SQM	SQFT
67 - 122	721 - 1,313



MASTER PLAN



BUILDINGS: A, D, F  
GROUND FLOOR

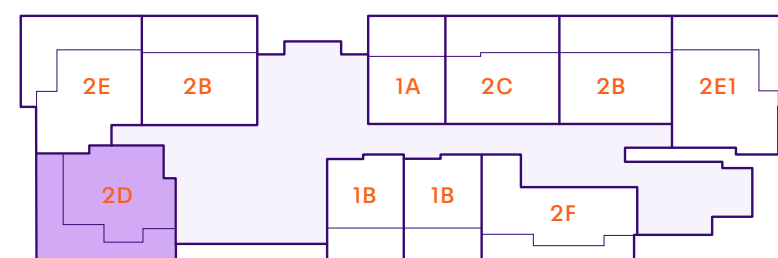

BUILDINGS: B, C, E  
GROUND FLOOR

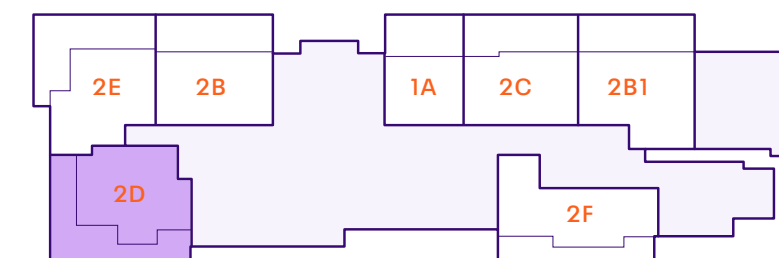

BUILDINGS: A, B, C, D, E, F  
LEVELS 1 - 9

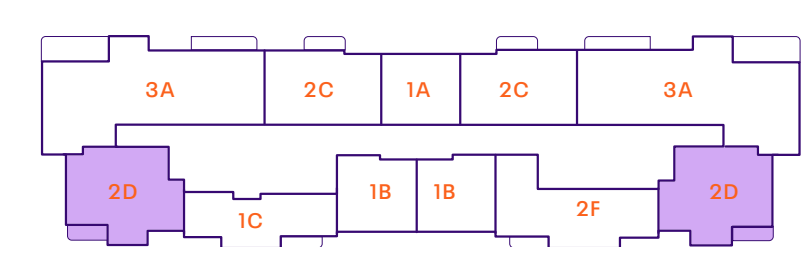

Disclaimer: All pictures, plans, layouts, information, data and details included in this brochure are indicative only and may change at any time up to the final 'as built' status in accordance with final designs of the project, regulatory approvals and planning permissions. All accessories and interior finishes such as wallpaper, chandeliers, furniture, electronics, white goods, curtains, hard and soft landscaping, pavements, features, gym, swimming pool(s) and other elements displayed in the brochure, or within the show apartment or between the plot boundary and the unit, are not part of the unit and are shown for illustrative purposes only.

# Apartment Type 2E 2-Bed

Floors: Ground, 1 - 8

APARTMENT TOTAL AREA

SQM	SQFT
67 - 122	721 - 1,313

MASTER PLAN 

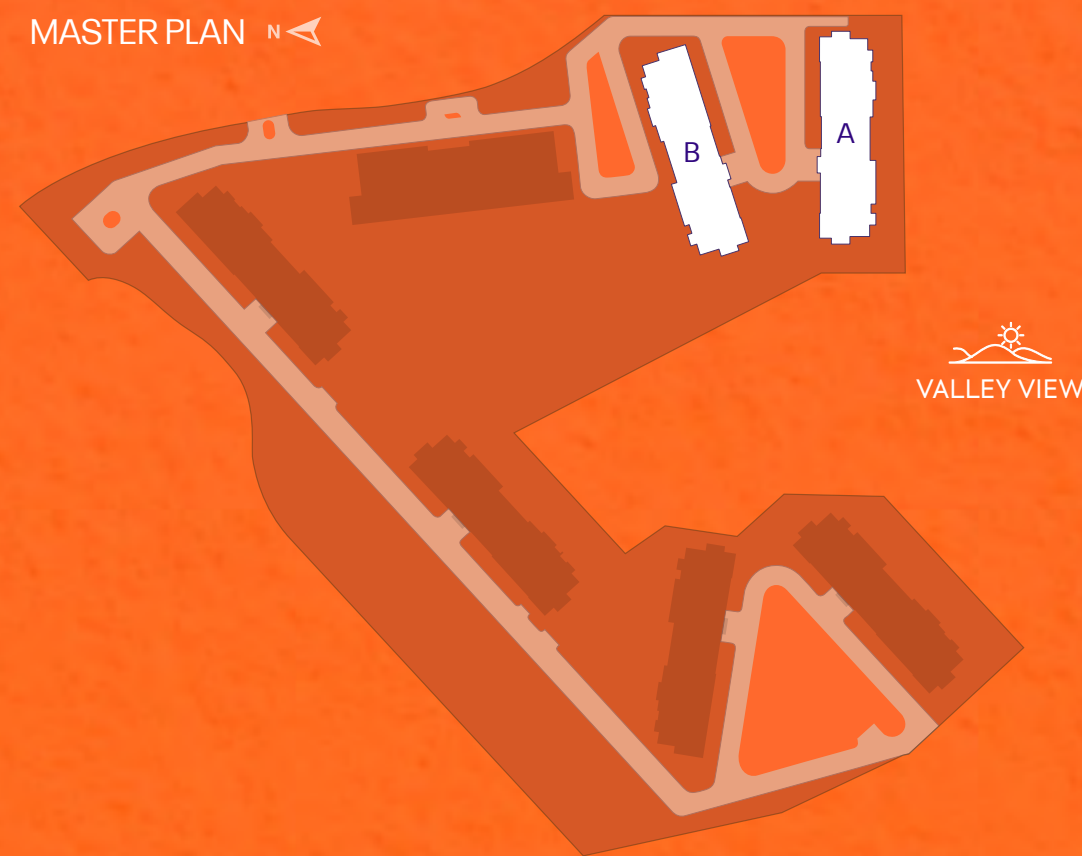

  
VALLEY VIEW



BUILDINGS: A, D, F  
GROUND FLOOR

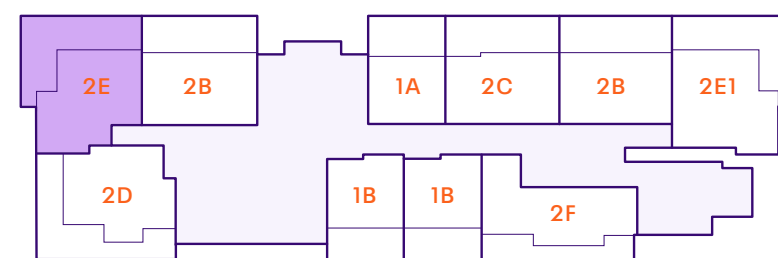

BUILDINGS: B, C, E  
GROUND FLOOR

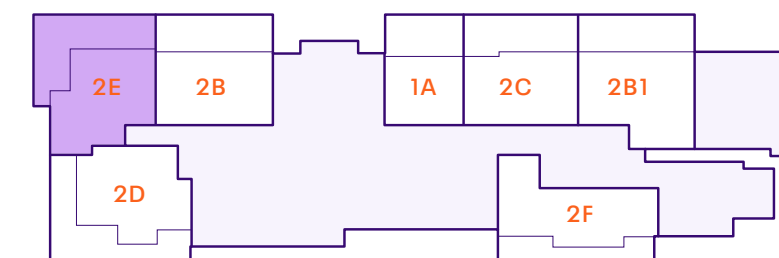

BUILDINGS: A, B, C, D, E, F  
LEVELS 1 - 8

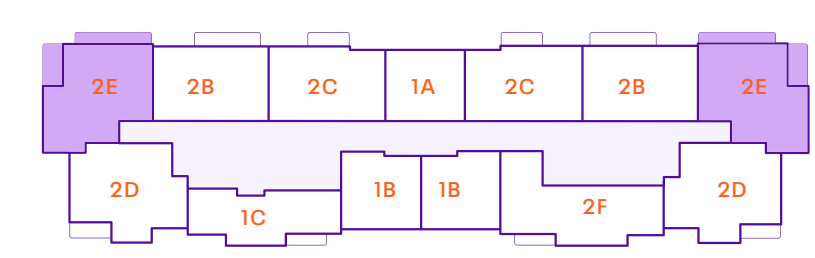

Disclaimer: All pictures, plans, layouts, information, data and details included in this brochure are indicative only and may change at any time up to the final 'as built' status in accordance with final designs of the project, regulatory approvals and planning permissions. All accessories and interior finishes such as wallpaper, chandeliers, furniture, electronics, white goods, curtains, hard and soft landscaping, pavements, features, gym, swimming pool(s) and other elements displayed in the brochure, or within the show apartment or between the plot boundary and the unit, are not part of the unit and are shown for illustrative purposes only.

# Apartment Type 2E1 2-Bed

Floor: Ground

APARTMENT TOTAL AREA

SQM	SQFT
67 - 122	721 - 1,313

MASTER PLAN 

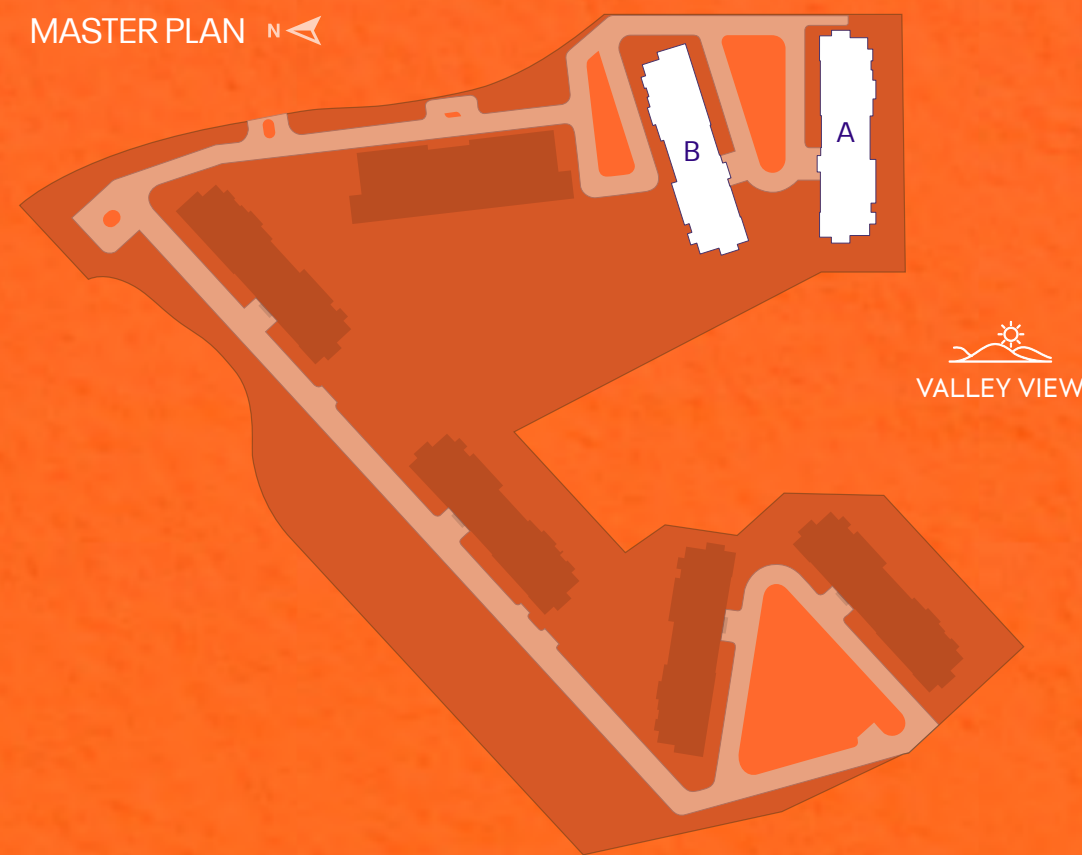

BUILDINGS: A, D, F  
GROUND FLOOR

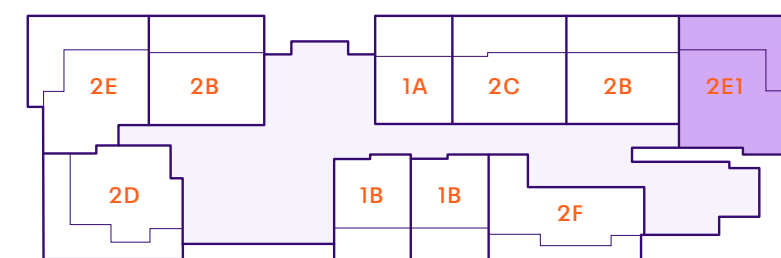

BUILDINGS: B, C, E  
GROUND FLOOR

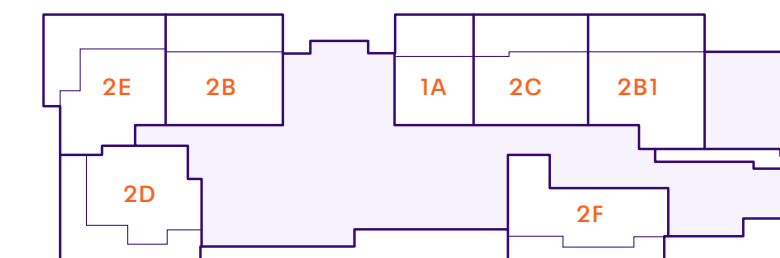

BUILDINGS: A, B, C, D, E, F  
LEVELS 1 - 9

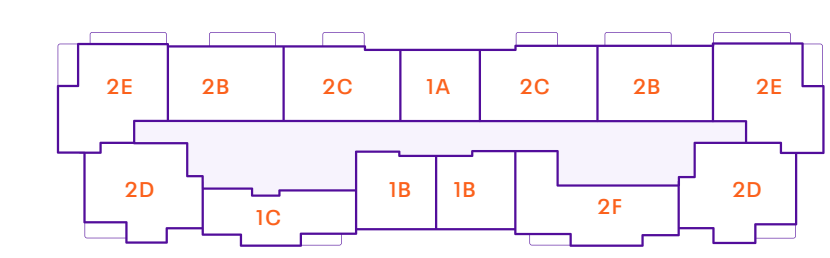

Disclaimer: All pictures, plans, layouts, information, data and details included in this brochure are indicative only and may change at any time up to the final 'as built' status in accordance with final designs of the project, regulatory approvals and planning permissions. All accessories and interior finishes such as wallpaper, chandeliers, furniture, electronics, white goods, curtains, hard and soft landscaping, pavements, features, gym, swimming pool(s) and other elements displayed in the brochure, or within the show apartment or between the plot boundary and the unit, are not part of the unit and are shown for illustrative purposes only.

# Apartment Type 2F 2-Bed

Floor: Ground, 1 - 8

APARTMENT TOTAL AREA

SQM	SQFT
67 - 122	721 - 1,313



MASTER PLAN

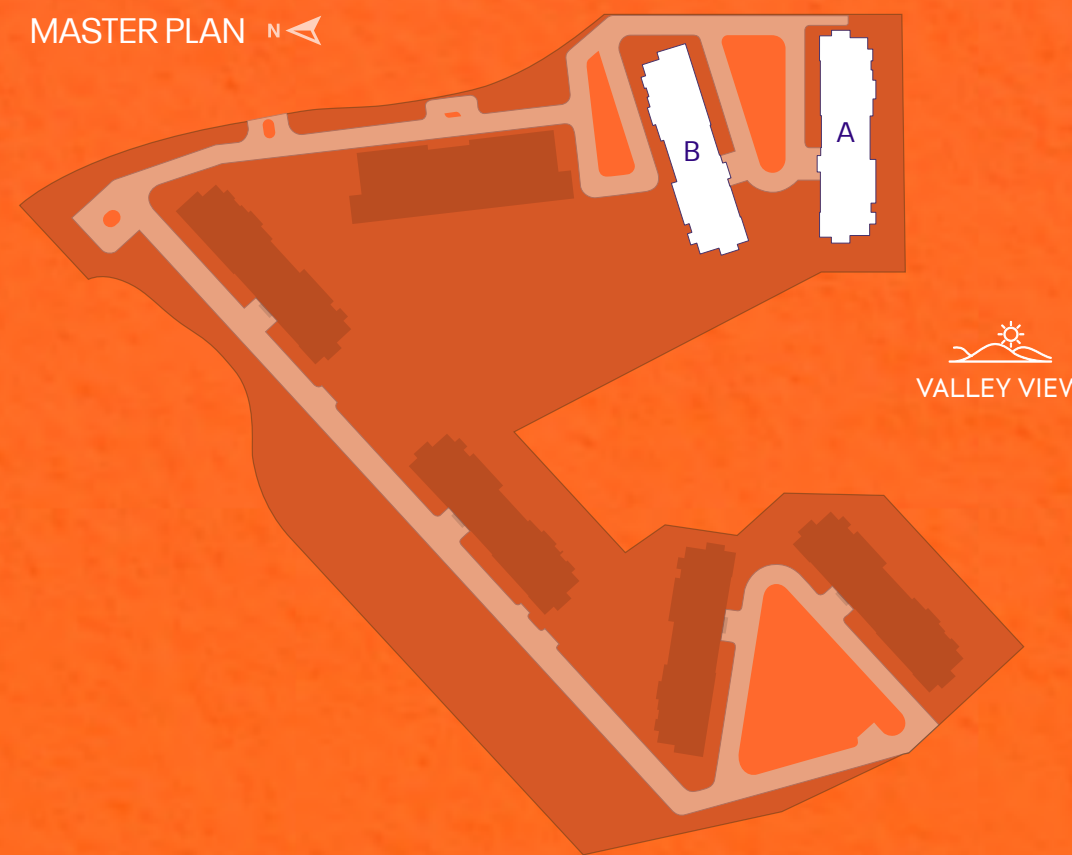

VALLEY VIEW

BUILDINGS: A, D, F  
GROUND FLOOR

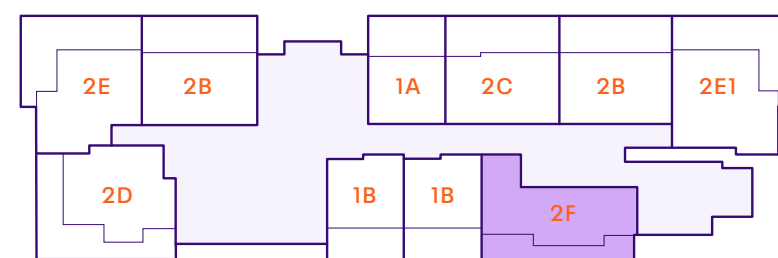

BUILDINGS: B, C, E  
GROUND FLOOR

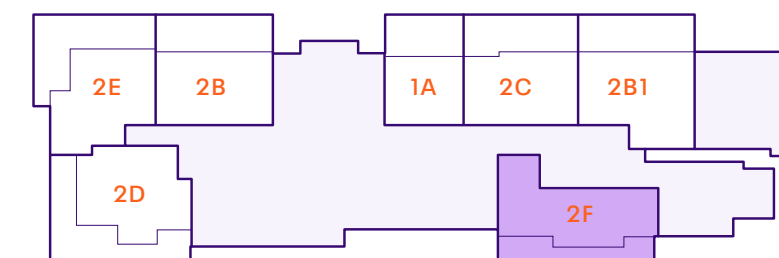

BUILDINGS: A, B, C, D, E, F  
LEVELS 1 - 8

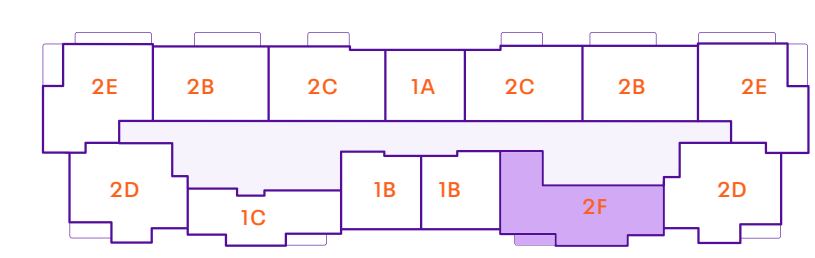

Disclaimer: All pictures, plans, layouts, information, data and details included in this brochure are indicative only and may change at any time up to the final 'as built' status in accordance with final designs of the project, regulatory approvals and planning permissions. All accessories and interior finishes such as wallpaper, chandeliers, furniture, electronics, white goods, curtains, hard and soft landscaping, pavements, features, gym, swimming pool(s) and other elements displayed in the brochure, or within the show apartment or between the plot boundary and the unit, are not part of the unit and are shown for illustrative purposes only.

# Apartment Type 3A 3-Bed

Floor: 9

APARTMENT TOTAL AREA

SQM	SQFT
154	1,658

MASTER PLAN 

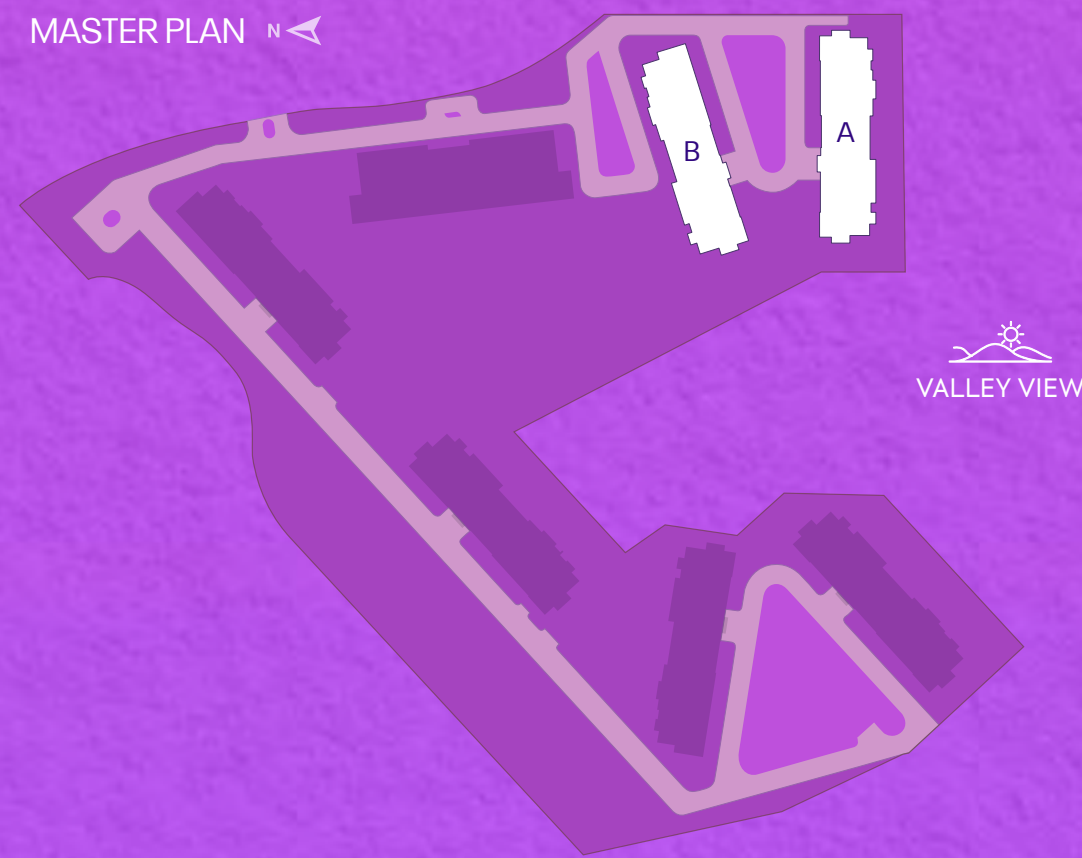

  
VALLEY VIEW



BUILDINGS: A, D, F  
GROUND FLOOR

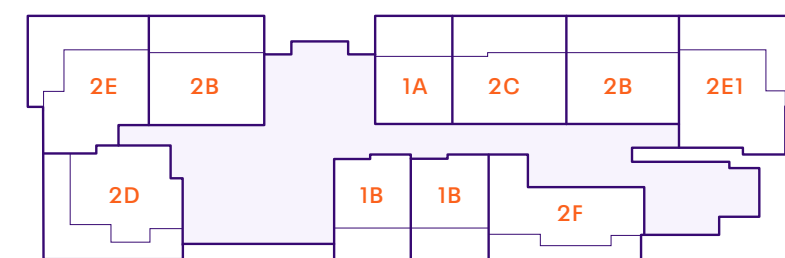

BUILDINGS: B, C, E  
GROUND FLOOR

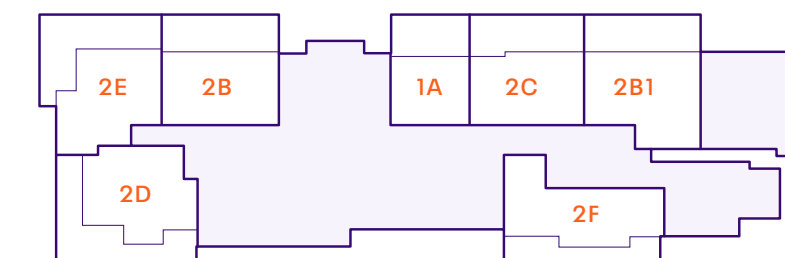

BUILDINGS: A, B, C, D, E, F  
LEVELS 1 - 9

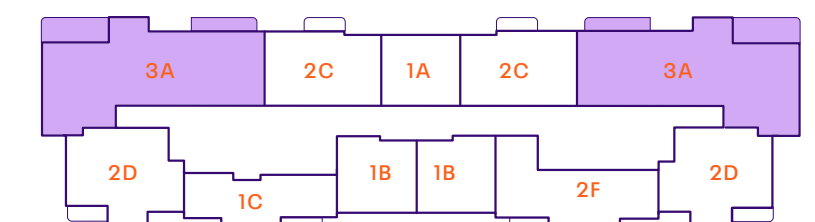

Disclaimer: All pictures, plans, layouts, information, data and details included in this brochure are indicative only and may change at any time up to the final 'as built' status in accordance with final designs of the project, regulatory approvals and planning permissions. All accessories and interior finishes such as wallpaper, chandeliers, furniture, electronics, white goods, curtains, hard and soft landscaping, pavements, features, gym, swimming pool(s) and other elements displayed in the brochure, or within the show apartment or between the plot boundary and the unit, are not part of the unit and are shown for illustrative purposes only.



## LIVE ALL IN

DarGlobal PLC is an international real estate developer specializing in exclusive luxury developments across the world's most coveted cosmopolitan cities. Catering to global citizens seeking prime investments, second homes, and luxury living, DarGlobal transforms real estate into economic catalysts, unlocking opportunities for both investors and the countries it enters.

DarGlobal has partnered with over 10 world-renowned luxury brands, including Trump Organization, Aston Martin, Automobili Lamborghini, ELIE SAAB, Marriott Residences, Missoni, Mouawad, Pagani Automobili, W Hotels, Versace, Fendi Casa, and Paramount. These collaborations offer unique investment opportunities in global cities, providing both wealth growth and protection.

Listed on the London Stock Exchange, DarGlobal goes beyond property development, it drives economic transformation by attracting international clients and Foreign Direct Investment (FDI). By injecting capital, confidence, and industry expertise, DarGlobal enhances local infrastructure while elevating the global appeal of each destination.

With a presence in 14 international cities across 7 countries, DarGlobal's portfolio spans the United Kingdom, Spain, Maldives, Saudi Arabia, the UAE, Oman, and Qatar. The company is also expanding into world-class hospitality, developing luxury hotels in Dubai, the Maldives, and Oman. To support its international clientele, DarGlobal has sales and customer service offices in New York, London, Marbella, Athens, Dubai, Jeddah, Riyadh, Muscat, and Doha.





## OUR OFFICES

### DUBAI, UAE

Jumeirah Emirates Towers  
30th Floor, Sheikh Zayed Road,  
PO Box 2523, Dubai, UAE  
+971 4 562 9616

### DOHA, QATAR

Malibu Building,  
Lusail Entertainment City,  
Doha, Qatar  
+974 4410 8282

### MUSCAT, OMAN

Royal Opera House Muscat  
Shatti Al Qurum,  
Muscat, Oman  
+968 2270 2771

### LONDON, UK

50 Hans Crescent,  
Knightsbridge, London,  
SW1X 0NA, UK  
+44 20 8135 4699

### ATHENS, GREECE

7 Merlin Street, 10671, Attica,  
Athens, Greece

### MARBELLA, SPAIN

Marbella Club Golden Mile,  
Av. Bulevar Principe Alfonso de  
Hohenlohe, Marbella 29602  
Málaga, Spain  
+34 951 121 221

### RIYADH, KSA

2135 Tahlia St.,  
Al Olaya, 12222  
Riyadh, KSA  
+966 800 118 8081

### JEDDAH, KSA

Ash Shati, 23613,  
King Abdulaziz Road,  
Jeddah, KSA  
+966 800 118 8081

### NEW YORK CITY, USA

19th floor, Trump Tower  
New York, 725 5th Ave, New York,  
NY 10022, USA  
+1 212 715 1067



[darglobal.co.uk](http://darglobal.co.uk)

Furniture provided in the unit will be strictly as per the specifications listed in the Sale Agreement and its appendixes. Any furniture, accessories, or decorative items shown in marketing materials or images are for illustrative purposes only and may not reflect the actual items supplied.