

CREEK Haven

DUBAI CREEK HARBOUR



DUBAI CREEK HARBOUR THE FUTURE OF WATERFRONT LIVING

Experience a unique waterfront enclave where contemporary luxury, serene nature and innovation come together. It features iconic amenities like Creek Marina, a haven for yachting enthusiasts, and close proximity to the Ras Al Khor Wildlife Sanctuary, renowned for its rich biodiversity, including flamingos.

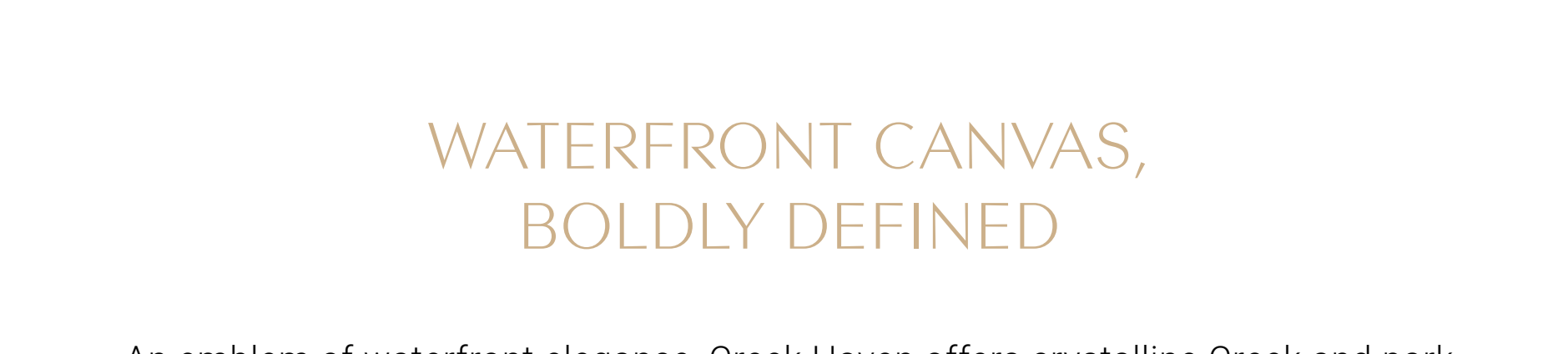

WATERFRONT CANVAS, BOLDLY DEFINED

An emblem of waterfront elegance, Creek Haven offers crystalline Creek and park views, with stunning vistas of Burj Khalifa and Downtown Dubai—a place where city energy meets harbourfront serenity.

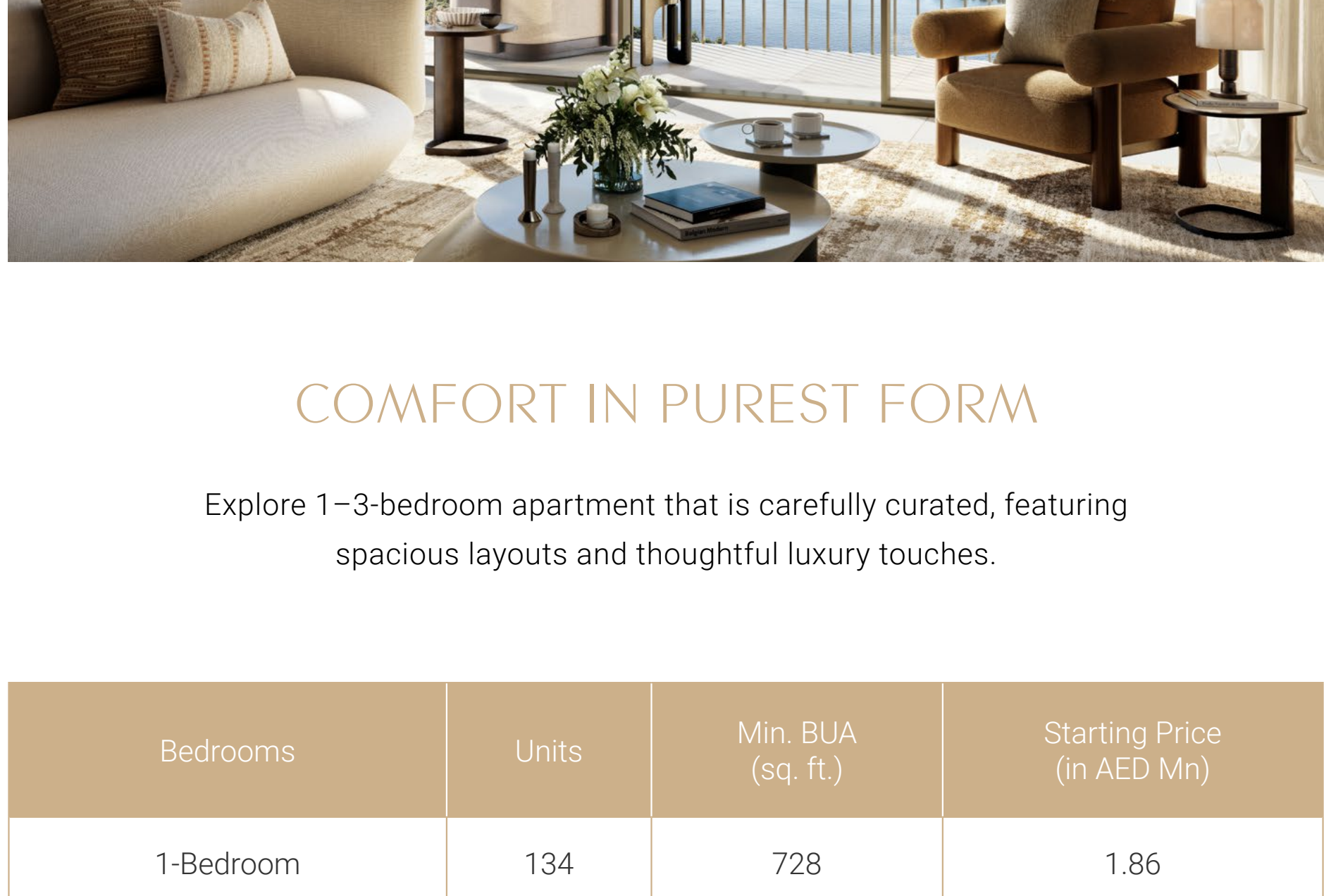
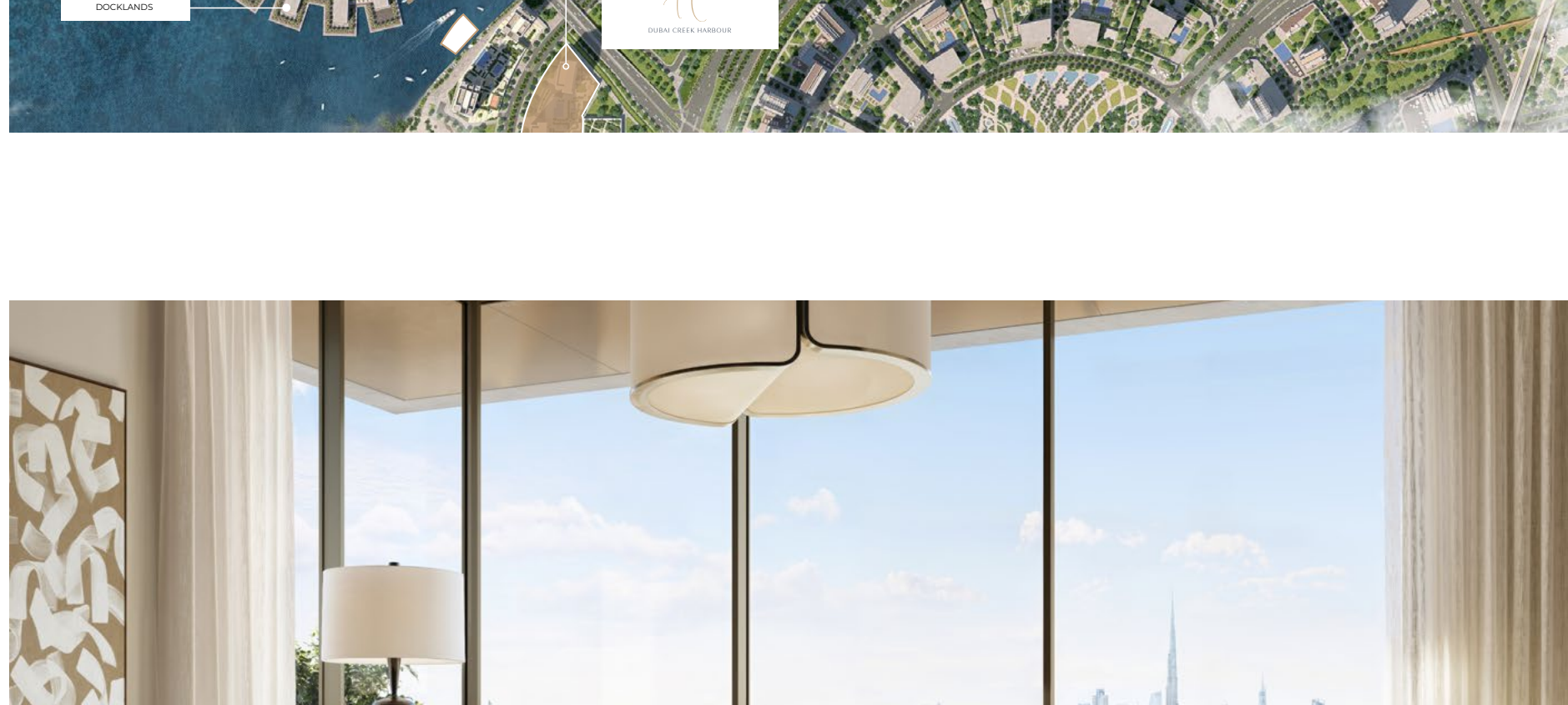

COMFORT IN PUREST FORM

Explore 1-3-bedroom apartment that is carefully curated, featuring spacious layouts and thoughtful luxury touches.

Bedrooms	Units	Min. BUA (sq. ft.)	Starting Price (in AED Mn)
1-Bedroom	134	728	1.86
2-Bedroom	147	1,189	2.88
3-Bedroom	38	1,869	4.83



Instalment	Payment Percentage	Date
Down Payment	10%	ON BOOKING
1st Instalment	10%	Apr 2026
2nd Instalment	10%	Sep 2026
3rd Instalment	10%	Mar 2027
4th Instalment	10%	Sep 2027
5th Instalment 40% Construction Completion	10%	Feb 2028
6th Instalment 60% Construction Completion	10%	Jul 2028
7th Instalment 80% Construction Completion	10%	Jan 2029
8th Instalment 100% Construction Completion	20%	Mar 2030

A CREEKSIDE STATE OF MIND

A place to reconnect with life, balancing wellness, leisure, and social moments. Come for the waterfront views, stay for lasting memories.

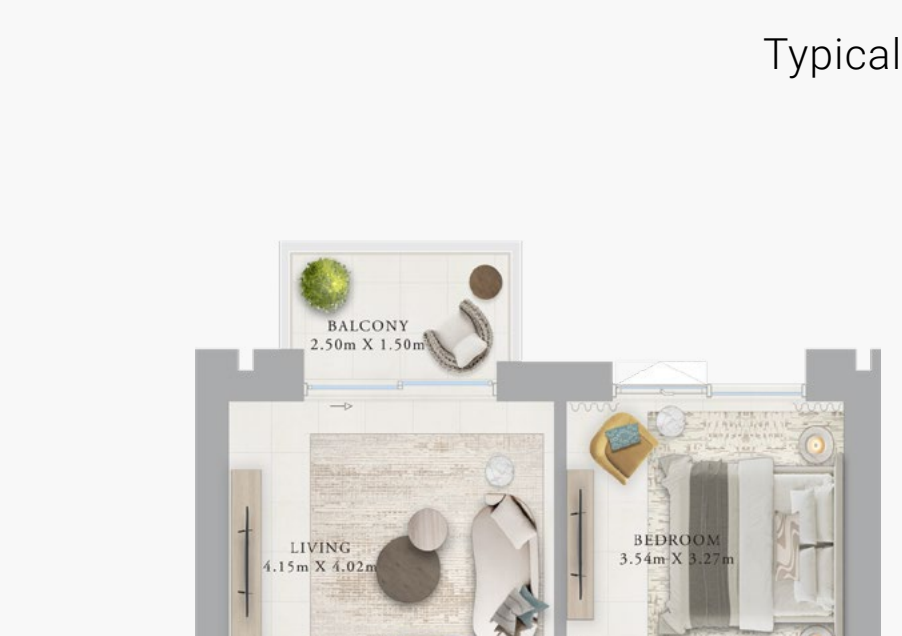

Infinity Pool

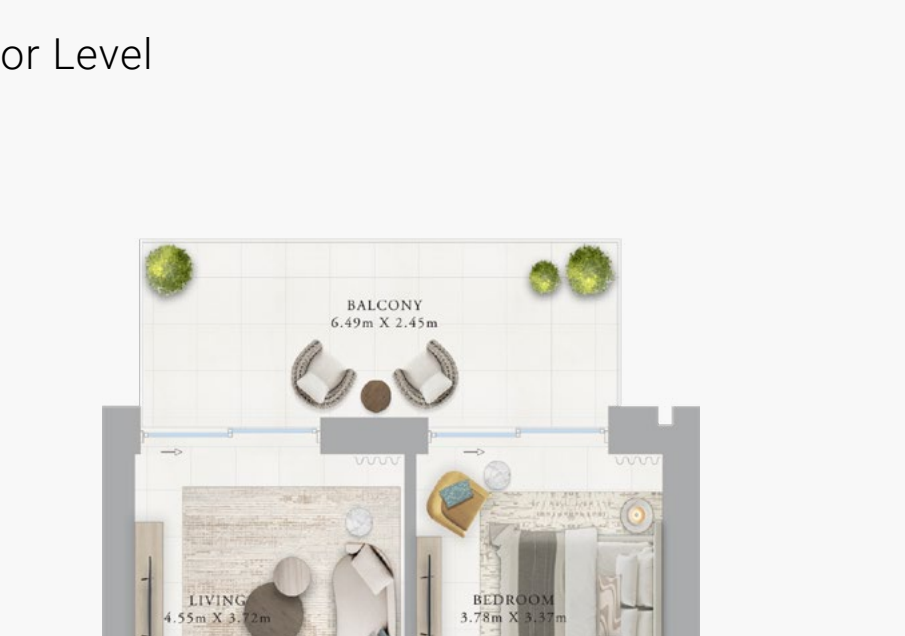

Kids Pool & Splash Zone

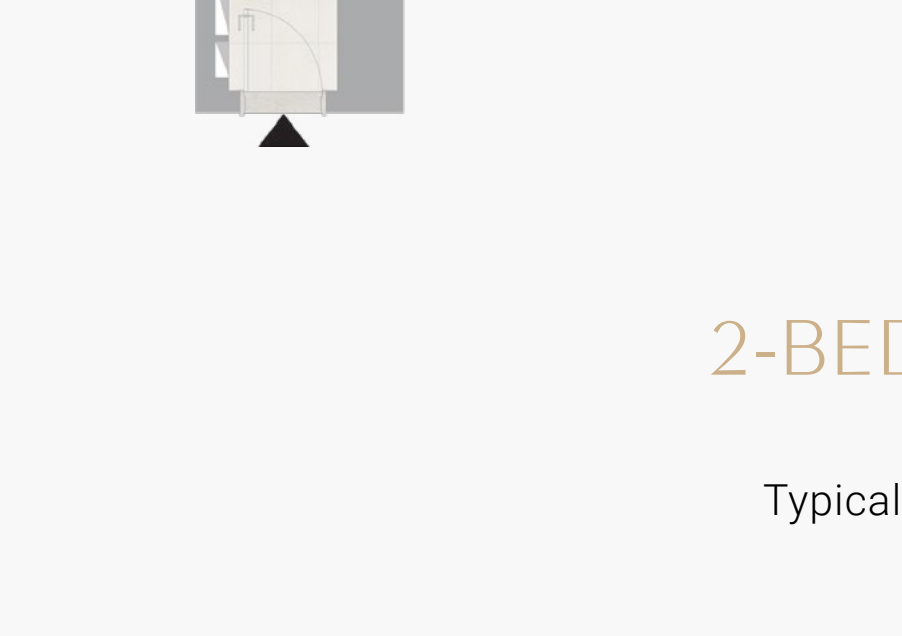

Yoga Deck

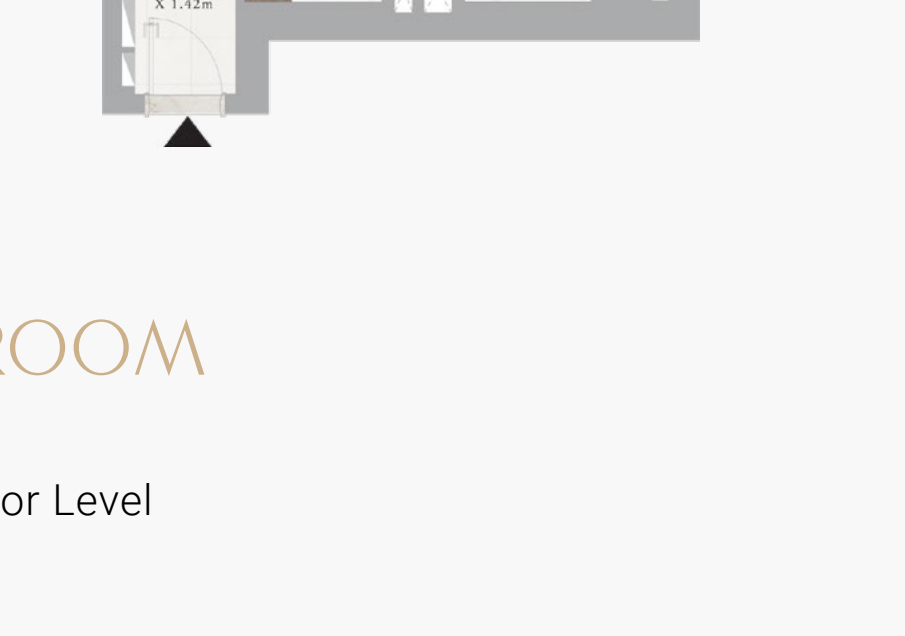

Play Area

1-BEDROOM

Typical Floor Level



2-BEDROOM

Typical Floor Level



3-BEDROOM

Typical Floor Level



EMAAR