

# EVORA

RESIDENCES

A NEW ERA IN AL FURJAN









**EVORA**  
RESIDENCES

## 1 Bedroom Apartments

Size Range from available from  
766.50 sq.ft. - 1,013 sq.ft.

Total Number of Units  
10

APARTMENT PLANS

**1 BHK - TYPE A**

Internal Area 674.15 sq.ft.

External Terrace Area 338.74 sq.ft.

**Total 1012.89 sq.ft.**

TYPICAL FLOOR PLATE (1<sup>ST</sup> FLOOR)

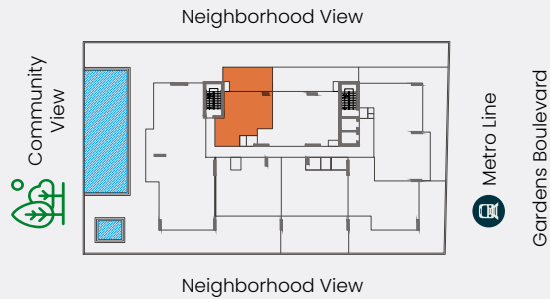

UNIT NUMBERS

104



DISCLAIMERS

1. All dimensions are in imperial and metric, and measured from finish to finish excluding construction tolerances. 2. All materials, dimensions and drawings are approximate only. 3. Information is subject to change without notice, at developer's absolute discretion. 4. Actual area may vary from the stated area. 5. Drawings are not to scale. 6. All images used are for illustrative purposes only and do not represent the actual size, features, specifications, fittings and furnishing. 7. The developer reserves the right to make revisions or alterations, at its absolute discretion, without any liability whatsoever.



APARTMENT PLANS

# 1 BHK - TYPE B

Internal Area 674.15 sq.ft.

External Terrace Area 92.35 sq.ft.

**Total 766.50 sq.ft.**

TYPICAL FLOOR PLATE (2, 3, 6, 7, & 10<sup>TH</sup> floor)

Unit Numbers: 207, 307, 607, 707, 1007

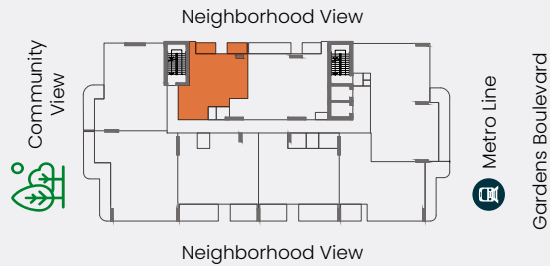

TYPICAL FLOOR PLATE (4, 5, 8, & 9<sup>TH</sup> floor)

Unit Numbers: 407, 507, 807, 907

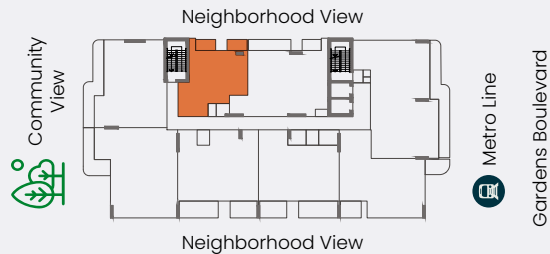

DISCLAIMERS

1. All dimensions are in imperial and metric, and measured from finish to finish excluding construction tolerances. 2. All materials, dimensions and drawings are approximate only. 3. Information is subject to change without notice, at developer's absolute discretion. 4. Actual area may vary from the stated area. 5. Drawings are not to scale. 6. All images used are for illustrative purposes only and do not represent the actual size, features, specifications, fittings and furnishing. 7. The developer reserves the right to make revisions or alterations, at its absolute discretion, without any liability whatsoever.





**EVORA**  
RESIDENCES

## 2 Bedroom Apartments

Size Range from available from  
1,206 sq.ft. - 2,238 sq.ft.

Number of Units  
57



APARTMENT PLANS

**2 BHK - TYPE A**

Internal Area 1,065.21 sq.ft.

External Terrace Area 1,173.38 sq.ft.

**Total 2,238.59 sq.ft.**

TYPICAL FLOOR PLATE (1<sup>ST</sup> FLOOR)

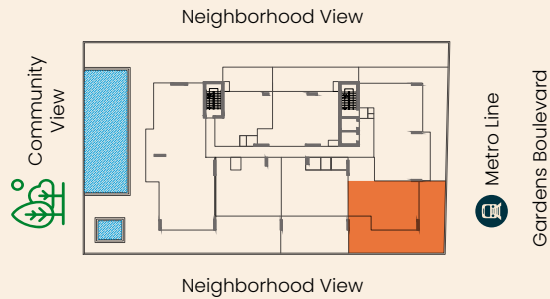

UNIT NUMBERS

102



DISCLAIMERS

1. All dimensions are in imperial and metric, and measured from finish to finish excluding construction tolerances. 2. All materials, dimensions and drawings are approximate only. 3. Information is subject to change without notice, at developer's absolute discretion. 4. Actual area may vary from the stated area. 5. Drawings are not to scale. 6. All images used are for illustrative purposes only and do not represent the actual size, features, specifications, fittings and furnishing. 7. The developer reserves the right to make revisions or alterations, at its absolute discretion, without any liability whatsoever.



## APARTMENT PLANS

### 2 BHK - TYPE B

Internal Area 969.41 sq.ft.

External Terrace Area 757.46 sq.ft.

**Total 1,726.87 sq.ft.**

## TYPICAL FLOOR PLATE (1<sup>ST</sup> FLOOR)

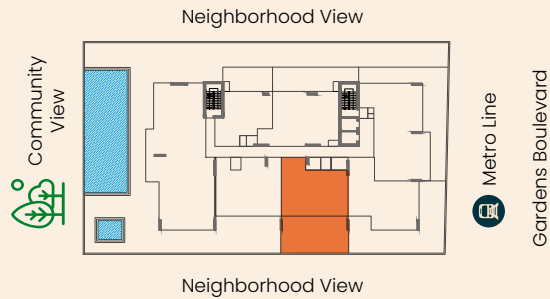

## UNIT NUMBERS

103



## DISCLAIMERS

1. All dimensions are in imperial and metric, and measured from finish to finish excluding construction tolerances. 2. All materials, dimensions and drawings are approximate only. 3. Information is subject to change without notice, at developer's absolute discretion. 4. Actual area may vary from the stated area. 5. Drawings are not to scale. 6. All images used are for illustrative purposes only and do not represent the actual size, features, specifications, fittings and furnishing. 7. The developer reserves the right to make revisions or alterations, at its absolute discretion, without any liability whatsoever.



## APARTMENT PLANS

### 2 BHK - TYPE C

Internal Area 1087.38 sq.ft.

External Terrace Area 551.33 sq.ft.

**Total 1638.71 sq.ft.**

## TYPICAL FLOOR PLATE (1<sup>ST</sup> FLOOR)

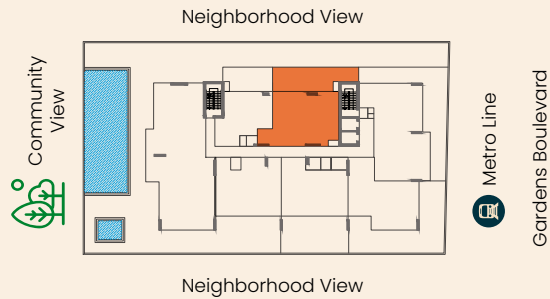

## UNIT NUMBERS

105



## DISCLAIMERS

1. All dimensions are in imperial and metric, and measured from finish to finish excluding construction tolerances. 2. All materials, dimensions and drawings are approximate only. 3. Information is subject to change without notice, at developer's absolute discretion. 4. Actual area may vary from the stated area. 5. Drawings are not to scale. 6. All images used are for illustrative purposes only and do not represent the actual size, features, specifications, fittings and furnishing. 7. The developer reserves the right to make revisions or alterations, at its absolute discretion, without any liability whatsoever.

APARTMENT PLANS

**2 BHK - TYPE D**

Internal Area 1,104.49 sq.ft.

External Terrace Area 218.29 sq.ft.

**Total 1,322.78 sq.ft.**

TYPICAL FLOOR PLATE (4, 5, 8, & 10<sup>TH</sup> FLOOR)

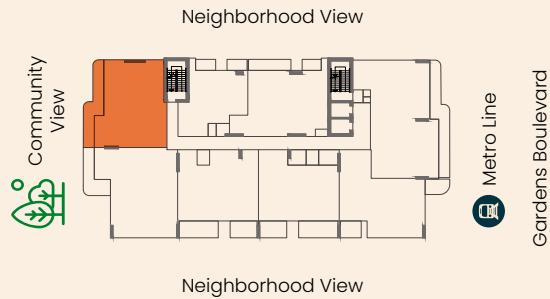

UNIT NUMBERS

406, 506, 806, 906



DISCLAIMERS

1. All dimensions are in imperial and metric, and measured from finish to finish excluding construction tolerances. 2. All materials, dimensions and drawings are approximate only. 3. Information is subject to change without notice, at developer's absolute discretion. 4. Actual area may vary from the stated area. 5. Drawings are not to scale. 6. All images used are for illustrative purposes only and do not represent the actual size, features, specifications, fittings and furnishing. 7. The developer reserves the right to make revisions or alterations, at its absolute discretion, without any liability whatsoever.



APARTMENT PLANS

## 2 BHK - TYPE E

Internal Area 1,065.20 sq.ft.

External Terrace Area 148.76 sq.ft.

**Total 1213.96 sq.ft.**

TYPICAL FLOOR PLATE (4, 5, 8 & 9<sup>TH</sup> FLOOR)

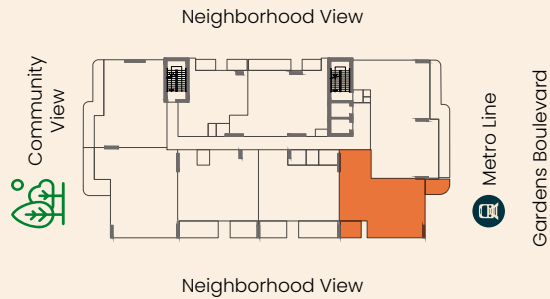

UNIT NUMBERS

402, 502, 802, 902



DISCLAIMERS

1. All dimensions are in imperial and metric, and measured from finish to finish excluding construction tolerances. 2. All materials, dimensions and drawings are approximate only. 3. Information is subject to change without notice, at developer's absolute discretion. 4. Actual area may vary from the stated area. 5. Drawings are not to scale. 6. All images used are for illustrative purposes only and do not represent the actual size, features, specifications, fittings and furnishing. 7. The developer reserves the right to make revisions or alterations, at its absolute discretion, without any liability whatsoever.

APARTMENT PLANS

## 2 BHK - TYPE F

Internal Area 969.41 sq.ft.

External Terrace Area 237.13 sq.ft.

**Total 1,206.54 sq.ft.**

TYPICAL FLOOR PLATE (2, 3, 6, 7 & 10<sup>TH</sup> FLOOR)

UNIT NUMBERS : 203, 303, 603, 703, 1003

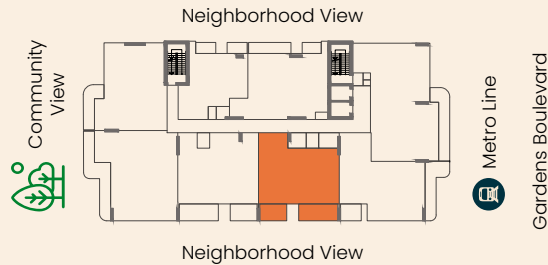

TYPICAL FLOOR PLATE (4, 5, 8 & 9<sup>TH</sup> FLOOR)

UNIT NUMBERS : 403, 503, 803, 903

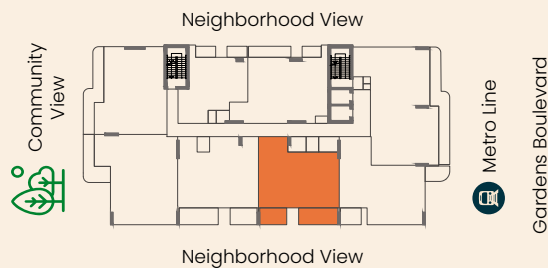

DISCLAIMERS

1. All dimensions are in imperial and metric, and measured from finish to finish excluding construction tolerances. 2. All materials, dimensions and drawings are approximate only. 3. Information is subject to change without notice, at developer's absolute discretion. 4. Actual area may vary from the stated area. 5. Drawings are not to scale. 6. All images used are for illustrative purposes only and do not represent the actual size, features, specifications, fittings and furnishing. 7. The developer reserves the right to make revisions or alterations, at its absolute discretion, without any liability whatsoever.



APARTMENT PLANS

## 2 BHK - TYPE G

Internal Area 1066.28 sq.ft.

External Terrace Area 235.84 sq.ft.

**Total 1302.12 sq.ft.**

TYPICAL FLOOR PLATE (2, 3, 6, 7 & 10<sup>TH</sup> FLOOR)

UNIT NUMBERS : 204, 304, 604, 704, 1004

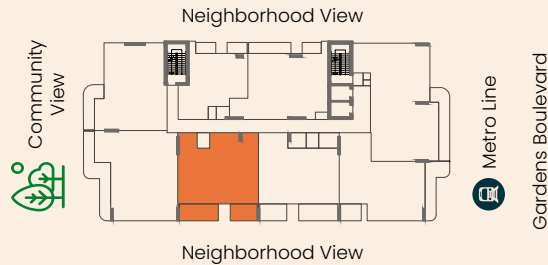

TYPICAL FLOOR PLATE (4, 5, 8 & 9<sup>TH</sup> FLOOR)

UNIT NUMBERS : 404, 504, 804, 904

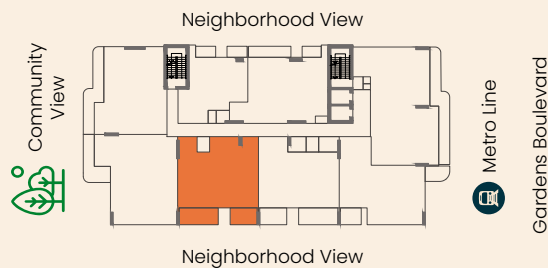

DISCLAIMERS

1. All dimensions are in imperial and metric, and measured from finish to finish excluding construction tolerances. 2. All materials, dimensions and drawings are approximate only. 3. Information is subject to change without notice, at developer's absolute discretion. 4. Actual area may vary from the stated area. 5. Drawings are not to scale. 6. All images used are for illustrative purposes only and do not represent the actual size, features, specifications, fittings and furnishing. 7. The developer reserves the right to make revisions or alterations, at its absolute discretion, without any liability whatsoever.

APARTMENT PLANS

**2 BHK - TYPE H**

Internal Area 1,262.17 sq.ft.

External Terrace Area 250.05 sq.ft.

**Total 1,512.22 sq.ft.**



TYPICAL FLOOR PLATE (2, 3, 6, 7 & 10<sup>TH</sup> FLOOR)

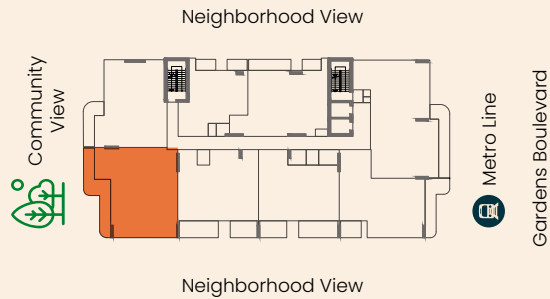

UNIT NUMBERS

205, 305, 605, 705, 1005



DISCLAIMERS

1. All dimensions are in imperial and metric, and measured from finish to finish excluding construction tolerances. 2. All materials, dimensions and drawings are approximate only. 3. Information is subject to change without notice, at developer's absolute discretion. 4. Actual area may vary from the stated area. 5. Drawings are not to scale. 6. All images used are for illustrative purposes only and do not represent the actual size, features, specifications, fittings and furnishing. 7. The developer reserves the right to make revisions or alterations, at its absolute discretion, without any liability whatsoever.



APARTMENT PLANS

**2 BHK - TYPE I**

Internal Area 1262.19 sq.ft.

External Terrace Area 157.37 sq.ft.

**Total 1419.56sq.ft.**

TYPICAL FLOOR PLATE (4, 5, 8 & 9<sup>TH</sup> FLOOR)

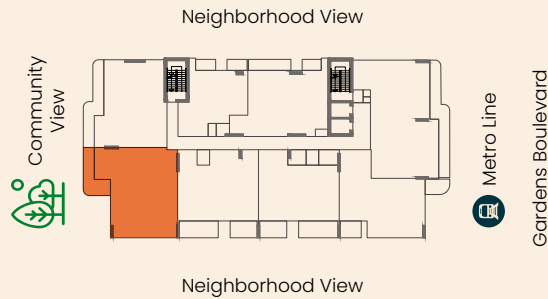

UNIT NUMBERS

405, 505, 805, 905



DISCLAIMERS

1. All dimensions are in imperial and metric, and measured from finish to finish excluding construction tolerances. 2. All materials, dimensions and drawings are approximate only. 3. Information is subject to change without notice, at developer's absolute discretion. 4. Actual area may vary from the stated area. 5. Drawings are not to scale. 6. All images used are for illustrative purposes only and do not represent the actual size, features, specifications, fittings and furnishing. 7. The developer reserves the right to make revisions or alterations, at its absolute discretion, without any liability whatsoever.

APARTMENT PLANS

**2 BHK - TYPE J**

Internal Area 1104.49 sq.ft.

External Terrace Area 125.08 sq.ft.

**Total 1229.57 sq.ft.**



TYPICAL FLOOR PLATE (2, 3, 6, 7 & 10<sup>TH</sup> FLOOR)

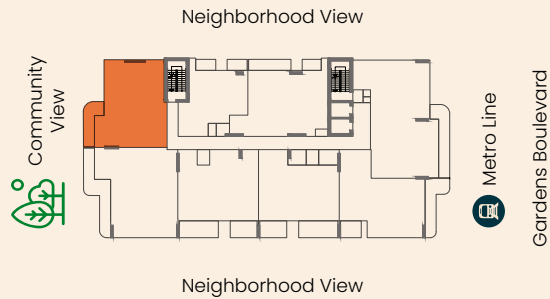

UNIT NUMBERS

206, 306, 606, 706, 1006



DISCLAIMERS

1. All dimensions are in imperial and metric, and measured from finish to finish excluding construction tolerances. 2. All materials, dimensions and drawings are approximate only. 3. Information is subject to change without notice, at developer's absolute discretion. 4. Actual area may vary from the stated area. 5. Drawings are not to scale. 6. All images used are for illustrative purposes only and do not represent the actual size, features, specifications, fittings and furnishing. 7. The developer reserves the right to make revisions or alterations, at its absolute discretion, without any liability whatsoever.



APARTMENT PLANS

## 2 BHK - TYPE K

Internal Area 1,065.21 sq.ft.

External Terrace Area 247.57 sq.ft.

**Total 1312.78 sq.ft.**

TYPICAL FLOOR PLATE (2, 3, 6, 7 & 10<sup>TH</sup> FLOOR)

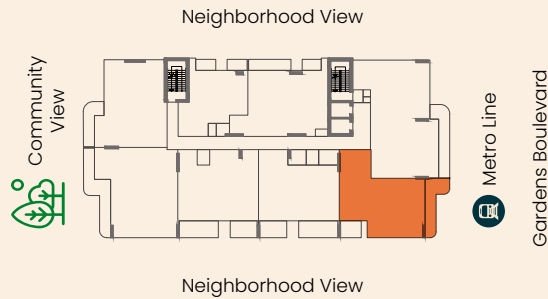

UNIT NUMBERS

202, 302, 602, 702, 1002



DISCLAIMERS

1. All dimensions are in imperial and metric, and measured from finish to finish excluding construction tolerances. 2. All materials, dimensions and drawings are approximate only. 3. Information is subject to change without notice, at developer's absolute discretion. 4. Actual area may vary from the stated area. 5. Drawings are not to scale. 6. All images used are for illustrative purposes only and do not represent the actual size, features, specifications, fittings and furnishing. 7. The developer reserves the right to make revisions or alterations, at its absolute discretion, without any liability whatsoever.

APARTMENT PLANS

## 2 BHK - TYPE L

Internal Area 1087.38 sq.ft.

External Terrace Area 141.87 sq.ft.

**Total 1229.25 sq.ft.**

TYPICAL FLOOR PLATE (2, 3, 6, 7 & 10<sup>TH</sup> FLOOR)

UNIT NUMBERS : 208, 308, 608, 708, 1008

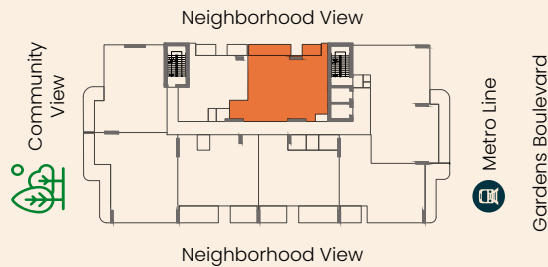

TYPICAL FLOOR PLATE (4, 5, 8 & 9<sup>TH</sup> FLOOR)

UNIT NUMBERS : 408, 508, 808, 908

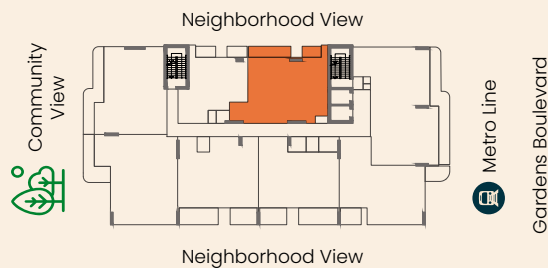

DISCLAIMERS

1. All dimensions are in imperial and metric, and measured from finish to finish excluding construction tolerances. 2. All materials, dimensions and drawings are approximate only. 3. Information is subject to change without notice, at developer's absolute discretion. 4. Actual area may vary from the stated area. 5. Drawings are not to scale. 6. All images used are for illustrative purposes only and do not represent the actual size, features, specifications, fittings and furnishing. 7. The developer reserves the right to make revisions or alterations, at its absolute discretion, without any liability whatsoever.





**EVORA**  
RESIDENCES

## 3 Bedroom Apartments

Size Range from available from  
1,750 sq.ft. - 2,598.62 sq.ft.

Number of Units  
10

## APARTMENT PLANS

### 3 BHK - TYPE A

Internal Area 1,563.69 sq.ft.

External Terrace Area 1,034.96 sq.ft.

**Total 2,598.65 sq.ft.**

## TYPICAL FLOOR PLATE (1<sup>ST</sup> FLOOR)

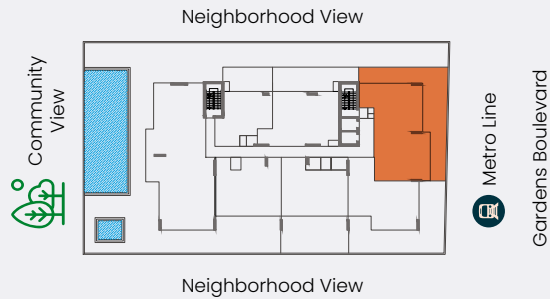

## UNIT NUMBERS

101



## DISCLAIMERS

1. All dimensions are in imperial and metric, and measured from finish to finish excluding construction tolerances. 2. All materials, dimensions and drawings are approximate only. 3. Information is subject to change without notice, at developer's absolute discretion. 4. Actual area may vary from the stated area. 5. Drawings are not to scale. 6. All images used are for illustrative purposes only and do not represent the actual size, features, specifications, fittings and furnishing. 7. The developer reserves the right to make revisions or alterations, at its absolute discretion, without any liability whatsoever.



## APARTMENT PLANS

### 3 BHK - TYPE B

Internal Area 1,563.68 sq.ft.

External Terrace Area 186.22 sq.ft.

**Total 1749.90 sq.ft.**

## TYPICAL FLOOR PLATE (2, 3, 6, 7 & 10<sup>TH</sup> FLOOR)

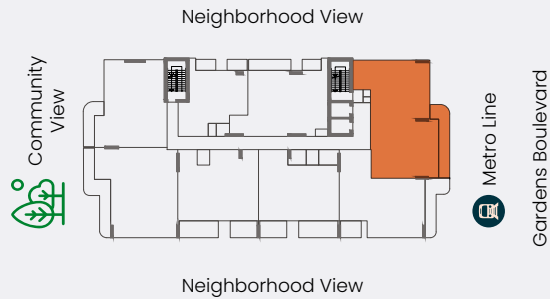

## UNIT NUMBERS

201, 301, 601, 701, 1001



## DISCLAIMERS

1. All dimensions are in imperial and metric, and measured from finish to finish excluding construction tolerances. 2. All materials, dimensions and drawings are approximate only. 3. Information is subject to change without notice, at developer's absolute discretion. 4. Actual area may vary from the stated area. 5. Drawings are not to scale. 6. All images used are for illustrative purposes only and do not represent the actual size, features, specifications, fittings and furnishing. 7. The developer reserves the right to make revisions or alterations, at its absolute discretion, without any liability whatsoever.

APARTMENT PLANS

# 3 BHK - TYPE C

Internal Area 1,563.69 sq.ft.

External Terrace Area 286.64 sq.ft.

**Total 1,850.33 sq.ft.**

TYPICAL FLOOR PLATE (4, 5, 8 & 9<sup>TH</sup> FLOOR)

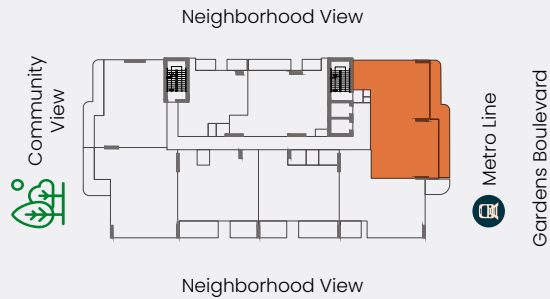

UNIT NUMBERS

401, 501, 801, 901



DISCLAIMERS

1. All dimensions are in imperial and metric, and measured from finish to finish excluding construction tolerances. 2. All materials, dimensions and drawings are approximate only. 3. Information is subject to change without notice, at developer's absolute discretion. 4. Actual area may vary from the stated area. 5. Drawings are not to scale. 6. All images used are for illustrative purposes only and do not represent the actual size, features, specifications, fittings and furnishing. 7. The developer reserves the right to make revisions or alterations, at its absolute discretion, without any liability whatsoever.













**800** ANAX  
2629

27th Floor, Aspin Commercial Tower, Sheikh Zayed Road, Dubai - U.A.E.  
sales@anaxdevelopments.com | [www.anaxdevelopments.com](http://www.anaxdevelopments.com)